

## **NOTICE OF CONFIRMATION OF PUBLIC PATH ORDER**

### **HIGHWAYS ACT 1980**

#### **MID SUFFOLK DISTRICT COUNCIL (ALLEGED FOOTPATH NO 10 BROME) PUBLIC PATH DIVERSION ORDER 2020**

On 18 March 2020 Mid Suffolk District Council confirmed the above order made under Section 119 of the Highways Act 1980.

The effect of the order as confirmed is to divert the whole of alleged Footpath No 10 at the Renvale Technology Park in Brome commencing at Ordnance Survey grid reference (OSGR) TM13537647 from the B1077 road and proceeding in a north westerly direction for approximately 92 metres to the A140 road at OSGR TM13457651 to a new line running from OSGR TM1354676414 from the B1077 road and proceeding in a westerly direction for approximately 2 metres to OSGR TM1354476413 then in a north north westerly direction between a security fence and a hedge for approximately 77 metres to OSGR TM13527648 then continuing adjacent to the security fence in a north westerly direction for approximately 6 metres to OSGR TM13517649 then in a northerly direction to an access road and crossing the access road for approximately 13 metres to OSGR TM13517650 then in a north easterly direction along a wide grass verge with a hedge and a security fence to the north west for approximately 10 metres to OSGR TM13527651 then in a north north westerly direction along the grass verge with a hedge and a security fence to the west for approximately 62 metres to join the publicly maintainable highway at OSGR TM13517657 as shown on the order map.

A copy of the order as confirmed and the order map may be obtained or may be seen free of charge at the address below between the hours of 08:00 - 16:30. They may also be viewed at Eye Library, 6 Cross Street, Eye, IP23 7AB between the hours of 09:00-13:00 Tues, 09:00-13:00 and 14:00-18:00 Weds, 14:00-17:00 Thurs, 09:00-13:00 and 14:00-17:00 Fri, 09:00-13:00 Sat and 10:00-15:00 Sun or at

[www.suffolkpublicrightsofway.org.uk/home/public-notice-about-legal-orders](http://www.suffolkpublicrightsofway.org.uk/home/public-notice-about-legal-orders)

The order comes into force on 6 June 2020 but if a person aggrieved by the order wants to question its validity, or that of any provision contained in it, on the ground that it is not within the powers of the Highways Act 1980, as amended, or on the ground that any requirement of the Act, as amended, or of any regulation made under the Act has not been complied with in relation to the order he or she may, under paragraph 2 of Schedule 2 to the Act as applied by paragraph 5 of Schedule 6 to the Act, within six weeks from 25 March 2020, make an application to the High Court.

Dated: 25 March 2020

C Clements  
Assistant Director Environment and Commercial Partnerships  
Babergh and Mid Suffolk District Council  
Endeavour House  
8 Russell Road  
Ipswich  
IP1 2BX

## **PUBLIC PATH DIVERSION ORDER**

### **HIGHWAYS ACT 1980**

#### **MID SUFFOLK DISTRICT COUNCIL (ALLEGED FOOTPATH NO 10 BROME) PUBLIC PATH DIVERSION ORDER 2020**

This order is made by Mid Suffolk District Council ("the authority") under section 119 of the Highways Act 1980 ("the 1980 Act") because it appears to the authority that in the interests of the owners of the land crossed by the alleged footpath described in paragraph 1 of this order it is expedient that the line of the path should be diverted.

Renvale Limited has agreed to defray any compensation which becomes payable in consequence of the coming into force of the order, and any expenses which are incurred in bringing the new site of the path into a fit condition for use by the public.

Suffolk County Council has been consulted as required by section 120(2) of the 1980 Act and Suffolk County Council has consented to the making of the order.

#### **BY THIS ORDER:**

1. The alleged public right of way over the land situate at Brome and shown by a bold continuous line on the map contained in this order and described in Part 1 of the Schedule to this order shall be stopped up with effect from the date on which Suffolk County Council certifies that the work to bring the public footpath described in Part 2 of the Schedule to this order into a fit condition for use by the public has been carried out. Certification shall not take place prior to the creation of the new route as described in Paragraph 2 of this order.
2. There shall at the end of 79 days from the date of confirmation of this order be a public footpath over the land situate at Brome described in Part 2 of the Schedule and shown by a bold broken line on the map contained in this order.

GIVEN under the Common Seal of Mid Suffolk District Council this 23<sup>rd</sup> day of  
January 2020

THE COMMON SEAL of )  
MID SUFFOLK DISTRICT )  
COUNCIL was hereunto )  
affixed in the presence of: )

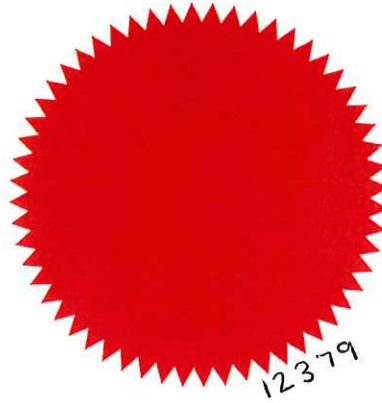

  
Authorised Officer

Mid Suffolk District Council hereby confirms the foregoing Order given under the  
Common Seal of Mid Suffolk District Council this 18<sup>th</sup> day of March 2020

THE COMMON SEAL of  
MID SUFFOLK DISTRICT  
COUNCIL was hereunto  
affixed in the presence of:

  
Authorised Officer



## SCHEDULE

### PART 1

#### DESCRIPTION OF SITE OF EXISTING PATH

**Alleged Footpath No 10 Brome** – The whole of alleged Footpath No 10 at Brome commencing at Ordnance Survey grid reference TM13537647 at point A from the B1077 road and proceeding in a north westerly direction for approximately 92 metres to the A140 road at Ordnance Survey grid reference TM13457651 at point B; this being the route shown between points A – B on the order map.

### PART 2

#### DESCRIPTION OF SITE OF NEW PATH

**Footpath No 10 Brome** – Commencing at Ordnance Survey grid reference TM1354676414 at point C from the B1077 road and proceeding in a westerly direction for approximately 2 metres to Ordnance Survey grid reference TM1354476413 at point D then in a north north westerly direction between a security fence and a hedge for approximately 77 metres to Ordnance Survey grid reference TM13527648 at point E then continuing adjacent to the security fence in a north westerly direction for approximately 6 metres to Ordnance Survey grid reference TM13517649 at point F then in a northerly direction to an access road and crossing the access road for approximately 13 metres to Ordnance Survey grid reference TM13517650 at point G then in a north easterly direction along a wide grass verge with a hedge and a security fence to the north west for approximately 10 metres to Ordnance Survey grid reference TM13527651 at point H then in a north north westerly direction along the grass verge with a hedge and a security fence to the west for approximately 62 metres to join the publicly maintainable highway at Ordnance Survey grid reference TM13517657 at point J; this being the route shown between points C – D – E – F – G – H – J on the order map.

Width:

1.5 metres between points C – D

Varying between 1.3 metres and 1.4 metres between points D – E – F

1.5 metres between points F – G – H – J with the centre line of the footpath being 3.5 metres from the security fence between points G – H – J



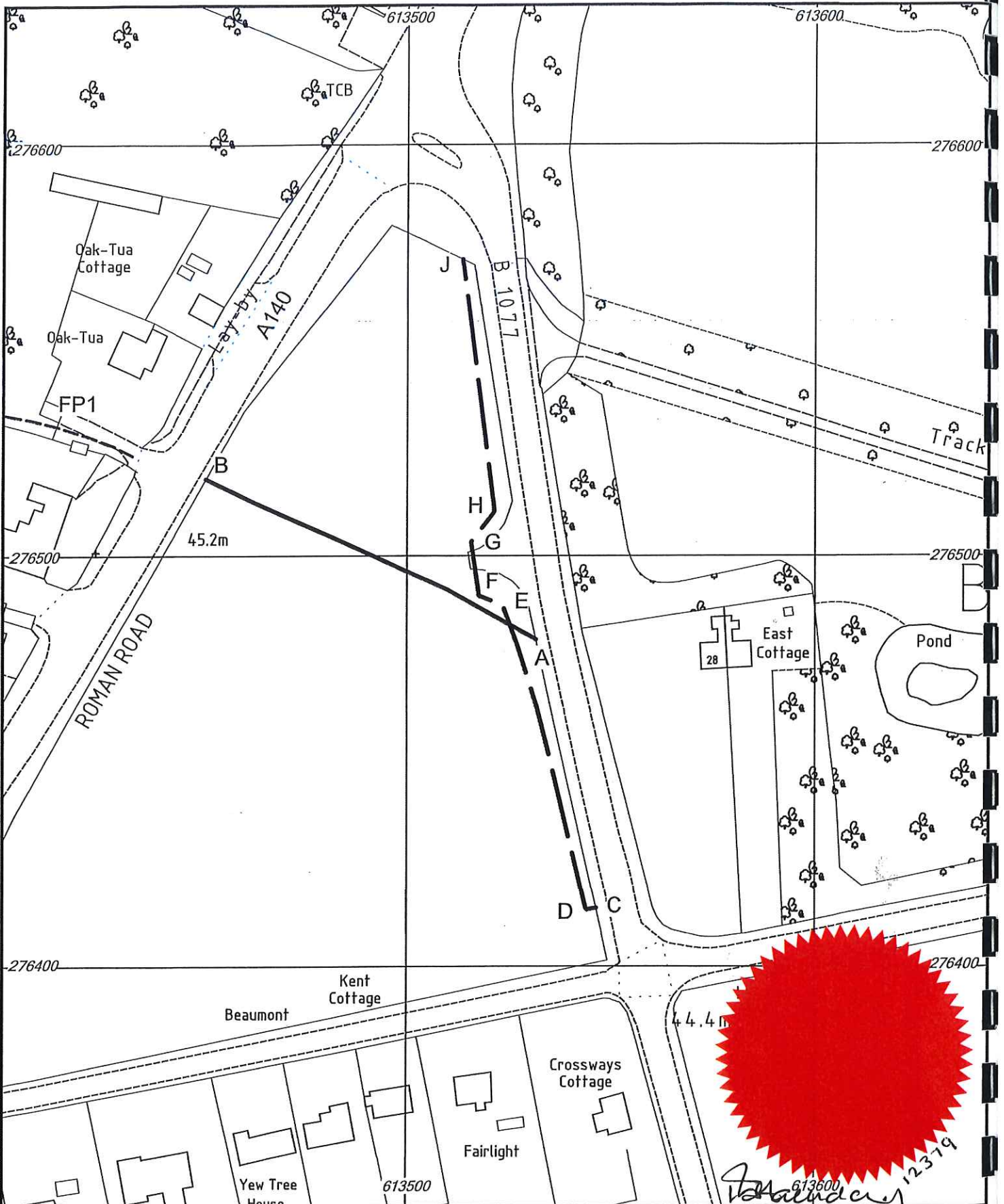

**MAP REFERRED TO IN THE MID SUFFOLK DISTRICT COUNCIL (ALLEGED FOOTPATH NO 10 BROME) PUBLIC PATH DIVERSION ORDER 2020 - HIGHWAYS ACT 1980 SECTION 119**



- Alleged footpath to be diverted (A - B)
- Proposed footpath (C - D - E - F - G - H - J)
- Unaffected footpath

Scale 1:1250

Ordnance Survey MasterMap

Crown Copyright. All rights reserved.  
Suffolk County Council Licence No. 100023395 2020

