

File Path R:\Transport & Infrastructure\Traffic Mgmt - COUNTYWIDE\LHB\Lowestoft\Beccles Road Toucan crossing\DWG\working drawings\Toucan crossing - Beccles Road - Lowestoft_recover Rev E.dwg

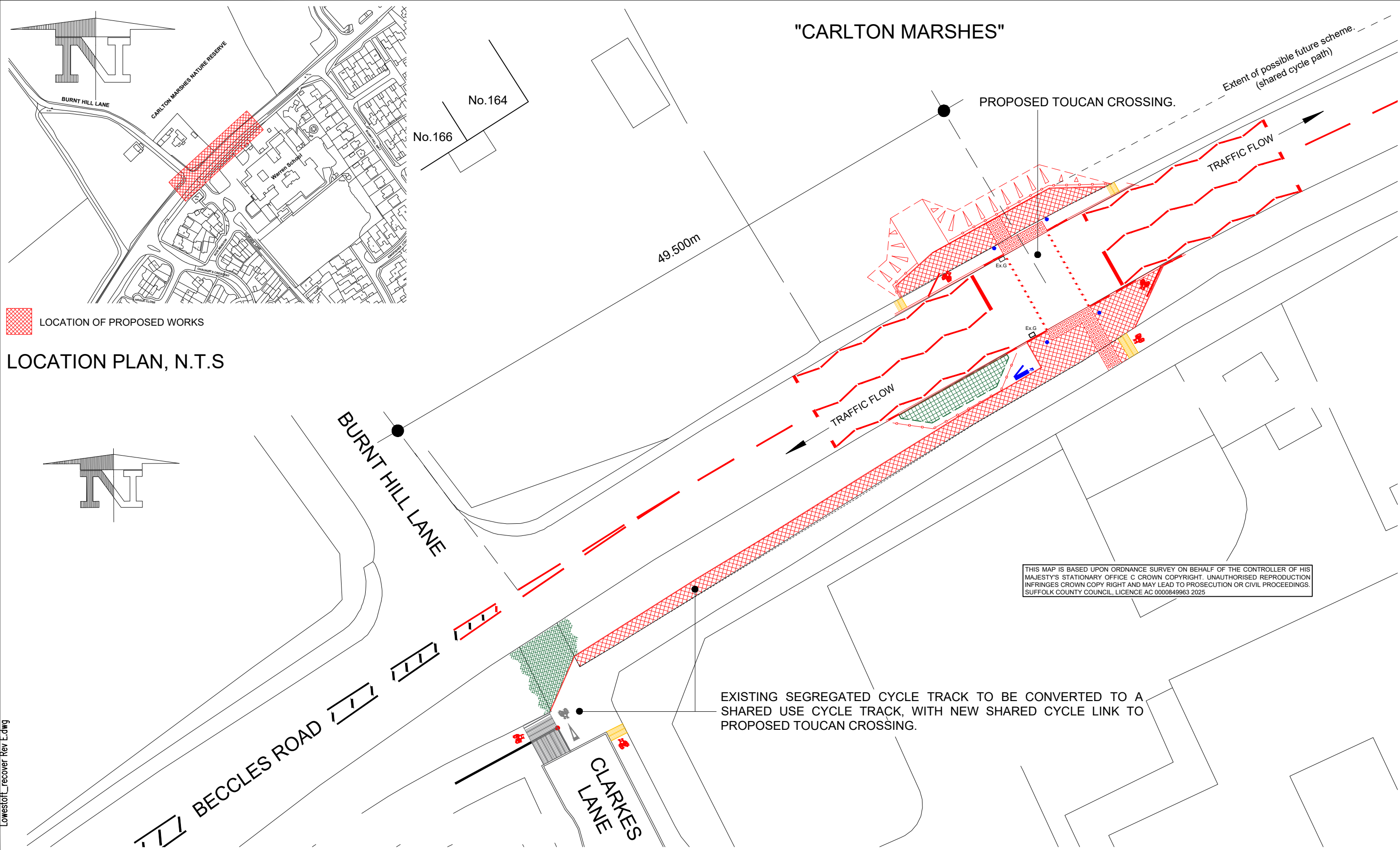

 LOCATION OF PROPOSED WORKS

LOCATION PLAN, N.T.S

THIS MAP IS BASED UPON ORDNANCE SURVEY ON BEHALF OF THE CONTROLLER OF HIS MAJESTY'S STATIONARY OFFICE. CROWN COPYRIGHT. UNAUTHORISED REPRODUCTION INFRINGES CROWN COPY RIGHT AND MAY LEAD TO PROSECUTION OR CIVIL PROCEEDINGS. SUFFOLK COUNTY COUNCIL, LICENCE AC 0000849963 2025

EXISTING SEGREGATED CYCLE TRACK TO BE CONVERTED TO A SHARED USE CYCLE TRACK, WITH NEW SHARED CYCLE LINK TO PROPOSED TOUCAN CROSSING.

Plot date 02/09/2025



Working together to build a positive legacy for Suffolk

Phoenix House, 3 Goddard Road, Ipswich, Suffolk IP1 5NP.
Highways enquires: 0345 606 6171 www.suffolk.gov.uk/highways

NOTE(S):

REVISION(S)
DESCRIPTION
REV.
DATE
INTL.

PROJECT TITLE	BECCLES ROAD, LOWESTOFT PROPOSED TOUCAN CROSSING
DRAWING TITLE	PUBLIC NOTICE PLAN

ORIGINATOR	Cllr JS	CHECKER	PW	DESIGNER	JCCr	REVIEWER	
SCALE(S)	ORIGINAL SIZE AS AS SHOWN	DATE	SEPT 2025				
DRAWING NUMBER	253788 / PNP / 014				REVISION	-	