

File Path R:\Transport & Infrastructure\Traffic Mgmt\ - COUNTYWIDE\LHB\Hadleigh\Proposed waiting restrictions\Drawing\Proposed waiting restrictions - Duke Street.dwg

Plot date



LOCATION OF WORKS
LOCATION PLAN N.T.S

KEY:-

- PROPOSED RESTRICTION "NO WAITING AT ANY TIME, ROAD MARKING TO DIA 1018.1, 50mm WIDE, COLOUR "PRIMROSE".
- PROPOSED EXTEND OF UNLIMITED ON-STREET PARKING, NO MARKINGS TO BE INSTALLED - ILLUSTRATION PURPOSES ONLY.
- EXISTING WAITING RESTRICTION,
- EXISTING WAITING RESTRICTION TO BE REVOKED.
- EXISTING ADVISORY ROAD MARKING.

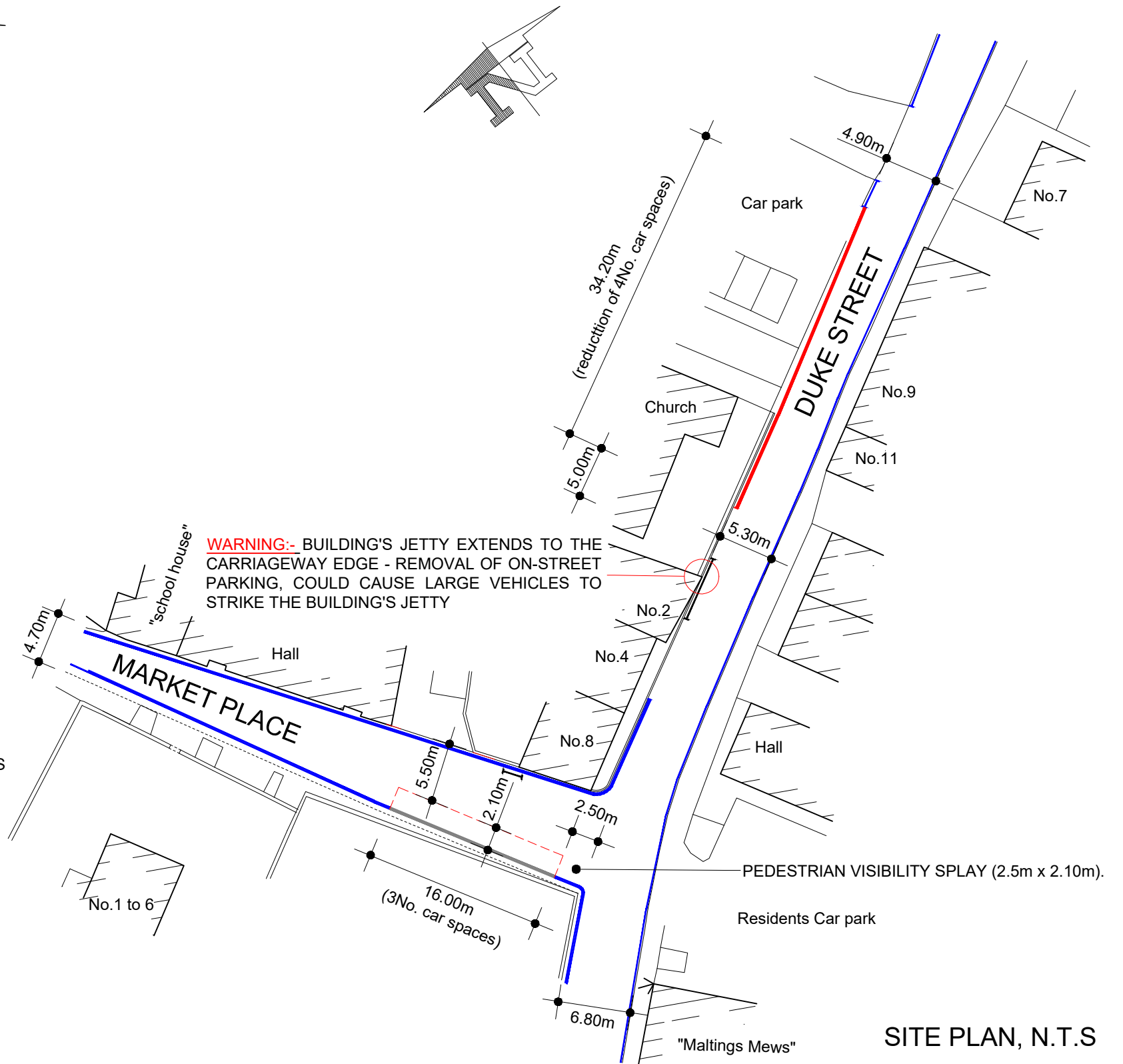

SITE PLAN, N.T.S

Suffolk Highways
your roads, our business

John Clements & Peter Ingram
Phoenix House, 3 Goddard Road, Ipswich, Suffolk IP1 5NP.
Highways enquires: 0345 606 6171 www.suffolk.gov.uk/highways

NOTE(S)
1) ANY DISCREPANCIES TO BE REPORTED TO CLIENTS DESIGN ENGINEER AND CONTRACTORS SUPERVISOR.

REVISION(S)			
DESCRIPTION	REV.	DATE	INTL.

PROJECT TITLE		ORIGINATOR	CHECKER	DESIGNER	REVIEWER
DUKE STREET, HADLEIGH PROPOSED WAITING RESTRICTIONS		Cllr MF	PW	JCCr	
		SCALE(S) ORIGINAL SIZE A3 AS SHOWN		DATE APR 22	
DRAWING TITLE		DRAWING NUMBER			REVISION
GENERAL ARRANGEMENT		245993 / GA / 001			