

IES Breckland Expansion: Public Consultation

Suffolk County Council is consulting on a proposal to increase the existing accommodation at IES Breckland. The new accommodation will provide a two-storey stand-alone block to provide purpose-built teaching and activity spaces. The new accommodation will make space available to increase the capacity of the school.

Further external works are also proposed to increase car and cycle parking provision at the school.

Plans of the proposed developments may be viewed at www.suffolk.gov.uk/consultations <<http://www.suffolk.gov.uk/consultations>>.

This is a non-statutory pre-application planning consultation aimed at gathering the views of parents, staff and local residents prior to the submission of the planning application. It does not affect the right to comment on the proposals during the statutory planning consultation process.

Completed comment forms must be returned to the Schools Infrastructure Team, Suffolk County Council, Endeavour House, 8 Russell Road, Ipswich IP1 2BX by 29th April.

You can also comment online at www.suffolk.gov.uk/consultations <<http://www.suffolk.gov.uk/consultations>> or by email to schools@suffolk.gov.uk <<mailto:schools@suffolk.gov.uk>> until and including 27th April.

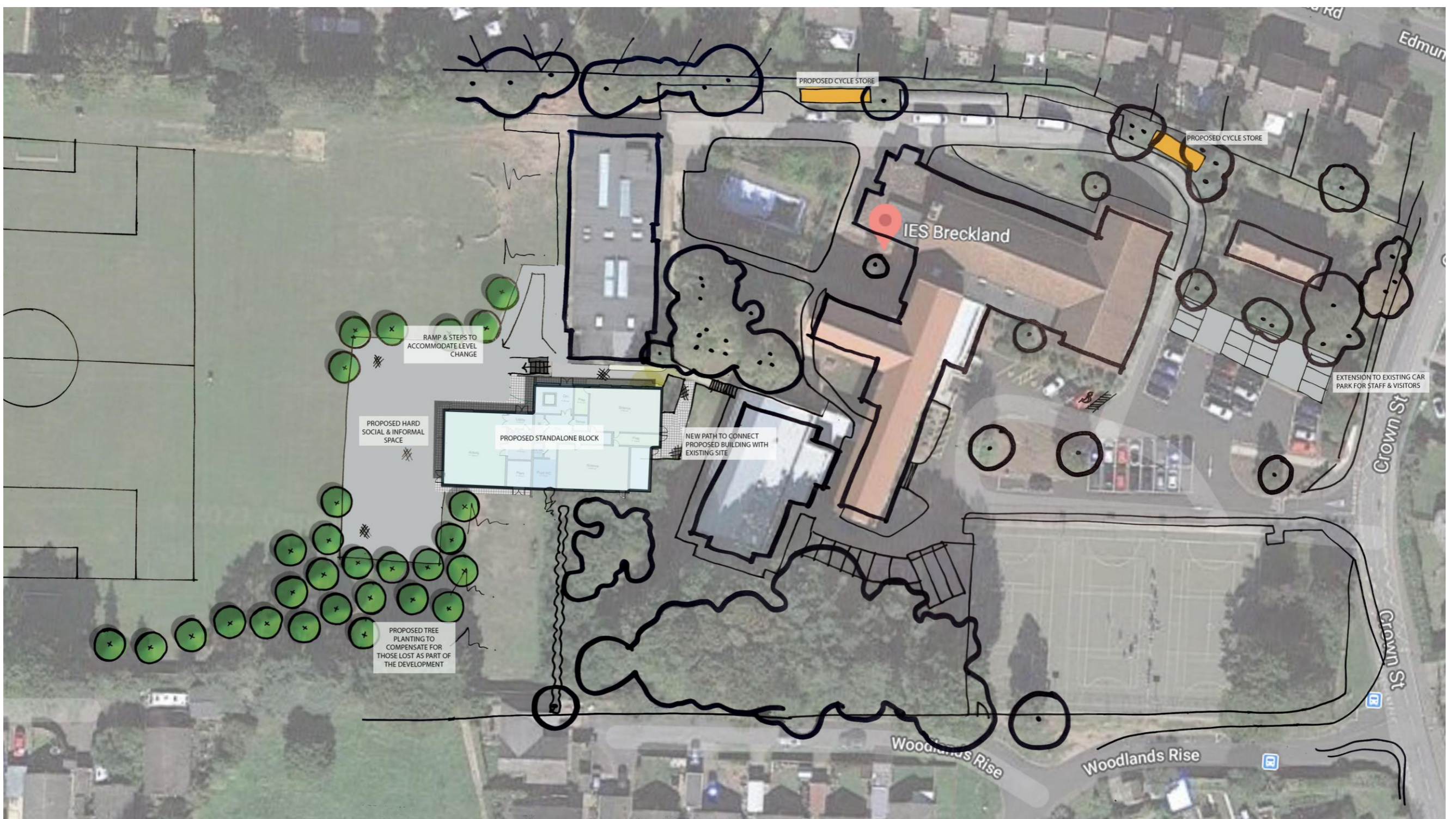
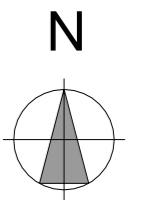

Concept Site Masterplan