

KEY

New Hard Paved Area

Existing Paved Area

New Cycle Shelters

New Asphalt

New Buffer Planting/Hedges

Existing Planting

Existing Trees

Grass

Pitches

Existing Building

New Building - Phase 1

New Building - Phase 2

1.8m High Fence

1.2m Chestnut Pailing

Site Boundary



Retain existing trees



Existing car park modified to accommodate accessible car parking spaces and bin storage



Indicative location for phase 1 car park

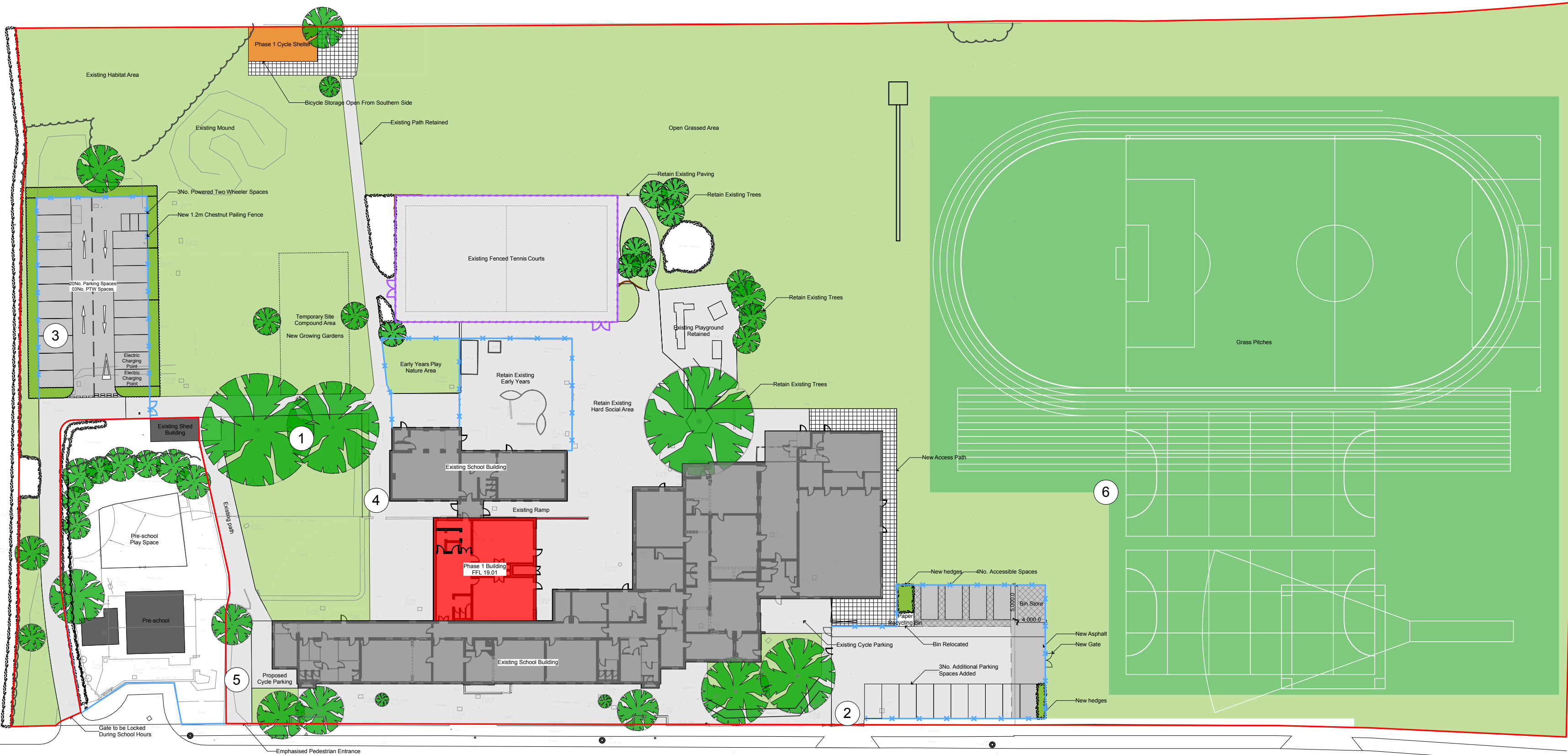

Location for new phase 1 and 2 building



Formalised entry from Duckamere



Existing sports pitches retained

Disclaimer.
This drawing is to be read in conjunction with all related drawings. Do not scale from this drawing. All dimensions must be checked and verified on site before commencing any work or producing shop drawings.
This drawing is copyright and remains the property of Concertus Design and Property Consultants. When reproducing this drawing for any purpose, please ensure that Concertus is attributed clearly by either using the company logo, or as follows 'Image produced by Concertus Design & Property Consultants Limited'.

REV	DATE	BY	DESCRIPTION	CHKD
P1	07/03/19	RA	For pre-planning consultation	SS



2 Friars Bridge Road - Ipswich - Suffolk - IP1 1RR

Project

Ipswich Bramford CEVCP School – Expansion 210-315

Bramford Ipswich

Drawing Title

Proposed Phase 1

Project Number

17-0502

Scales

1:500

At A2 Size

Drawn

RA

Chkd

SS

Date

Mar 19

Lead Designer

Scott Spiers

email: scott.spiers@concertus.co.uk

Tel: 01473 316600

PLANNING