

20. Any other: ..... .....			
Do you know who the owner of the land is?	I believe it belonged to the council but it has been sold.		
Was permission ever sought by you for activities on the land or to go onto the land? If so from whom and when?	No, I thought it was a public park.		
Have you ever been prevented from using the land? If yes, when and why?	No		
Has any attempt ever been made by notice or fencing or by any other means to prevent or discourage the use being made of the land by the local people? If yes, please give examples.	No		
If you have any additional information, please add it below.			

I have carried out the activities referred to in this questionnaire for...2.....years without anyone trying to stop me and I believe the activity should be treated by the law as having a lawful origin.

*I understand that the evidence form I have completed in relation to this application may become public knowledge and I authorise the applicant to disclose this form to anyone reasonably requiring access to this application.*

*I also understand that this evidence may be presented to a non-statutory inquiry and I authorise the applicant to use this form for that purpose.*

Signed.....Melendra S. Sanders.....Date.....11/02/2020.....

Map A

# Proposed Town Green

Approx scale only

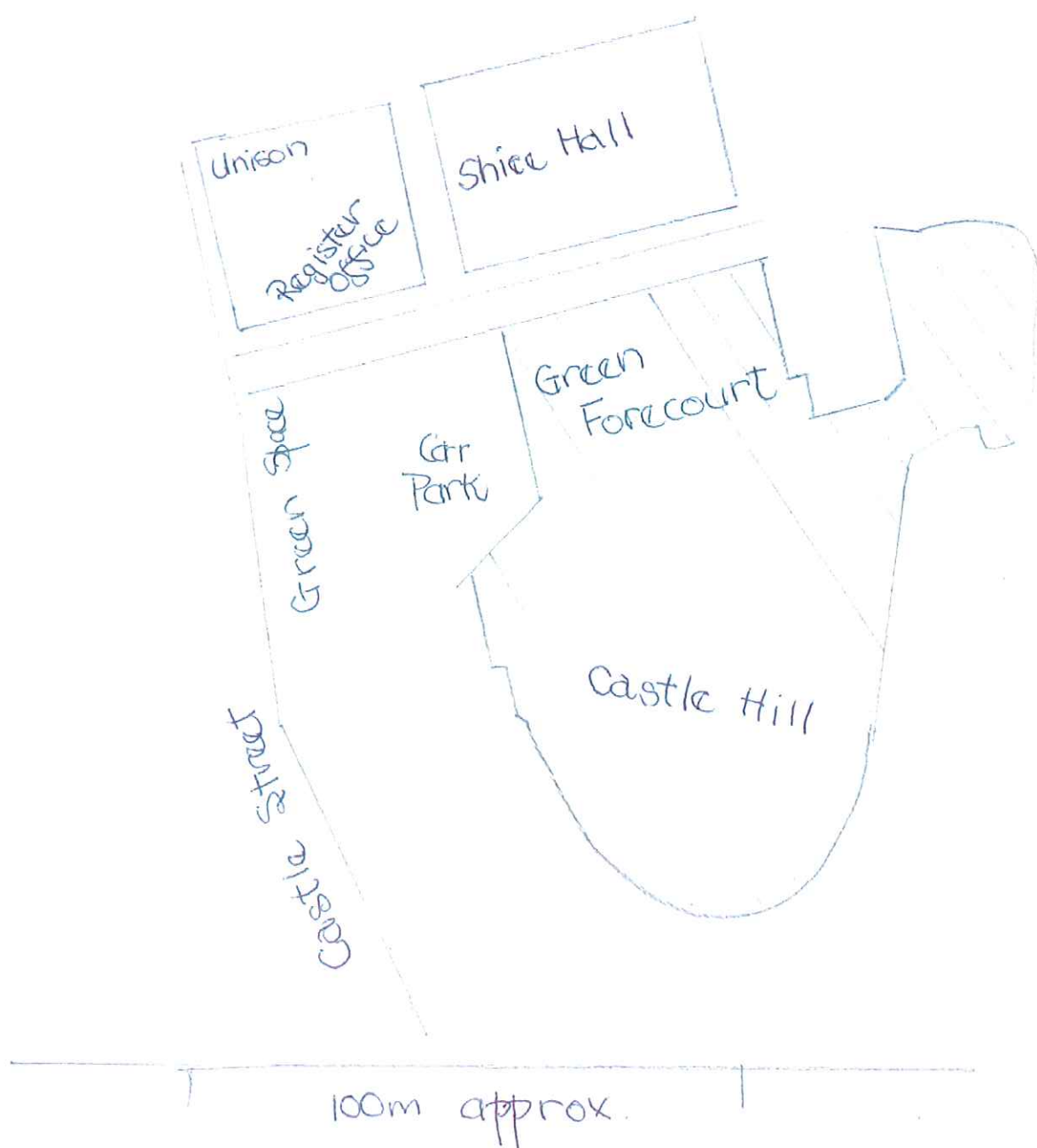



**EVIDENCE QUESTIONNAIRE IN SUPPORT OF REGISTRATION LAND AT SHIRE HALL CAMBRIDGE AS  
ON ATTACHED MAP A AS A TOWN GREEN**

GDPR disclaimer:

The data you provide will be used in connection with the application for the Shire Hall monument site and grassed forecourt to be classed as a town green. By participating in this questionnaire, you consent to our holding information about you for the purposes set out above.

Where we are processing personal data on your behalf we will take all reasonable measures to prevent the unauthorised or unlawful processing of your data and/or the accidental loss or destruction of or damage to your personal data.

We will hold your data for a reasonable period and we agree to delete your personal data from our systems when it is no longer required in accordance with the purposes for which it was supplied. If you wish to have your information deleted before then, please send us a request in writing.

You have the right at any time to request a copy of the information held about you and the details of the purposes for which it is held and processed. You also have the right to request that your personal data is erased from our records. We agree to comply with any request for information made by you within a reasonable time period and in any event within 30 days of receipt of a written request for information.

The Cambridge Labour Party will keep your personal information private and securely held. By submitting information you are agreeing to the use of data in accordance with GDPR.

NAME	Mary Wheater		
ADDRESS	93 Windsor Road		
POSTCODE	CB4 3JL	TELEPHONE NO	

<b>Your address when you used the land (see attached map A)</b>	Recently – 93 Windsor Road, Cambridgeshire In the 1960's – Newnham College Cambridge; 36 Norwich St., Cambridge
<b>Please confirm that you agree with the boundaries of the locality (or neighbourhood within a locality) on map A. Tick yes or no.</b>	Yes <input checked="" type="checkbox"/> No <input type="checkbox"/>
<b>For how many years have you known the land?</b>	From...about 1964..... to .....2020.....
<b>Between which years have you used the land?</b>	From...1964 to 1970, and from 2011 onwards..... to.....

<b>How do you/did you gain access to the land?</b> E.g do you simply walk onto the land?	Walked onto it	
<b>Do you know of any activities that happen every year or more regularly on the land?</b> Please give details.	No	
<b>Do you know of any community activities that have taken place on the land?</b> Please give details.	No	
<b>Tick the activities that you have engaged in on the land (Column A) or seen taking place on the land (Column B). Add any further activities at the end of the list.</b>		
	<b>A (your use)</b>	<b>B (others' use)</b>
1. Children playing		
2. Rounders		
3. Drawing and Painting	✓	
4. Dog Walking		
5. Team Games		
6. Football		
7. Cricket		
8. Bird watching		
9. Picnicking		✓
10. Kite flying		
11. People walking	✓	✓
12. Watching fireworks		✓
13. Carol singing		
14. Faith celebrations and worship		
15. Community celebrations		
16. Fetes		
17. Political marches		
18. Taking photographs for celebrations for such as weddings		
19. Citizenship ceremonies		
20. Any other: .....		



.....			
Do you know who the owner of the land is?	no		
Was permission ever sought by you for activities on the land or to go onto the land? If so from whom and when?	no		
Have you ever been prevented from using the land? If yes, when and why?	no		
Has any attempt ever been made by notice or fencing or by any other means to prevent or discourage the use being made of the land by the local people? If yes, please give examples.	Not that I know of		
If you have any additional information, please add it below.			

I have carried out the activities referred to in this questionnaire **intermittently for over 50 years** without anyone trying to stop me and I believe the activity should be treated by the law as having a lawful origin.

*I understand that the evidence form I have completed in relation to this application may become public knowledge and I authorise the applicant to disclose this form to anyone reasonably requiring access to this application.*

*I also understand that this evidence may be presented to a non-statutory inquiry and I authorise the applicant to use this form for that purpose.*

Signed.....Mary Wheater.....Date.....10 Feb 2020.....



Map A

# Proposed Town Green

Approx scale only

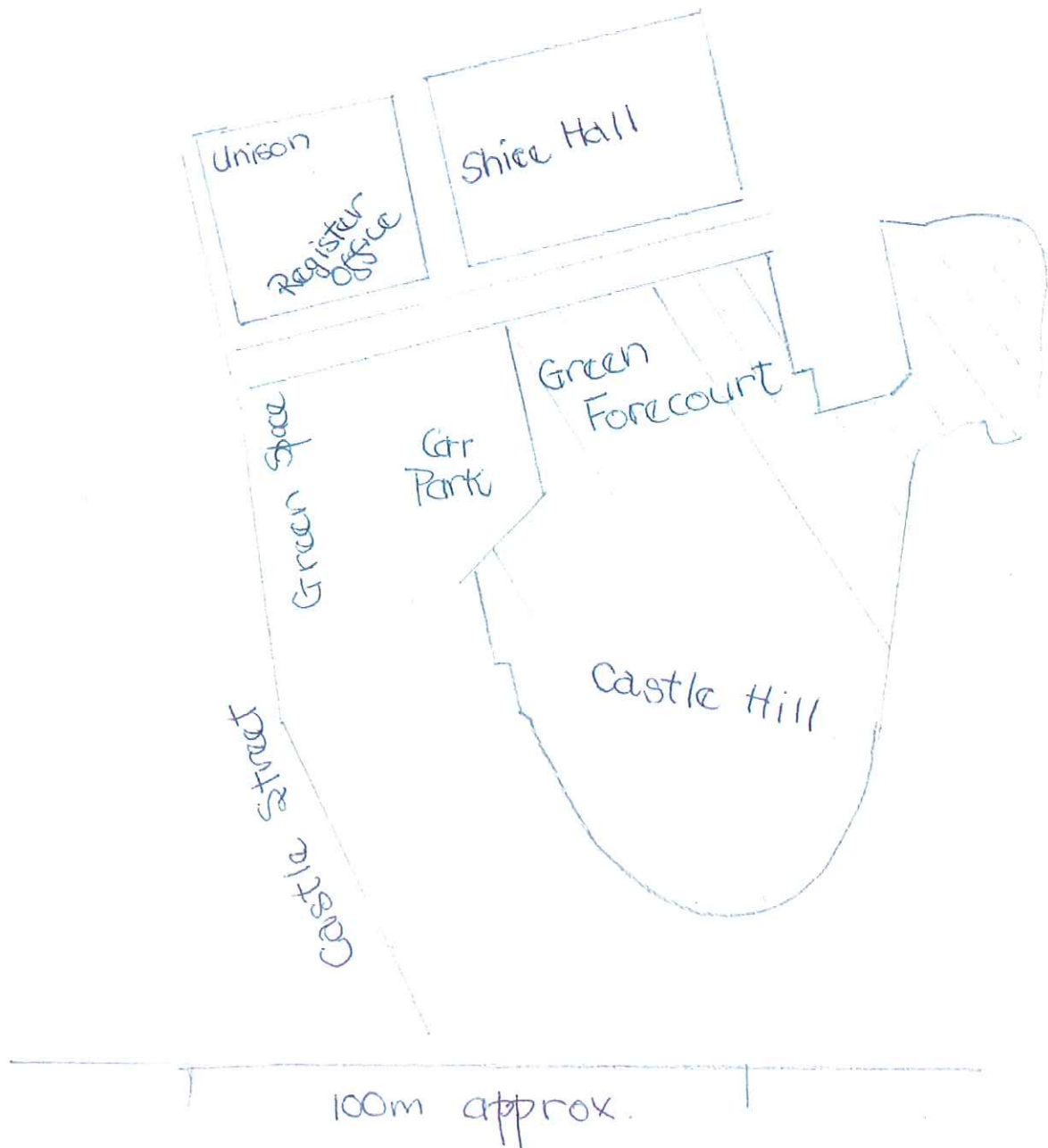



**EVIDENCE QUESTIONNAIRE IN SUPPORT OF REGISTRATION LAND AT SHIRE HALL CAMBRIDGE AS  
ON ATTACHED MAP A AS A TOWN GREEN**

GDPR disclaimer:

The data you provide will be used in connection with the application for the Shire Hall monument site and grassed forecourt to be classed as a town green. By participating in this questionnaire, you consent to our holding information about you for the purposes set out above.

Where we are processing personal data on your behalf we will take all reasonable measures to prevent the unauthorised or unlawful processing of your data and/or the accidental loss or destruction of or damage to your personal data.

We will hold your data for a reasonable period and we agree to delete your personal data from our systems when it is no longer required in accordance with the purposes for which it was supplied. If you wish to have your information deleted before then, please send us a request in writing.

You have the right at any time to request a copy of the information held about you and the details of the purposes for which it is held and processed. You also have the right to request that your personal data is erased from our records. We agree to comply with any request for information made by you within a reasonable time period and in any event within 30 days of receipt of a written request for information.

The Cambridge Labour Party will keep your personal information private and securely held. By submitting information you are agreeing to the use of data in accordance with GDPR.

<b>NAME</b>	Ann Mullinger		
<b>ADDRESS</b>	59 Windsor Road		
<b>POSTCODE CB4 3JL</b>			<b>TELEPHONE NO</b> 01223 358514

<b>Your address when you used the land (see attached map A)</b>	59 Windsor Road Cambridge CB4 3JL
<b>Please confirm that you agree with the boundaries of the locality (or neighbourhood within a locality) on map A. Tick yes or no.</b>	YES
<b>For how many years have you known the land?</b>	From.....1958..... to .....2020.....
<b>Between which years have you used the land?</b>	From 1965 to 2020

<b>How do you/did you gain access to the land?</b> E.g do you simply walk onto the land?	WALK	
<b>Do you know of any activities that happen every year or more regularly on the land?</b> Please give details.	Social activities associated with weddings.	
<b>Do you know of any community activities that have taken place on the land?</b> Please give details.	Guided tours of this historically important area of Cambridge. Community activities for local children and families and for adults, in special weeks focussed on this special area.	
<b>Tick the activities that you have engaged in on the land (Column A) or seen taking place on the land (Column B). Add any further activities at the end of the list.</b>		
	<b>A (your use)</b>	<b>B (others' use)</b>
1. Children playing		yes
2. Rounders		
3. Drawing and Painting		
4. Dog Walking		yes
5. Team Games		
6. Football		
7. Cricket		
8. Bird watching	yes	yes
9. Picnicking		yes
10. Kite flying		
11. People walking	yes	yes
12. Watching fireworks	yes	yes
13. Carol singing		
14. Faith celebrations and worship		
15. Community celebrations	yes	yes
16. Fetes		
17. Political marches		
18. Taking photographs for celebrations for such as weddings	yes	yes
19. Citizenship ceremonies		
Any other: .....	yes	yes
20. Opportunity to relax out of doors, in open space		

<p>21. Enjoying views of the city myself and with my friends.</p> <p>22. Taking visitors to the mound to see and enjoy the layout of Cambridge City and appreciate the overall layout of the city and its buildings</p> <p>23. Enhance appreciation of Cambridge History</p> <p>.....</p> <p>.....</p>		
<p><b>Do you know who the owner of the land is?</b></p>	<p><b>yes</b></p>	
<p><b>Was permission ever sought by you for activities on the land or to go onto the land? If so from whom and when?</b></p>	<p><b>No it has always been freely available for me to have access for what I wanted to do.</b></p>	
<p><b>Have you ever been prevented from using the land? If yes, when and why?</b></p>	<p><b>no</b></p>	
<p><b>Has any attempt ever been made by notice or fencing or by any other means to prevent or discourage the use being made of the land by the local people? If yes, please give examples.</b></p>	<p><b>I know of none</b></p>	
<p><b>If you have any additional information, please add it below.</b></p> <p><b>Free access to the whole of this site is essential at all times, throughout the year. It is essential for residents of Cambridge City, Cambridgeshire, neighbouring counties, the rest of the UK and overseas people of all ages.</b></p> <p><b>Important for:</b></p> <ul style="list-style-type: none"> <li><b>* historical interest</b></li> <li><b>* open outdoor space</b></li> <li><b>* viewpoint</b></li> </ul>		

--

I have carried out the activities referred to in this questionnaire form over 55.....years without anyone trying to stop me and I believe the activity should be treated by the law as having a lawful origin.
--

<i>I understand that the evidence form I have completed in relation to this application may become public knowledge and I authorise the applicant to disclose this form to anyone reasonably requiring access to this application.</i>
--

<i>I also understand that this evidence may be presented to a non-statutory inquiry and I authorise the applicant to use this form for that purpose.</i>
--

Signed.....Ann Mullinger.....

Date.....9 February 2020.....



Map A

Proposed Town Green  
Approx. scale only

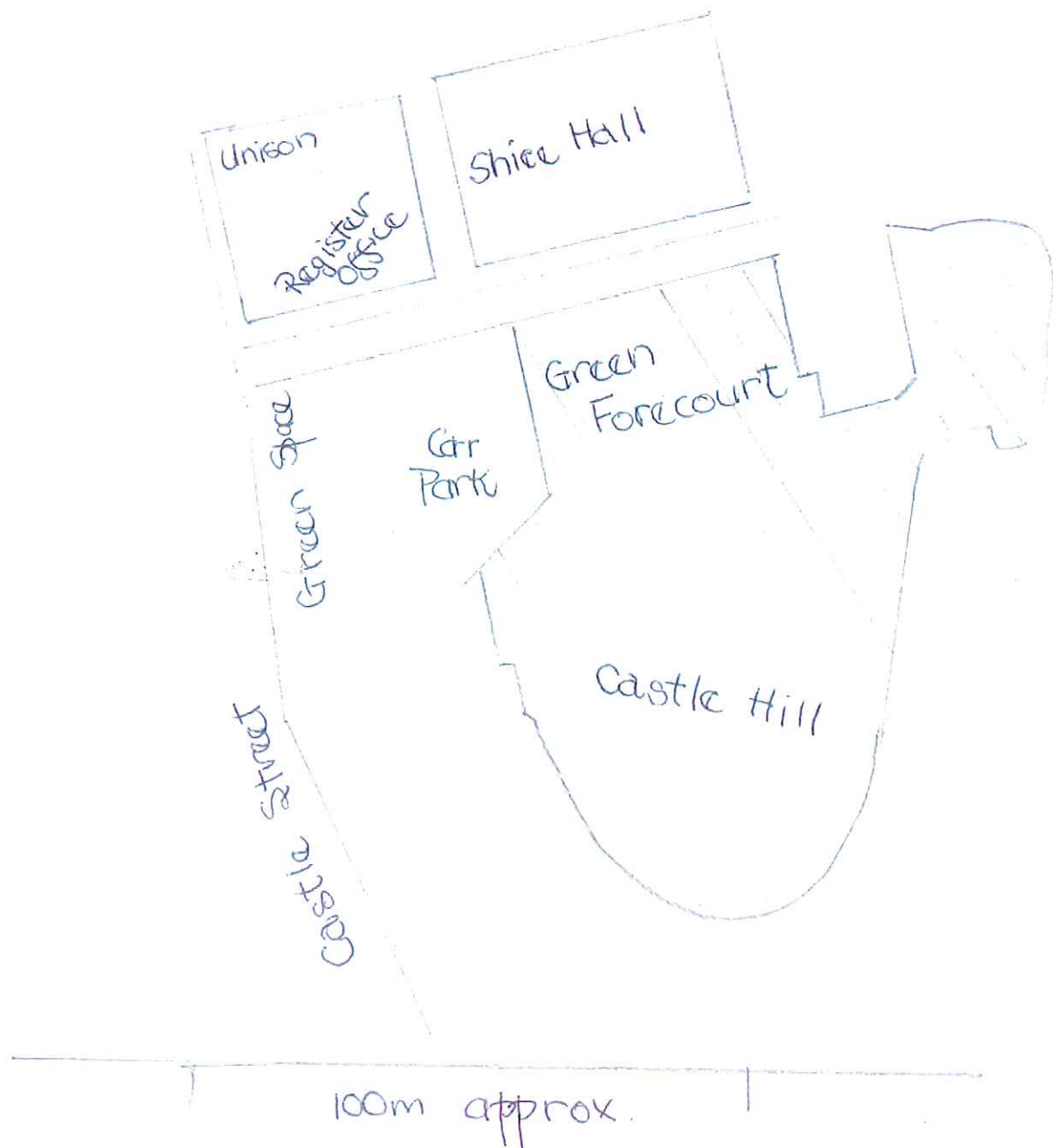

**EVIDENCE QUESTIONNAIRE IN SUPPORT OF REGISTRATION LAND AT SHIRE HALL CAMBRIDGE AS  
ON ATTACHED MAP A AS A TOWN GREEN**

**GDPR disclaimer:**

The data you provide will be used in connection with the application for the Shire Hall monument site and grassed forecourt to be classed as a town green. By participating in this questionnaire, you consent to our holding information about you for the purposes set out above.

Where we are processing personal data on your behalf we will take all reasonable measures to prevent the unauthorised or unlawful processing of your data and/or the accidental loss or destruction of or damage to your personal data.

We will hold your data for a reasonable period and we agree to delete your personal data from our systems when it is no longer required in accordance with the purposes for which it was supplied. If you wish to have your information deleted before then, please send us a request in writing.

You have the right at any time to request a copy of the information held about you and the details of the purposes for which it is held and processed. You also have the right to request that your personal data is erased from our records. We agree to comply with any request for information made by you within a reasonable time period and in any event within 30 days of receipt of a written request for information.

The Cambridge Labour Party will keep your personal information private and securely held. By submitting information you are agreeing to the use of data in accordance with GDPR.

<b>NAME</b>	Catherine Belsey
<b>ADDRESS</b>	3 Sherlock Close, Cambridge
<b>POSTCODE CB30HW</b>	<b>TELEPHONE NO</b> 01223352915

<b>Your address when you used the land (see attached map A)</b>	3 Sherlock Close, Cambridge CB30HW
<b>Please confirm that you agree with the boundaries of the locality (or neighbourhood within a locality) on map A. Tick yes or no.</b>	Yes <input type="checkbox"/> No
<b>For how many years have you known the land?</b>	From...1999..... to ...2020.....
<b>Between which years have you used the land?</b>	From.....1999..... to.....2020.....

<b>How do you/did you gain access to the land?</b> E.g do you simply walk onto the land?	I have always simply walked onto it.	
<b>Do you know of any activities that happen every year or more regularly on the land?</b> Please give details.	Watching the City fireworks display	
<b>Do you know of any community activities that have taken place on the land?</b> Please give details.		
<b>Tick the activities that you have engaged in on the land (Column A) or seen taking place on the land (Column B). Add any further activities at the end of the list.</b>		
	<b>A (your use)</b>	<b>B (others' use)</b>
1. Children playing		<input type="checkbox"/>
2. Rounders		
3. Drawing and Painting		
4. Dog Walking		<input type="checkbox"/>
5. Team Games		
6. Football		
7. Cricket		
8. Bird watching		
9. Picnicking		<input type="checkbox"/>
10. Kite flying		
11. People walking	<input type="checkbox"/>	<input type="checkbox"/>
12. Watching fireworks	<input type="checkbox"/>	<input type="checkbox"/>
13. Carol singing		
14. Faith celebrations and worship		
15. Community celebrations		
16. Fetes		
17. Political marches	<input type="checkbox"/>	<input type="checkbox"/>
18. Taking photographs for celebrations for such as weddings		<input type="checkbox"/>
19. Citizenship ceremonies		

20. Any other: I take visitors there to see the site of Cambridge's history (from the Roman encampment on)..... .... .....			
Do you know who the owner of the land is?	Cambridgeshire County Council		
Was permission ever sought by you for activities on the land or to go onto the land? If so from whom and when?	No		
Have you ever been prevented from using the land? If yes, when and why?	No		
Has any attempt ever been made by notice or fencing or by any other means to prevent or discourage the use being made of the land by the local people? If yes, please give examples.	No		
If you have any additional information, please add it below.			
<p>This is my nearest local green space (at least, the nearest that isn't also a children's play area). I use it to think, breathe, escape and walk – and assemble for marches, like the climate change march on 20 September 2019, which gathered on the green forecourt.</p> <p>I moved to my present address in October 1999 and have come to regard the historic site as a precious amenity I use as a matter of course.</p>			

I have carried out the activities referred to in this questionnaire for...21.....years without anyone trying to stop me and I believe the activity should be treated by the law as having a lawful origin.

*I understand that the evidence form I have completed in relation to this application may become public knowledge and I authorise the applicant to disclose this form to anyone reasonably requiring access to this application.*

*I also understand that this evidence may be presented to a non-statutory inquiry and I authorise the applicant to use this form for that purpose.*

Signed.....Catherine Belsey.....Date...3 February  
2020.....



Map A

Proposed Town Green  
Approx scale only

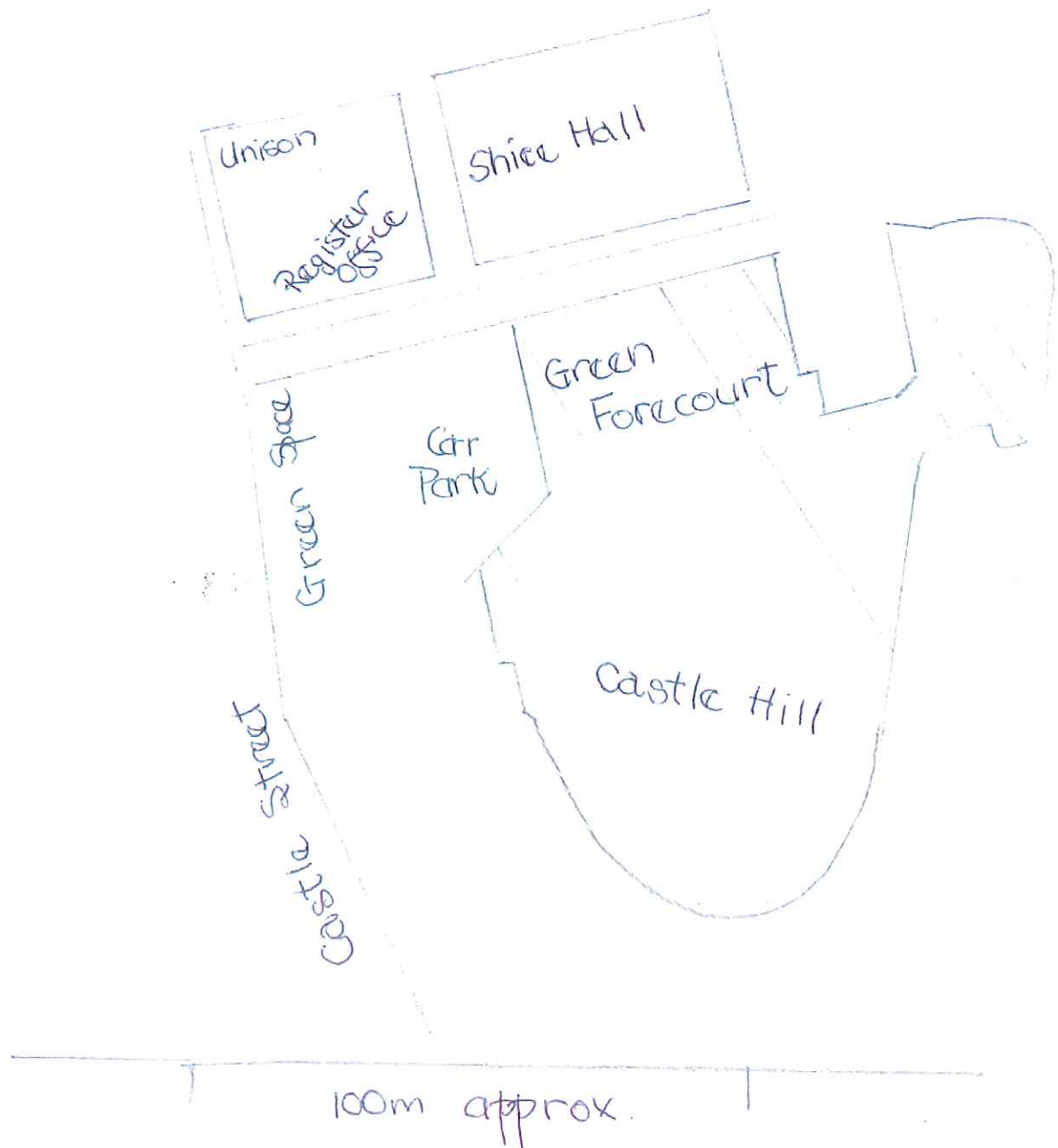

**EVIDENCE QUESTIONNAIRE IN SUPPORT OF REGISTRATION LAND AT SHIRE HALL CAMBRIDGE AS  
ON ATTACHED MAP A AS A TOWN GREEN**

GDPR disclaimer:

The data you provide will be used in connection with the application for the Shire Hall monument site and grassed forecourt to be classed as a town green. By participating in this questionnaire, you consent to our holding information about you for the purposes set out above.

Where we are processing personal data on your behalf we will take all reasonable measures to prevent the unauthorised or unlawful processing of your data and/or the accidental loss or destruction of or damage to your personal data.



We will hold your data for a reasonable period and we agree to delete your personal data from our systems when it is no longer required in accordance with the purposes for which it was supplied. If you wish to have your information deleted before then, please send us a request in writing.

You have the right at any time to request a copy of the information held about you and the details of the purposes for which it is held and processed. You also have the right to request that your personal data is erased from our records. We agree to comply with any request for information made by you within a reasonable time period and in any event within 30 days of receipt of a written request for information.

The Cambridge Labour Party will keep your personal information private and securely held. By submitting information you are agreeing to the use of data in accordance with GDPR.

NAME	Denys Hartley		
ADDRESS	7 Stretten Avenue, Cambridge		
POSTCODE	CB4 3ES	TELEPHONE NO	01223 355136

<b>Your address when you used the land (see attached map A)</b>	7 Stretten Avenue, Cambridge CB4 3ES
<b>Please confirm that you agree with the boundaries of the locality (or neighbourhood within a locality) on map A. Tick yes or no.</b>	Yes <input checked="" type="checkbox"/> No <input type="checkbox"/>
<b>For how many years have you known the land?</b>	From...1975..... to ...Present.....
<b>Between which years have you used the land?</b>	From...1980..... to...Present.....

<p><b>How do you/did you gain access to the land?</b> E.g do you simply walk onto the land?</p>	<p>Latterly – well during the past 30 years at least – we have always gained access via the footpath from McGrath Avenue</p>	
<p><b>Do you know of any activities that happen every year or more regularly on the land?</b> Please give details.</p>	<p>Watching fireworks – from Midsummer Common in November and various colleges' May Ball fireworks.</p>	
<p><b>Do you know of any community activities that have taken place on the land?</b> Please give details.</p>	<p>During the Queen's Jubilee weekend in 2012, a beacon was lit at the top of the Mound and for safety reasons, spectators were not allowed up the Mound but told to congregate on the Green Forecourt. I hope these poor quality photos, taken on 4 June 2012, illustrate that.</p> <div style="display: flex; justify-content: space-around; align-items: center;">   </div>	
<p><b>Tick the activities that you have engaged in on the land (Column A) or seen taking place on the land (Column B). Add any further activities at the end of the list.</b></p>		
	<b>A</b> (your use)	<b>B</b> (others' use)
1. Children playing	✓	✓
2. Rounders		
3. Drawing and Painting		✓
4. Dog Walking		✓
5. Team Games		
6. Football		
7. Cricket		
8. Bird watching		

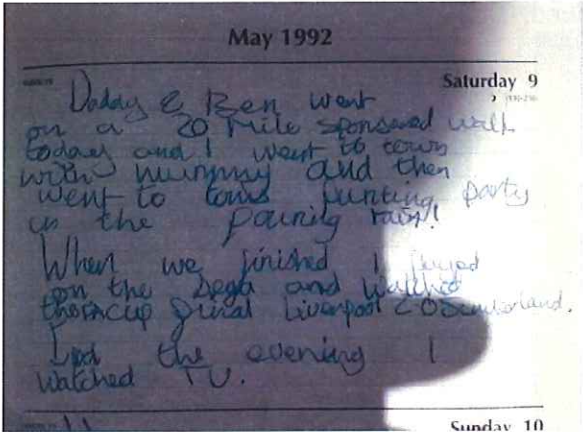
9. Picnicking	✓	✓
10. Kite flying		
11. People walking	✓	✓
12. Watching fireworks	✓	✓
13. Carol singing		
14. Faith celebrations and worship		
15. Community celebrations	✓	✓
16. Fetes		
17. Political marches		
18. Taking photographs for celebrations for such as weddings	✓	✓
19. Citizenship ceremonies		
<p>Any other: Examples include:</p> <ul style="list-style-type: none"> <li>On 09 May 1992 a large group walked across the Green (via the footpath from Magrath Avenue) as part of the route of a 20-mile sponsored walk for Oxfam that started from, I think, St Luke's School in French's Road. No photos of this I'm afraid but maybe this excerpt from my younger son's diary, (he was ten at the time) will suffice as proof that the walk took place.</li> </ul>  <ul style="list-style-type: none"> <li>In the early 80's, our children sledged a few times down the Mound (X-ray records can confirm one occasion when our eldest son broke his collar bone) and we have also relived this with a couple of our grandchildren – as demonstrated in this photo taken on 02 March 2018.</li> </ul>		





The same can be said for picnics and general sightseeing visits to the top of the Mound.

- A few weeks later on 8 July 2012 the Olympic Torch was taken up Castle Street en route to the Olympic Opening Ceremony. Again not good photos but I hope they act as a reminder. Whilst all eyes were on the Torch I think that the left hand edge of the lower photo below shows that some onlookers were on the Green / Mound.





- As mentioned, numerous couples use the Green Forecourt for photographs after their wedding at the Registrar Office. A wedding we attended on 5 April 2014 was no exception. This picture shows a few guests moving to the Castle Green for photographs.



20. ....  
 ....

Do you know who the owner of the land is?	No. Have always just assumed that it was public land that we could just visit
Was permission ever sought by you for activities on the land or to go onto the land? If so from whom and when?	No. Have always just assumed that it was public land that we could just visit
Have you ever been prevented from using the land? If yes, when and why?	Someone from the Analysys Office, based in Castle Street complained about children playing on one occasion.
Has any attempt ever been made by notice or fencing or by any other means to prevent or discourage the use being made of the land by the local people? If yes, please give examples.	I think the Mound has been fenced off in the past for safety reasons and to reduce soil erosion.
If you have any additional information, please add it below.	

--

I have carried out the activities referred to in this questionnaire for 40 years without anyone trying to stop me and I believe the activity should be treated by the law as having a lawful origin.
--

<i>I understand that the evidence form I have completed in relation to this application may become public knowledge and I authorise the applicant to disclose this form to anyone reasonably requiring access to this application.</i>
--

<i>I also understand that this evidence may be presented to a non-statutory inquiry and I authorise the applicant to use this form for that purpose.</i>
--

Signed.....Denys Hartley.....

Date...04 February 2020.....

Map A

Proposed Town Green  
Approx. scale only

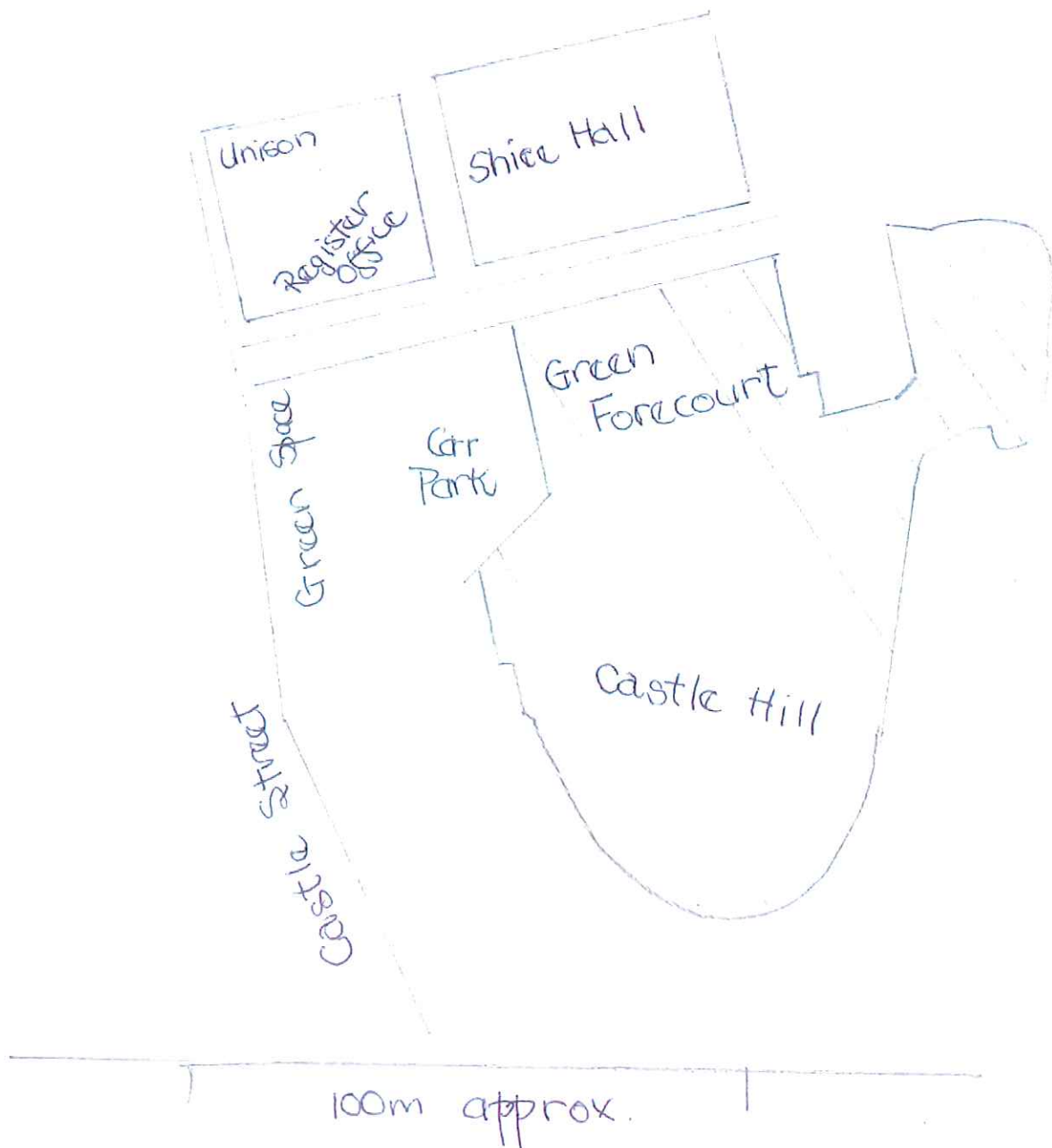

## Shire Hall – Castle Mound Questionnaire responses

1. Geoff Thwaites
2. Anne Thwaites
3. Anne Garvey
4. Anke Husman
5. Katie Thornburrow
6. Bill Thompson
7. Sebastian Carter
8. Joe S Sanders
9. Melendra Sutliff Sanders
10. Mary Wheeler
11. Ann Mullinger
12. Catherine Belsay





I would like to add my voice to those supporting keeping Castle Mound in Cambridge as a community space.

I live nearby and it is one of the first places I encourage visitors to see. It gives a wonderful view of Cambridge both visually and historically. Secondly I frequently take the path from the Searle St area across to Castle Hill. This is a very valuable pathway for ease of access and not having to walk on busy roads.

I am strongly in favour of retaining Castle Mound and access around it open to the public with no restrictions.

Martin Willitts

