

Dr Jocelynn A. Scutt  
Barrister & Writer  
Chairperson, Milton Road Local Liaison Forum  
Labour Highways & Community Infrastructure Lead  
Labour County Councillor for Arbury, Cambridgeshire

<https://www.youtube.com/watch?v=-AEIEoTROjg>

<https://www.youtube.com/watch?v=j7pwVxxO-GU>

<http://www.womenaustralia.info/lawyers/biogs/AWE4429b.htm>

The arc of the moral universe is long, but it bends toward justice.  
Martin Luther King

Right temporarily defeated is stronger than wrong triumphant.  
Martin Luther King

Never stop believing that fighting for what's right is worth it ... It is worth it.  
Hillary Clinton

To be hopeful in bad times is not just foolishly romantic. It is based on the fact that human history is a history not only of cruelty but also of compassion, sacrifice, courage, kindness... If we see only the worst, it destroys our capacity to do something. If we remember those times and places ... where people have behaved magnificently, this gives us the energy to act and at least the possibility of sending this spinning top of a world in a different direction ... The future is an infinite succession of presents, and to live now as we think human beings should live, in defiance of all that is bad around us, is itself a marvelous victory.

Howard Zinn

[arburylabour.cambridgelabour.org.uk](http://arburylabour.cambridgelabour.org.uk)  
[westchestertonlabour.cambridgelabour.org.uk](http://westchestertonlabour.cambridgelabour.org.uk)  
[castlelabour.cambridgelabour.org.uk](http://castlelabour.cambridgelabour.org.uk)

--

Dr Jocelynn A. Scutt  
Barrister & Writer  
Chairperson, Milton Road Local Liaison Forum  
Labour Highways & Community Infrastructure Lead  
Labour County Councillor for Arbury, Cambridgeshire

<https://www.youtube.com/watch?v=-AEIEoTROjg>

<https://www.youtube.com/watch?v=j7pwVxxO-GU>

<http://www.womenaustralia.info/lawyers/biogs/AWE4429b.htm>

The arc of the moral universe is long, but it bends toward justice.  
Martin Luther King

Right temporarily defeated is stronger than wrong triumphant.  
Martin Luther King

Never stop believing that fighting for what's right is worth it ... It is worth it.  
Hillary Clinton

To be hopeful in bad times is not just foolishly romantic. It is based on the fact that human history is a history not only of cruelty but also of compassion, sacrifice, courage, kindness... If we see only the worst, it destroys our capacity to do something. If we remember those times and places ... where people have behaved magnificently, this gives us the energy to act and at least the possibility of sending this spinning top of a world in a different direction ... The future is an infinite succession of presents, and to live now as we think human beings should live, in defiance of all that is bad around us, is itself a marvelous victory.

Howard Zinn

[arburylabour.cambridgelabour.org.uk](http://arburylabour.cambridgelabour.org.uk)  
[westchestertonlabour.cambridgelabour.org.uk](http://westchestertonlabour.cambridgelabour.org.uk)  
[castlelabour.cambridgelabour.org.uk](http://castlelabour.cambridgelabour.org.uk)





From Professor John Blair FBA

The Queen's College  
Oxford  
OX1 4AW  
[john.blair@queens.ox.ac.uk](mailto:john.blair@queens.ox.ac.uk)

9 July 2019

### Cambridge Castle: proposed development

I write to add my own voice to the many others expressing concern at the proposed developments at Cambridge Castle, and the loss of public space likely to result.

The castle has been the historic centre of the shire for nearly a thousand years, and the settling of many public and social activities through the centuries. Even if public access to the mound itself is assured, development of the open spaces would still represent a serious and permanent diminution of the public character of the site. The castle should be a focus, not a preserved monument tucked away in the midst of modern buildings.

The privatization of public open spaces is a pernicious current trend. However much local government funding has been squeezed, the creeping attitude that we cannot afford to maintain precious and special places for the public benefit is unacceptable and has to be resisted. Designation as a Town Green would be one very good way securing it for the future.

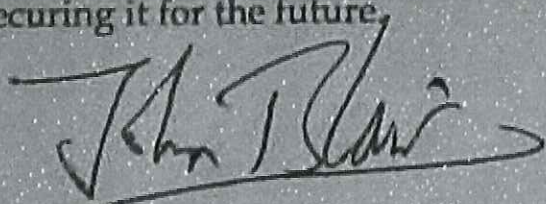

Professor of Medieval History and Archaeology, University of Oxford  
Fellow and Praelector in History, The Queen's College, Oxford



**Application received 10 June 2019 – following evidence submitted since receipt of application:**

<b>Date of receipt</b>	<b>Form of receipt</b>	<b>Documents</b>
4.7.2019	Letter – Claire Richards	1. Newspaper clippings, photos, letters etc
16.7.2019	Email – Claire Richards	1. Letter dated 15 July – Richard Dance 2. statement of Sara Payne 3. Letter from Sonia Leach
28.7.2019	Email – Claire Richards	1. Castle Hill Memories document
5.8.2019	Email – Claire Richards	1. Statement of Diana Loizou
25.8.2019	Email – Claire Richards	1. Letter of John Blair
8.9.2019	Email – Claire Richards	1. Statement of Angela Williams 2. Statement of Rosalind Lund 3. Statement of Ila Chandavarkar 4. Statement of Jacqueline Harmitt 5. Statement Janet Moreton
12.9.2019	Email – Claire Richards	1. Statement from CPRE Cambridgeshire & Peterborough (on email)
27.9.2019	Email – Claire Richards	1. Statement from Lisa Woodburn (by email)





UNIVERSITY OF  
CAMBRIDGE

Department of Anglo-Saxon,  
Norse and Celtic

**Dr Richard Dance**  
*Head of Department*

*Reader in Early English*  
Department of ASNC  
9 West Road  
Cambridge  
CB3 9DP

*Fellow and Praelector*  
St Catharine's College  
Cambridge  
CB2 1RL

Cambridgeshire County Council  
Shire Hall  
Cambridge

15 July 2019

### **Cambridge Castle Mound**

I was very concerned to learn that Cambridgeshire County Council proposes to sell or lease the Shire Hall site, including the Mound and earthworks of Cambridge Castle. As a longstanding teacher and researcher of the early Middle Ages I can attest that the Castle site — one of very few surviving Norman mottes — is of profound national importance to our cultural heritage. It is essential that public access to the Castle Mound and its associated earthworks be guaranteed for future generations. I write in strong support of the proposal that the site be designated a Town Green, giving public access statutory protection in perpetuity.

Yours faithfully,

Dr Richard Dance.





## STATEMENT FOR FRIENDS OF CASTLE MOUND

Name: Sara Payne

Address: 10 Dalegarth, Hurst Park Avenue, Cambridge (from 1991 to present); previously .

34 Magrath Avenue, Cambridge. 1970 – 1991

Arrived in Cambridge in the Spring of 1970 from London where I had been a reporter on The Times Educational Supplement; started work on the Cambridge Evening News as Woman's Page Editor; married in September 1970.

Magrath Avenue is situated right behind The Castle Mound, so I was familiar with it from local walks.

But the historical significance of the Mound was brought vividly home to me in February 1981 when I started researching the first of a series of articles on the history of Cambridge streets. For six years between 1981-1986 the feature articles, "Down Your Street" in which I researched and documented Cambridge past and present, informed and interested readers both in the city and the county, and even abroad.

But to go back to the beginning. How did the whole "Down Your Street" project begin? It was back in 1981 when I was working as a very part-time freelance journalist for the "News". I had edited the woman's page and been a feature writer there back in the early 1970s before my children were born. The then editor of the "Weekly News", the late Gordon Richards, said that he wanted to revive the idea of a "Down Your Street" feature on Cambridge. There had been a similar feature written by Erica Dimock in the 1960s. I agreed to have a go although I must admit I didn't feel very inspired. I couldn't think what the "angle" as journalists call it, was going to be.

But then I had a great stroke of luck. I did a "recce" for the first article on Castle Street, and began by climbing Castle Mound on a February morning in 1981 and surveying the view. Back in the grounds of Shire Hall, I bumped into the Shire Hall gardener, Reg Pawley who was working away among the rosebeds. I told him about my project. "Come over here," he said. "Do you see that dip in the ground where there is a puddle, there is always a damp patch there even though it has been tarmaced over. That's where the hanging pits used to be." The hanging pits recalled darker days of castles, prisoners, gaols and

gallows. I also found out that a bit of the Castle had remained on the hill until 1842. It had been used as a prison until a new one was built to replace it. Reg also showed me the bars on the windows of the social services buildings. Those were the cells when it was a police station.

Well after that I was well and truly hooked on finding out what was there before, who had lived and worked in a particular area, what their lives had been like. It was the social history that intrigued me.

For example while researching the first article on Castle Street I was told an anecdote about prisoners. The story was that when prisoners escaped from the prison on Castle Hill they used to seek sanctuary in St Peter's Church where they clung to the altar rails.

So in this most historic part of Cambridge, with Roman remains, as well as the Castle Mound – the sole survivor of the medieval earthworks, inspiration came to me to take a view of the city's streets that combined the broad historical perspective with the then current topography whilst fleshing it out with details supplied by local newspaper records, personal reminiscence and eye witness accounts of local residents, many of whom had lived all their lives in the street; many had been to school there, had grown up and played with other local children, and knew a great deal about the locality, such as the pubs (there used to be 11 in the Castle St area), the local shops (many many more than there are today. In many cases their parents or grandparents had built the houses they were living in.

In researching the history of Cambridge streets over a period of six years in the 1980s without a break, and in interviewing people for the column, what struck me was the very great pace of rapid change in the more densely populated areas of the city. The change has accelerated even more rapidly in the last 30 years or so, as we all know.

But what never changes is the historical significance of an area, and with The Castle Mound centuries of history abound. Here William the Conqueror had a wooden castle built, which Edward I replaced with a stone one. By the 16<sup>th</sup> century it was in ruins and its stones were used to build King's College Chapel. That is history for you. So Keep The Castle Mound as an historic Open Space. It is a crucial part of Cambridge's history.

Sara Payne 10/07/2019



## STATEMENT FOR FRIENDS OF CASTLE MOUND

Name: Sara Payne

Address: 10 Dalegarth, Hurst Park Avenue, Cambridge (from 1991 to present); previously .

34 Magrath Avenue, Cambridge. 1970 – 1991

Arrived in Cambridge in the Spring of 1970 from London where I had been a reporter on The Times Educational Supplement; started work on the Cambridge Evening News as Woman's Page Editor; married in September 1970.

Magrath Avenue is situated right behind The Castle Mound, so I was familiar with it from local walks.

But the historical significance of the Mound was brought vividly home to me in February 1981 when I started researching the first of a series of articles on the history of Cambridge streets. For six years between 1981-1986 the feature articles, "Down Your Street" in which I researched and documented Cambridge past and present, informed and interested readers both in the city and the county, and even abroad.

But to go back to the beginning. How did the whole "Down Your Street" project begin? It was back in 1981 when I was working as a very part-time freelance journalist for the "News". I had edited the woman's page and been a feature writer there back in the early 1970s before my children were born. The then editor of the "Weekly News", the late Gordon Richards, said that he wanted to revive the idea of a "Down Your Street" feature on Cambridge. There had been a similar feature written by Erica Dimock in the 1960s. I agreed to have a go although I must admit I didn't feel very inspired. I couldn't think what the "angle" as journalists call it, was going to be.

But then I had a great stroke of luck. I did a "recce" for the first article on Castle Street, and began by climbing Castle Mound on a February morning in 1981 and surveying the view. Back in the grounds of Shire Hall, I bumped into the Shire Hall gardener, Reg Pawley who was working away among the rosebeds. I told him about my project. "Come over here," he said. "Do you see that dip in the ground where there is a puddle, there is always a damp patch there even though it has been tarmaced over. That's where the hanging pits used to be." The hanging pits recalled darker days of castles, prisoners, gaols and

gallows. I also found out that a bit of the Castle had remained on the hill until 1842. It had been used as a prison until a new one was built to replace it. Reg also showed me the bars on the windows of the social services buildings. Those were the cells when it was a police station.

Well after that I was well and truly hooked on finding out what was there before, who had lived and worked in a particular area, what their lives had been like. It was the social history that intrigued me.

For example while researching the first article on Castle Street I was told an anecdote about prisoners. The story was that when prisoners escaped from the prison on Castle Hill they used to seek sanctuary in St Peter's Church where they clung to the altar rails.

So in this most historic part of Cambridge, with Roman remains, as well as the Castle Mound – the sole survivor of the medieval earthworks, inspiration came to me to take a view of the city's streets that combined the broad historical perspective with the then current topography whilst fleshing it out with details supplied by local newspaper records, personal reminiscence and eye witness accounts of local residents, many of whom had lived all their lives in the street; many had been to school there, had grown up and played with other local children, and knew a great deal about the locality, such as the pubs (there used to be 11 in the Castle St area), the local shops (many many more than there are today. In many cases their parents or grandparents had built the houses they were living in.

In researching the history of Cambridge streets over a period of six years in the 1980s without a break, and in interviewing people for the column, what struck me was the very great pace of rapid change in the more densely populated areas of the city. The change has accelerated even more rapidly in the last 30 years or so, as we all know.

But what never changes is the historical significance of an area, and with The Castle Mound centuries of history abound. Here William the Conqueror had a wooden castle built, which Edward I replaced with a stone one. By the 16<sup>th</sup> century it was in ruins and its stones were used to build King's College Chapel. That is history for you. So Keep The Castle Mound as an historic Open Space. It is a crucial part of Cambridge's history.

Sara Payne 10/07/2019



24 Windsor Road Cambridge CB4 3JW

01223 329486 07876 261344

[s.leach40@ntlworld.com](mailto:s.leach40@ntlworld.com)

Planning Department  
Cambridge County Council  
Shire Hall  
Castle Hill  
Cambridge  
CB3 0AP

Dear Sir or Madam

**Redevelopment of Shire Hall site, including Castle Mound**

I have just heard that there are plans afoot to turn Cambridgeshire County headquarters into high-rental accommodation, and that there are no guarantees that the Norman motte which lies on the Roman site of Cambridge Castle Mound, will be protected.

As an important site of historic interest I understand that the area could be designated as a Town Green in order to save it for future generations of Cambridge residents.

As a Cambridge resident for 28 years, I would be wholly FOR this plan, as I am wholly AGAINST the total redevelopment of this site.

In the hope that you will take these concerns seriously,

yours sincerely,

Sonia Leach



## STATEMENT – PUBLIC ACCESS CASTLE MOUND & GRASSED FORECOURT SHIRE HALL

This statement is made in support of the application by Cllr Claire Richards, County Councillor for Castle, Cllr Jocelynne A. Scutt, County Councillor for Arbury, and Cllr Katie Thornburrow, City Councillor and Executive Councillor for Streets & Open Spaces, for Castle Mound and the grassed forecourt to Shire Hall to be registered as a Town Green. The application is supported by Friends of Castle Mound of which Cllrs Richards and Scutt are founding members, Frank Gawthroe Chair, Isabel Lambourne Secretary, Paul Lythgoe Treasurer + Members

NAME: DIANA LOIZOU

ADDRESS: 4, THE TERRACE, ST. PETER'S ST. CAMBRIDGE CB3 0BE

ANY OTHER CAMBRIDGE ADDRESSES PREVIOUSLY:

DATE COMMENCED LIVING IN CAMBRIDGE:

1952

ACCESS TO CASTLE MOUND AND/OR GRASSED FORECOURT

(Note – please be as explicit as to activities, times and dates – use more paper if required)

eg walking to top of Castle Mound for fireworks or sightseeing or in conjunction with groups – eg Church groups, family groups, school groups, excursion groups for example Alan Brigham's walks, picnics, sports, strolling, dog walking, taking friends or visitors, viewing Cambridge from the top, maypole dancing with school groups eg Parkside, any other activities – search your memory and recollections from the past as well as the present.

Also if you have visited the Civil War Earthworks, please add this with date/s.

### STATEMENT

walking to top with + without grandchildren, fireworks,  
Alan Brigham's walks, viewing Cambridge. My children played  
here in 80's + 90's. Often with them.  
visited earthworks often. Go there weekly for at least  
30 years.



"I remember going to Castle Hill one fireworks night, maybe 4 years ago now, and it brought all ages together and made a lovely community of people."

- Holly Hodgson
- 4 Gresham Place, CB1 2EB
- 10/07/19

"Castle Hill has been such a special place for me growing up. I have so many beautiful memories there; watching the sunsets over Cambridge, going for early morning runs, gathering there with friends, eating picnics, sitting with a sketch-pad and drawing the Cambridge sky-line. Whenever people come to visit me in Cambridge, Castle-Hill is somewhere I take them to see the city from above and to access some tranquility from the business of town below."

- Esme Miller
- 11 Upper Gwydir Street, Cambridge, CB1 2LR
- 17/07/19

"Castle hill is special. It's sort of a place I'd sometimes go if I was feeling low about something and wanted to sit and mull it over with a nice view."

- Mr. Thompson
- 38 Mill End Road, CB1 9JP
- 14/07/19

"I remember when we went to Nina's house (a close friend) early at dawn on her birthday with tasty breakfast things, fruit and croissants. We took her to castle hill, blindfolded her so she didn't know where she was going and when we took the blindfold off we had breakfast set up and we sat and watched the sunrise from the hill."

"Also, when me and Tomas registered to get married and he had broken his knee but insisted on going all the way up on his crutches, that was lovely too."

- Ruby Gillespie
- 151 Stanley Road, Cambridge CB5 8LF
- 14/07/19

"I once went up Castle Hill to watch the Cambridge University May Ball fireworks. It was such a brilliant view."

- Verity Miller
- 11 Upper Gwydir Street, Cambridge, CB1 2LR
- 14/07/19





"I remember going to Castle Hill one fireworks night, maybe 4 years ago now, and it brought all ages together and made a lovely community of people."

- Holly Hodgson
- 4 Gresham Place, CB1 2EB
- 10/07/19

"Castle Hill has been such a special place for me growing up. I have so many beautiful memories there; watching the sunsets over Cambridge, going for early morning runs, gathering there with friends, eating picnics, sitting with a sketch-pad and drawing the Cambridge sky-line. Whenever people come to visit me in Cambridge, Castle-Hill is somewhere I take them to see the city from above and to access some tranquility from the business of town below."

- Esme Miller
- 11 Upper Gwydir Street, Cambridge, CB1 2LR
- 17/07/19

"Castle hill is special. It's sort of a place I'd sometimes go if I was feeling low about something and wanted to sit and mull it over with a nice view."

- Mr. Thompson
- 38 Mill End Road, CB1 9JP
- 14/07/19

"I remember when we went to Nina's house (a close friend) early at dawn on her birthday with tasty breakfast things, fruit and croissants. We took her to castle hill, blindfolded her so she didn't know where she was going and when we took the blindfold off we had breakfast set up and we sat and watched the sunrise from the hill."

"Also, when me and Tomas registered to get married and he had broken his knee but insisted on going all the way up on his crutches, that was lovely too."

- Ruby Gillespie
- 151 Stanley Road, Cambridge CB5 8LF
- 14/07/19

"I once went up Castle Hill to watch the Cambridge University May Ball fireworks. It was such a brilliant view."

- Verity Miller
- 11 Upper Gwydir Street, Cambridge, CB1 2LR
- 14/07/19



**EVIDENCE QUESTIONNAIRE IN SUPPORT OF REGISTRATION LAND AT SHIRE HALL CAMBRIDGE AS  
ON ATTACHED MAP A AS A TOWN GREEN**

GDPR disclaimer:

The data you provide will be used in connection with the application for the Shire Hall monument site and grassed forecourt to be classed as a town green. By participating in this questionnaire, you consent to our holding information about you for the purposes set out above.

Where we are processing personal data on your behalf we will take all reasonable measures to prevent the unauthorised or unlawful processing of your data and/or the accidental loss or destruction of or damage to your personal data.

We will hold your data for a reasonable period and we agree to delete your personal data from our systems when it is no longer required in accordance with the purposes for which it was supplied. If you wish to have your information deleted before then, please send us a request in writing.

You have the right at any time to request a copy of the information held about you and the details of the purposes for which it is held and processed. You also have the right to request that your personal data is erased from our records. We agree to comply with any request for information made by you within a reasonable time period and in any event within 30 days of receipt of a written request for information.

The Cambridge Labour Party will keep your personal information private and securely held. By submitting information you are agreeing to the use of data in accordance with GDPR.

<b>NAME</b>	Geoff Thwaites		
<b>ADDRESS</b>	11 Harvey Goodwin Avenue, Cambridge		
<b>POSTCODE</b>	CB4 3EX	<b>TELEPHONE NO</b>	01223 357040

<b>Your address when you used the land (see attached map A)</b>	11 Harvey Goodwin Avenue Cambridge CB4 3EX
<b>Please confirm that you agree with the boundaries of the locality (or neighbourhood within a locality) on map A. Tick yes or no.</b>	Yes ✓  No
<b>For how many years have you known the land?</b>	From...1965.....  to ...Present.....
<b>Between which years have you used the land?</b>	From...1978.....  to...Present.....
<b>How do you/did you gain access to</b>	

the land? E.g do you simply walk onto the land?	Walk via footpath from Magrath Avenue	
Do you know of any activities that happen every year or more regularly on the land? Please give details.		
Do you know of any community activities that have taken place on the land? Please give details.		
<b>Tick the activities that you have engaged in on the land (Column A) or seen taking place on the land (Column B). Add any further activities at the end of the list.</b>		
	<b>A (your use)</b>	<b>B (others' use)</b>
1. Children playing	✓	✓
2. Rounders		
3. Drawing and Painting		✓
4. Dog Walking	✓	✓
5. Team Games		
6. Football		✓
7. Cricket		
8. Bird watching		
9. Picnicking	✓	✓
10. Kite flying		✓
11. People walking	✓	✓
12. Watching fireworks	✓	✓
13. Carol singing		
14. Faith celebrations and worship		
15. Community celebrations		
16. Fetes		
17. Political marches		
18. Taking photographs for celebrations for such as weddings		✓
19. Citizenship ceremonies		
20. Any other: .....		



.....			
Do you know who the owner of the land is?	Cambridgeshire County Council		
Was permission ever sought by you for activities on the land or to go onto the land? If so from whom and when?	No		
Have you ever been prevented from using the land? If yes, when and why?	No		
Has any attempt ever been made by notice or fencing or by any other means to prevent or discourage the use being made of the land by the local people? If yes, please give examples.	No		
If you have any additional information, please add it below.			

I have carried out the activities referred to in this questionnaire for.....42.years without anyone trying to stop me and I believe the activity should be treated by the law as having a lawful origin.

*I understand that the evidence form I have completed in relation to this application may become public knowledge and I authorise the applicant to disclose this form to anyone reasonably requiring access to this application.*

*I also understand that this evidence may be presented to a non-statutory inquiry and I authorise the applicant to use this form for that purpose.*

Signed..... 

.....Date.....5/2/20.....

Map A

# Proposed Town Green

Approx. scale only

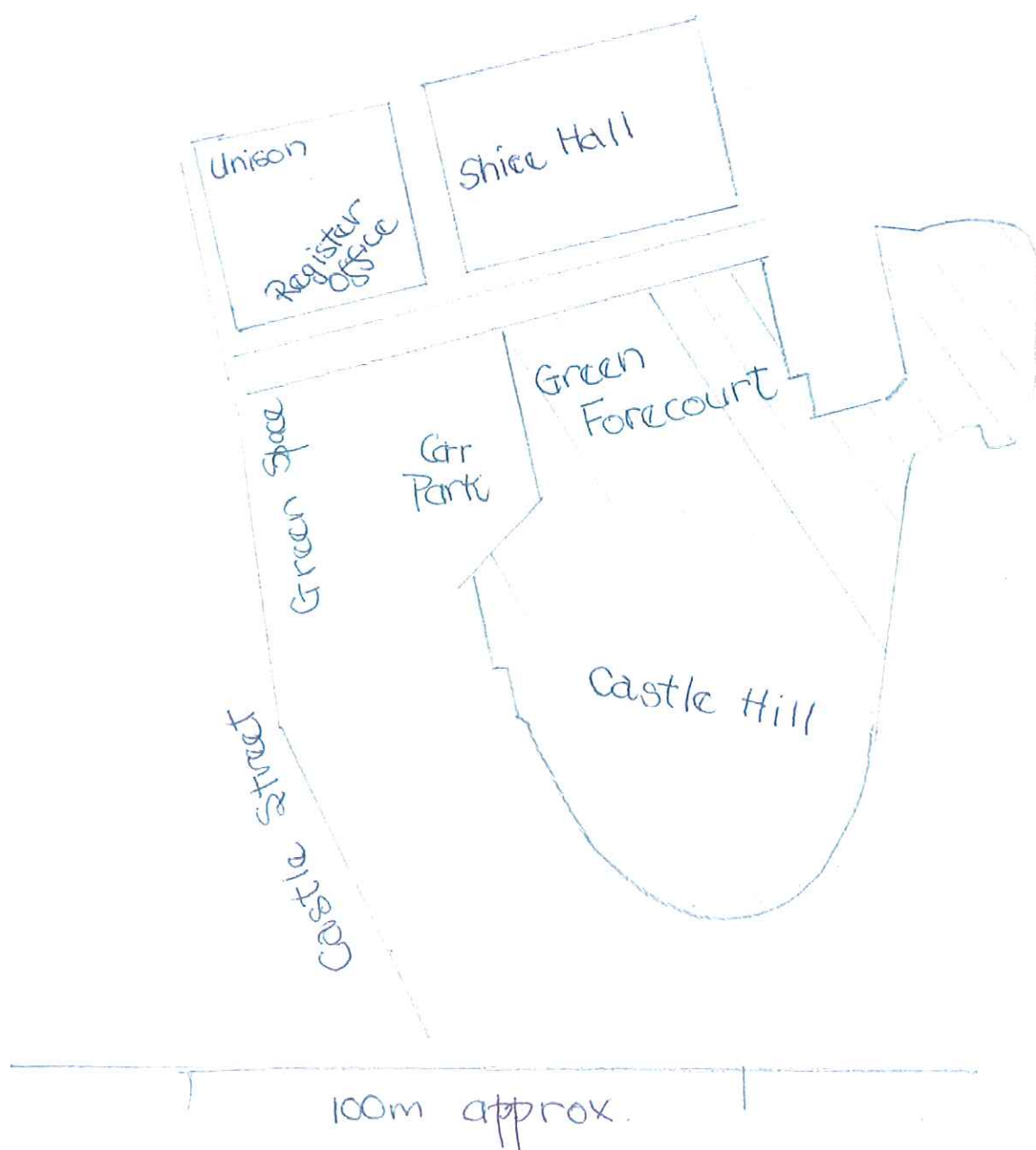



**EVIDENCE QUESTIONNAIRE IN SUPPORT OF REGISTRATION LAND AT SHIRE HALL CAMBRIDGE AS  
ON ATTACHED MAP A AS A TOWN GREEN**  
GDPR disclaimer:

The data you provide will be used in connection with the application for the Shire Hall monument site and grassed forecourt to be classed as a town green. By participating in this questionnaire, you consent to our holding information about you for the purposes set out above.

Where we are processing personal data on your behalf we will take all reasonable measures to prevent the unauthorised or unlawful processing of your data and/or the accidental loss or destruction of or damage to your personal data.

We will hold your data for a reasonable period and we agree to delete your personal data from our systems when it is no longer required in accordance with the purposes for which it was supplied. If you wish to have your information deleted before then, please send us a request in writing.

You have the right at any time to request a copy of the information held about you and the details of the purposes for which it is held and processed. You also have the right to request that your personal data is erased from our records. We agree to comply with any request for information made by you within a reasonable time period and in any event within 30 days of receipt of a written request for information.

The Cambridge Labour Party will keep your personal information private and securely held. By submitting information you are agreeing to the use of data in accordance with GDPR.

<b>NAME</b>	Anne Thwaites		
<b>ADDRESS</b>	11, Harvey Goodwin Avenue		
<b>POSTCODE</b>	CB4 3EX	<b>TELEPHONE NO</b>	01223 357040

<b>Your address when you used the land (see attached map A)</b>	11, Harvey Goodwin Avenue, Cambridge CB4 3EX
<b>Please confirm that you agree with the boundaries of the locality (or neighbourhood within a locality) on map A. Tick yes or no.</b>	Yes <input checked="" type="checkbox"/> No <input type="checkbox"/>
<b>For how many years have you known the land?</b>	From...1968.....  to ...Present.....
<b>Between which years have you used the land?</b>	From...1968.....  to...Present.....



<b>How do you/did you gain access to the land?</b> E.g do you simply walk onto the land?	Walk	
<b>Do you know of any activities that happen every year or more regularly on the land?</b> Please give details.	Sight seeing – highest point in central Cambridge Watching fireworks – 5Nov, May Balls etc Marking new year, millenium, sunsets/sunrises Wedding photos etc	
<b>Do you know of any community activities that have taken place on the land?</b> Please give details.	Millenium beacon lighting	
<b>Tick the activities that you have engaged in on the land (Column A) or seen taking place on the land (Column B). Add any further activities at the end of the list.</b>		
	<b>A (your use)</b>	<b>B (others' use)</b>
1. Children playing	✓	✓
2. Rounders		
3. Drawing and Painting		
4. Dog Walking		✓
5. Team Games		
6. Football		
7. Cricket		
8. Bird watching		
9. Picnicking		✓
10. Kite flying		
11. People walking	✓	✓
12. Watching fireworks	✓	✓
13. Carol singing		
14. Faith celebrations and worship		
15. Community celebrations		✓
16. Fetes		
17. Political marches		
18. Taking photographs for celebrations for such as weddings		✓
19. Citizenship ceremonies		✓