

# **PUBLIC PATH DIVERSION ORDER**

## **HIGHWAYS ACT 1980**

### **MID SUFFOLK DISTRICT COUNCIL (STOWMARKET FOOTPATHS 18(PART) AND 62) PUBLIC PATH DIVERSION ORDER 2025**

This order is made by Mid Suffolk District Council ("the authority") under section 119 of the Highways Act 1980 ("the 1980 Act") because it appears to the authority that in the interests of the owners of the land crossed by the footpaths described in paragraph 1 of this order and of the public it is expedient that the lines of the paths should be diverted.

Mid Suffolk District Council has agreed to defray any compensation which becomes payable in consequence of the coming into force of the order, and any expenses which are incurred in bringing the new sites of the paths into a fit condition for use by the public.

Suffolk County Council has been consulted as required by section 120(2) of the 1980 Act and Suffolk County Council has consented to the making of the order.

#### **BY THIS ORDER:**

1. The public rights of way over the land situate at Stowmarket and shown by bold continuous lines on the map contained in this order and described in Part 1 of the Schedule to this order shall be stopped up on the date of confirmation of this order.
2. There shall on the date of confirmation of this order be public footpaths over the land situate at Stowmarket described in Part 2 of the Schedule and shown by bold broken lines on the map contained in this order.

GIVEN under the Common Seal of Mid Suffolk District Council this 27<sup>th</sup> day of November 2025

THE COMMON SEAL of )  
MID SUFFOLK DISTRICT )  
COUNCIL was hereunto )  
affixed in the presence of: )



13115

*Caw*

Authorised Officer

Mid Suffolk District Council hereby confirms the foregoing Order given under the Common Seal of Mid Suffolk District Council this 22<sup>nd</sup> day of January 2026

THE COMMON SEAL of  
MID SUFFOLK DISTRICT  
COUNCIL was hereunto  
affixed in the presence of:

*[Signature]*  
Authorised Officer



13135

## SCHEDULE

### PART 1

#### DESCRIPTION OF SITES OF EXISTING PATHS

**Stowmarket Footpath 18(part)** - The entire width of that part of Stowmarket Footpath 18 commencing at Ordnance Survey grid reference TM04435889 at point A and proceeding in a north westerly direction for approximately 29 metres to Ordnance Survey grid reference TM0441358913 at point B; this being the route shown between points A – B on the order map.

**Stowmarket Footpath 62** – The whole of Stowmarket Footpath 62 commencing at Ordnance Survey grid reference TM04435889 at point A at a junction with Stowmarket Footpath 18 and proceeding in a north easterly direction for 11 metres to join Stowmarket Restricted Byway 55 at Ordnance Survey grid reference TM 04445891 at point C; this being the route shown between points A – C on the order map.

## **PART 2**

### **DESCRIPTION OF SITES OF NEW PATHS**

**Stowmarket Footpath 18(part)** - Commencing at Ordnance Survey grid reference TM04435889 at point A at a junction with Stowmarket Footpath 62 and proceeding in a north westerly direction adjacent to a row of parking bays for approximately 27.5 metres to Ordnance Survey grid reference TM0441458911 at point D then in a north north westerly direction for approximately 2.5 metres to join the existing route at Ordnance Survey grid reference TM0441358913 at point B; this being the route shown between points A – D – B on the order map.

Width: Varying between 1.8 metres and 2.5 metres

**Stowmarket Footpath 62** - Commencing at Ordnance Survey grid reference TM04435889 at point A at a junction with Stowmarket Footpath 18 and proceeding in an east south easterly direction for approximately 4.5 metres to Ordnance Survey grid reference TM04445889 at point E then in a north north easterly direction for approximately 11 metres to join Stowmarket Restricted Byway 55 at the U4541 road (Walnut Tree Walk) at Ordnance Survey grid reference TM04445890 at point F; this being the route shown between points A – E – F on the order map.

Width: Varying between 1.64 metres and 2.5 metres



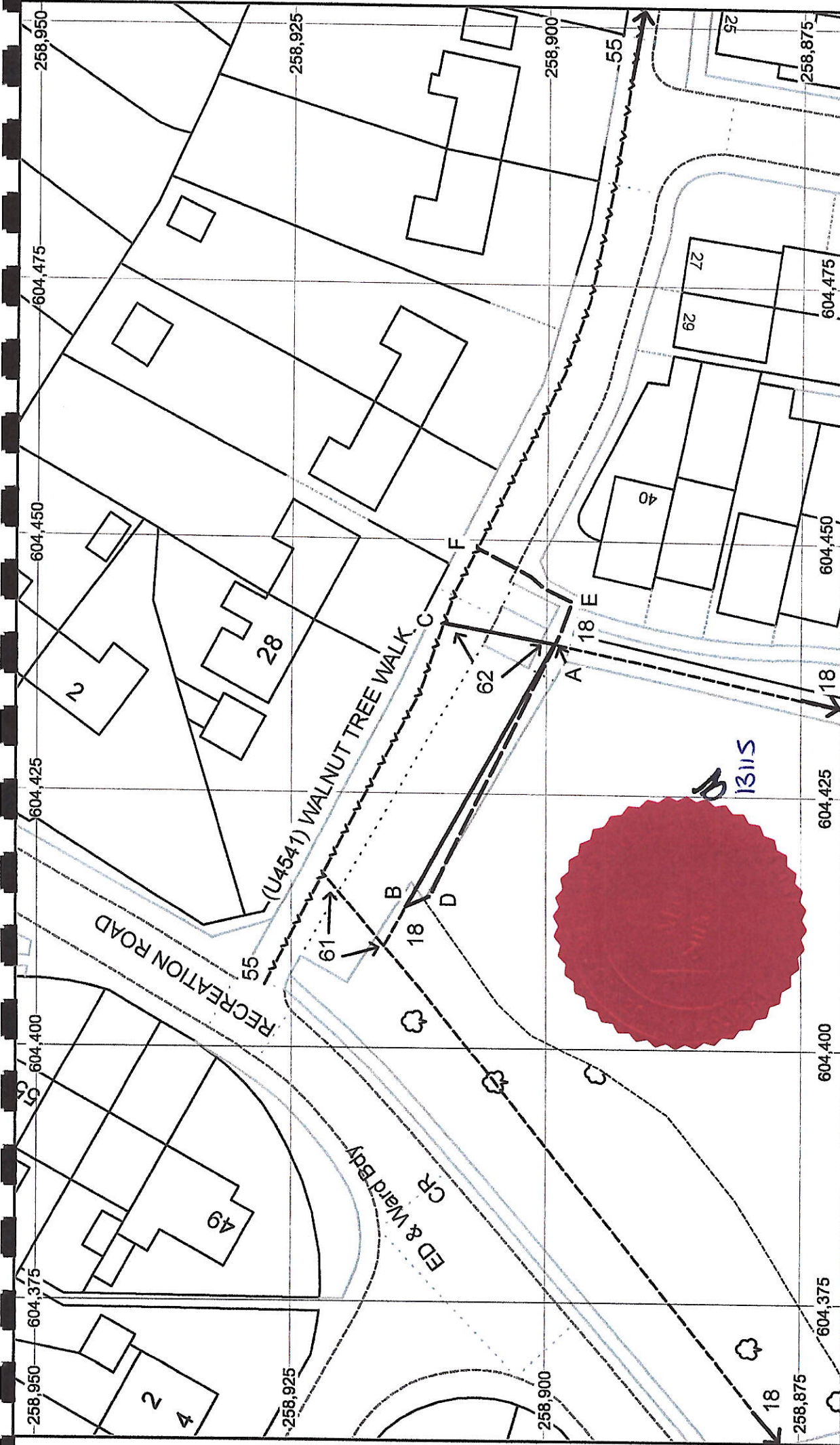

**MAP REFERRED TO IN THE MID SUFFOLK DISTRICT COUNCIL (STOWMARKET FOOTPATHS 18(PART) AND 62) PUBLIC PATH DIVERSION ORDER 2025 - HIGHWAYS ACT 1980 SECTION 119**

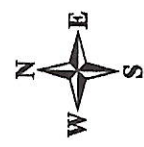

Scale: 1:500 at A4

- Footpath to be diverted (A-B) (A-C)
- Proposed footpath (A-D-B) (A-E-F)
- Unaffected Footpath
- Unaffected Restricted Byway



# NOTICE OF CONFIRMATION OF PUBLIC PATH ORDER

## HIGHWAYS ACT 1980

### MID SUFFOLK DISTRICT COUNCIL (STOWMARKET FOOTPATHS 18(PART) AND 62) PUBLIC PATH DIVERSION ORDER 2025

On 22 January 2026 Mid Suffolk District Council confirmed the above order made under Section 119 of the Highways Act 1980.

The effect of the order as confirmed is to divert the following public footpaths at Walnut Tree Walk in Stowmarket as described in the order and as shown on the order map:

**Stowmarket Footpath 18(part)** – The entire width of that part of Stowmarket Footpath 18 commencing at Ordnance Survey grid reference (OSGR) TM04435889 and proceeding in a north westerly direction for approximately 29 metres to OSGR TM0441358913 to a new line commencing at OSGR TM04435889 at a junction with Stowmarket Footpath 62 and proceeding in a north westerly direction adjacent to a row of parking bays for approximately 27.5 metres to OSGR TM0441458911 then in a north north westerly direction for approximately 2.5 metres to join the existing route at OSGR TM0441358913.

**Stowmarket Footpath 62** - The whole of Stowmarket Footpath 62 commencing at OSGR TM04435889 at a junction with Stowmarket Footpath 18 and proceeding in a north easterly direction for 11 metres to join Stowmarket Restricted Byway 55 at Ordnance Survey grid reference TM 04445891 to a new line commencing at OSGR TM04435889 at a junction with Stowmarket Footpath 18 and proceeding in an east south easterly direction for approximately 4.5 metres to OSGR TM04445889 then in a north north easterly direction for approximately 11 metres to join Stowmarket Restricted Byway 55 at the U4541 road (Walnut Tree Walk) at OSGR TM04445890.

A copy of the order as confirmed and the order map may be obtained free of charge by contacting Sharon Berry via email at [public.realm@baberghmidsuffolk.gov.uk](mailto:public.realm@baberghmidsuffolk.gov.uk). They can also be inspected at Stowmarket Library, Milton Road, Stowmarket, IP14 1EX between the hours of 8:30am and 6:45pm Tuesday, 8:30am and 5:45pm on Wednesday and Thursday, 8:30am and 6:30pm Friday, 8:30am and 4:00pm Saturday and 10:00am and 4:00pm Sunday or viewed at <https://www.midsuffolk.gov.uk/public-rights-of-way>

The order came into force on the date of confirmation but if a person aggrieved by the order wants to question its validity, or that of any provision contained in it, on the ground that it is not within the powers of the Highways Act 1980, as amended, or on the ground that any requirement of the Act, as amended, or of any regulation made under the Act has not been complied with in relation to the order he or she may, under paragraph 2 of Schedule 2 to the Act as applied by paragraph 5 of Schedule 6 to the Act, within six weeks from 29 January 2026, make an application to the High Court.

N Christo  
Head of Public Realm and Parking Services  
Mid Suffolk District Council  
Endeavour House  
8 Russell Road  
Ipswich  
IP1 2BX

Dated: 29 January 2026