

NOTICE OF CONFIRMATION OF PUBLIC PATH ORDER

HIGHWAYS ACT 1980

EAST SUFFOLK COUNCIL (WENHASTON FOOTPATH 1 (PART) AND FOOTPATH 25 (PART)) PUBLIC PATH DIVERSION ORDER 2025

On 17 September 2025 East Suffolk Council confirmed the above order made under Section 119 of the Highways Act 1980.

The effect of the order as confirmed is to divert the entire width of that part of Wenhaston Public Footpath 1 commencing at Ordnance Survey grid reference (OSGR) TM41427501 and proceeding in a north easterly direction from Bartholomew's Lane immediately south of the poultry houses and then across an agricultural field for approximately 344 metres to OSGR TM41757511 and continuing in a north easterly direction across an agricultural field for approximately 115 metres to OSGR TM41867514, to a new line running from OSGR TM41467494 approximately 79 metres south from the aforementioned OSGR TM41427501 on Bartholomew's Lane in a easterly direction for approximately 5 metres across a 2 metre wide culvert adjacent to a field gate to OSGR TM41477494 then in a south easterly direction following the eastern side of the field edge boundary for approximately 32 metres to OSGR TM41487491 then in a north easterly direction following the northern side of the field edge boundary for approximately 184 metres to OSGR TM41667497 where it crosses an existing field boundary then continues in a north easterly direction following the northern side of the field edge boundary for approximately 131 metres to OSGR TM41787500 then in a southerly direction following the eastern side of the field edge boundary for approximately 57 metres to OSGR TM41797495 then in a generally easterly direction following the northern side of the field edge boundary for a final distance of approximately 98 metres to OSGR TM41887496; and to divert the entire width of that part of Wenhaston Public Footpath 25 commencing at OSGR TM41757511 and proceeding in a generally south easterly direction across an agricultural field for approximately 218 metres to OSGR TM41887496, to a new line running from OSGR TM41867514 and proceeding in a southerly direction across an agricultural field for approximately 178 metres to the OSGR TM41887496 as shown on the order map.

A copy of the order and the order map and explanatory statement have been placed and may be seen free of charge at Halesworth Library, Bridge Street, Halesworth, IP19 8AD between the hours of 09:00 and 13:00 Monday, 09:00 and 17:00 Tuesday, 09:00 and 17:00 Wednesday, 09:00 and 17:00 Friday, 09:00 and 17:00 Saturday, and 10:00 and 15:00 Sunday. Copies of the confirmed order and map can be requested from the East Suffolk Council Rights of Way Delivery Officer email: publicpathorders@eastsoffolk.gov.uk or by telephoning 01394 444508. They can also be viewed online at <http://www.eastsuffolk.gov.uk/environment/rights-of-way/>.

The order comes into force on 17 October 2025 but if a person aggrieved by the order wants to question its validity, or that of any provision contained in it, on the ground that it is not within the powers of the Highways Act 1980, as amended, or on the ground that any requirement of the Act, as amended, or of any regulation made under the Act has not been complied with in relation to the order he or she may, under paragraph 2 of Schedule 2 to the Act as applied by paragraph 5 of Schedule 6 to the Act, within six weeks from 26 September 2025 make an application to the High Court.

Dated: 26 September 2025

C Bally
Chief Executive
East Suffolk Council

EAST SUFFOLK COUNCIL

PUBLIC PATH DIVERSION ORDER 2025

WENHASTON FOOTPATH 1(PART) AND FOOTPATH 25(PART)

This order is made by East Suffolk Council ("the authority") under section 119 of the Highways Act 1980 ("the 1980 Act") because it appears to the authority that in the interest of the owner of the land crossed by the footpaths described in paragraph 1 of the order it is expedient that the lines of the footpaths should be diverted.

Mr D Parker has agreed to defray any compensation which becomes payable in consequence of the coming into force of the order, and any expenses which are incurred in bringing the new site of the footpath into a fit condition for use by the public.

Suffolk County Council has been consulted as required by section 120(2) of the 1980 Act and has consented to the making of the order.

BY THIS ORDER:

1. The public rights of way over the land situated at Wenhaston and shown by a bold continuous lines on the map contained in this order and on the Definitive Map and described in part 1 of the schedule to this order shall be stopped up with effect from the date on which Suffolk County Council certifies that the work to bring the new site of the footpath described in paragraph 2 of this order into a fit condition for use by the public has been carried out. Certification shall not take place prior to the creation of the new routes described in paragraph 2 of this order.
2. There shall at the end of 30 days from the date of confirmation of this order be public footpaths over the land situated at Wenhaston described in part 2 of the schedule and shown by a bold broken lines on the map contained in this order.

GIVEN under the common seal of East Suffolk Council this 4th day
of July 2025

THE COMMON SEAL OF)
EAST SUFFOLK COUNCIL)
was hereunto affixed in the presence of:)

PC MARTIN CANNON
LICKWILL PARADE AND
POWELL ROAD CANTON

Authorised Officer

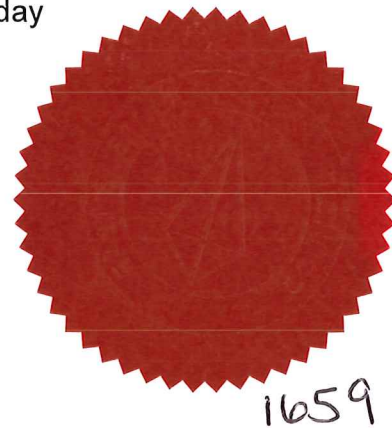

The foregoing Order is hereby confirmed by East Suffolk Council
as an unopposed Order
THE COMMON SEAL of EAST SUFFOLK COUNCIL
was hereunto affixed this 17th day of September 2025

PC MARTIN CANNON

Authorised Officer

LICKWILL PARADE AND
POWELL ROAD CANTON

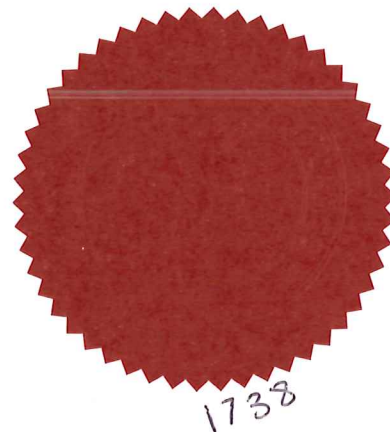

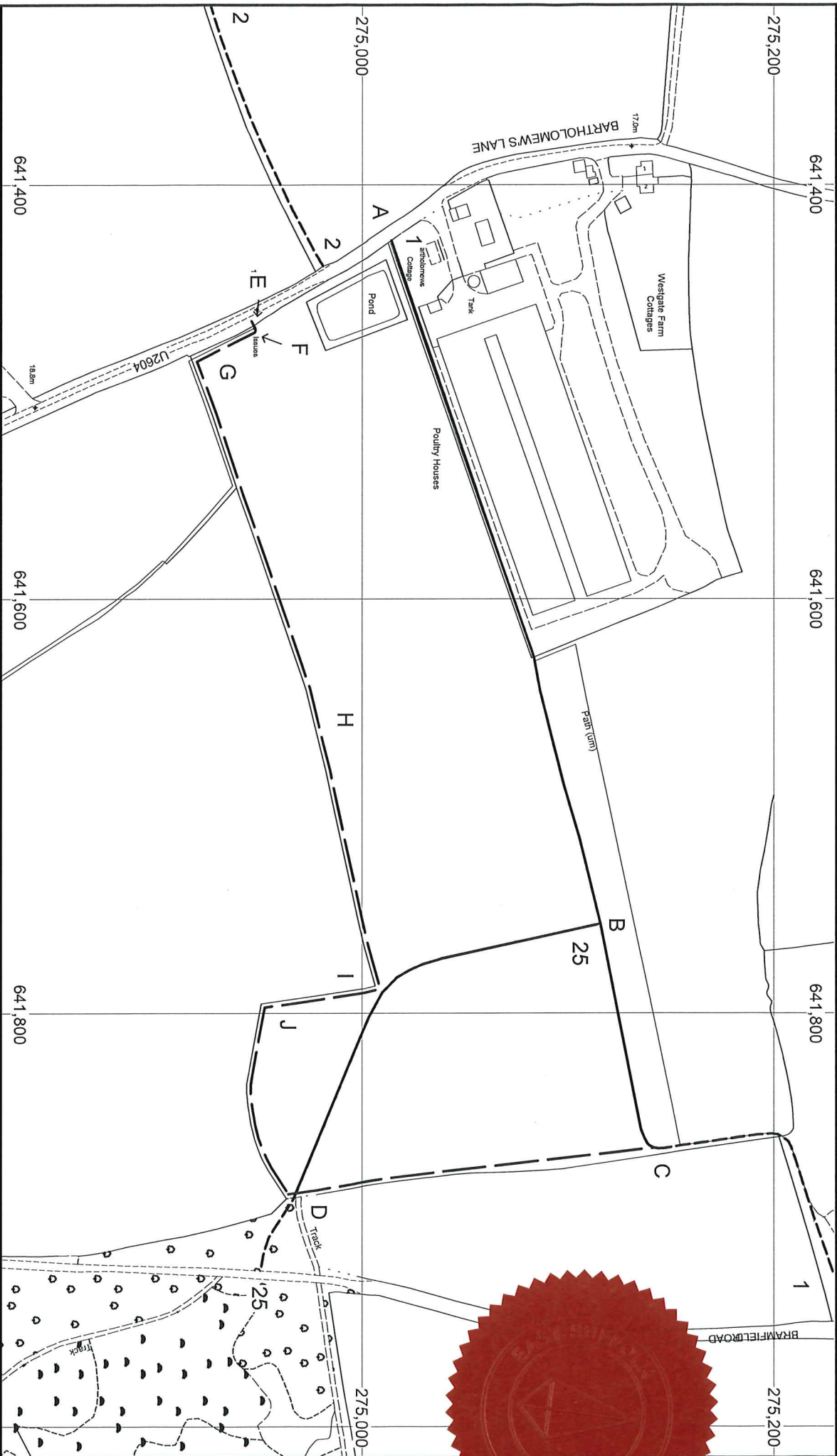

- Footpath to be diverted (A-B-C) (B-D)
- - - Proposed Footpath (E-F-G-H-I-J-D) (C-D)
- Unaffected footpath



Scale: 1:2,500 at A4

EAST SUFFOLK COUNCIL
PUBLIC PATH DIVERSION ORDER 2025
WENHASTON FOOTPATH 1(PART) AND
WENHASTON FOOTPATH 25(PART)



DRAWN BY: LH

DATE: 13/05/2025

File reference: 2025-05-13 Final Order Map

Ordinance Survey MasterMap, Crown Copyright. All rights reserved.
 Suffolk County Council Licence No. AC0000859563 2025

1059
 LC

SCHEDULE

Part 1

Description of Site of Existing Path

Wenhaston Public Footpath 1 (part) – The entire width of that part of Wenhaston Public Footpath 1 commencing at point A at Ordnance Survey grid reference TM41427501 and proceeding in a north easterly direction from Bartholomew's Lane immediately south of the poultry houses and then across an agricultural field for approximately 344 metres to point B at Ordnance Survey grid reference TM41757511 and continuing in a north easterly direction across an agricultural field for approximately 115 metres to point C at Ordnance Survey grid reference TM41867514; this being the route shown between points A – B – C on the order map.

Wenhaston Public Footpath 25 (part) – The entire width of that part of Wenhaston Public Footpath 25 commencing at the aforementioned point B and proceeding in a generally south easterly direction across an agricultural field for approximately 218 metres to point D at Ordnance Survey grid reference TM41887496; this being the route shown between points B – D on the order map.

Part 2

Description of Site of New Path

Wenhaston Public Footpath 1 (part) – Commencing at point E at Ordnance Survey grid reference TM41467494 approximately 79 metres south from the aforementioned point A on Bartholomew's Lane in a easterly direction for approximately 5 metres across a 2 metre wide culvert adjacent to a field gate to point F at Ordnance Survey grid reference TM41477494 then in a south easterly direction following the eastern side of the field edge boundary for approximately 32 metres to point G at Ordnance Survey grid reference TM41487491 then in a north easterly direction following the northern side of the field edge boundary for approximately 184 metres to point H at Ordnance Survey grid reference TM41667497 where it crosses an existing field boundary then continues in a north easterly direction following the northern side of the field edge boundary for approximately 131 metres to point I at Ordnance Survey grid reference TM41787500 then in a southerly direction following the eastern side of the field edge boundary for approximately 57 metres to point J at Ordnance Survey grid reference TM41797495 then in a generally easterly direction following the northern

side of the field edge boundary for a final distance of approximately 98 metres to the aforementioned point D; this being the route shown between points E – F – G – H – I – J on the order map.

Width: 2 metres

Wenhaston Public Footpath 25 (part) – Commencing at the aforementioned point C and proceeding in a southerly direction across an agricultural field for approximately 178 metres to the aforementioned point D; this being the route shown between points C – D.

Width: 2 metres