

Environmental Information Regulations – Response - 27461

Please treat this as a request under the Environmental Information Regulations 2004 and/or the Freedom of Information Act 2000.

Please provide the recorded information held by Suffolk County Council relating to the entry of U8220 on the List of Streets/highways maintainable at public expense.

In particular, please provide:

1. The date U8220 was first entered onto the List of Streets or equivalent highway record.

Unknown (Suffolk County Council's reliance has been on inherited records showing it as a highway so we can only provide those records, although these do not tell us when it first became a highway – see items 1-5).

2. The source document, record, schedule, map or decision relied upon when U8220 was first entered.

Our reliance has been on inherited records showing it as a highway so we can only provide those records, although these do not tell us when it first became a highway – see items 1 – 5.

3. Any historic List of Streets entries for U8220, including previous descriptions, route names, lengths, widths, extents or classifications.

See items 3,5 and 6.

4. Any plan or map showing the precise alignment and extent of U8220 as recorded by SCC.

See items 1, 4, 7, 8, 9, 10. With regard to 8 - The extent of the highway maintainable at public expense is considered by Suffolk County Council to be as shown in green on item 8, according to our current records and based on past investigations and established principles of highway law.

Advisory Note – Please note that: Although all reasonable care has been taken in the preparation of this plan, this document does not constitute a warranty or guarantee as to the accuracy of the information therein. Due to the limitations of Ordnance Survey base mapping, points measured from this map may not match measurements between the same points on the ground.)

5. Any record showing the width or maintainable extent of U8220.

As question 4 above.

6. Any record explaining when and why the route was identified as highway maintainable at public expense.

Our reliance has been on inherited records showing it as a highway so we can only provide those records, although these do not tell us when it first became a highway – see items 1-5).

7. Any record showing whether U8220 was added, amended, extended, renamed, digitised, mapped, or otherwise altered during or after the creation of the Quiet Lanes network in or around 2019.

N/A as it wasn't any of those things in relation to the Quiet Lanes network project.

8. Any internal emails, notes, GIS records, asset records or highway records relied upon by SCC in asserting that the route adjacent to Cuckoo Tye Farm House forms part of U8220.

Our reliance has been on inherited records showing it as a highway so we can only provide those records – see items 1-5.

Redacted Information

All information released in response to a Freedom of Information Act 2000 (FOIA) or Environmental Information Regulation 2004 (EIR) request is deemed to be in the public domain. As such we must consider whether or not the requested information qualifies as personal information and should therefore not be released into the public domain.

The council has determined that this is personal information and is therefore exempt from disclosure under **section 40** of the FOIA and **regulation 13** of the EIR.

The Council considered the following, including the possible consequences of disclosure for the data subjects concerned and their reasonable expectations as to the use of their data:

- expectations of the individuals concerned about personal information being put into the public domain;
- reasonable expectations - the data subjects concerned would have a legitimate expectation of privacy concerning their personal information and would not have anticipated this being put into the public domain;
- whether or not the requested information could be anonymised; and
- balancing the individual's rights and the legitimate interests - In past cases the Information Commissioner has weighed the individual's rights to privacy against the public interest in disclosure. There is no presumption in favour of releasing personal data.

This is an absolute exemption, which means that if the condition is satisfied there is no additional public interest test to consider.

In assessing fairness, the Council considered the likely consequences of disclosure of the requested information. Personal information should not be used in ways that have unjustified adverse effects on the individuals concerned. The council also considered whether such disclosure would be within the reasonable expectations of the individuals, given that any response to a request under the FOIA or EIR is deemed to be in the public domain. The council believes that in this instance it is not fair to disclose personal data and is therefore withholding the requested information under section 40 of the FOIA and regulation 13 of the EIR.

TANSTEAD STREET

BRIDGE STREET

A134

BIO71

BIO86

LONG MELFORD

C47

C48

C47

C49

C48

ACTON

BIO71

BII15

A134

ACTON

266

64

266

266

C49

228

GRE WALDI

265

C48

C25

228

228

A134

228

BII15

CHILTON

228

WEST SUFFOLK COUNTY COUNCIL

Schedule of County Roads

South-Eastern Division

Road No.	Name of road	From	To	Length Miles
B1508 A.133	Sudbury-Bures	Sudbury Borough Boundary	Bures Bridge	4.88
A.134	Bury-Sudbury-Nayland	Junction B.1070	Sudbury Borough Boundary	8.90
A.134	Bury-Sudbury-Nayland	Sudbury Borough Boundary	Nayland Bridge	8.57
A.1071	Sudbury-Hadleigh	Junction with A.134 nr. Newton	Hadleigh Boundary	5.53
A.1092	Melford-Haverhill	Junctions with A.134	West end of Westgate St. Long Melford	0.36 <u>28.74</u>
B.1064	Melford-Cavendish	Rodbridge Road		0.22
B.1068	Leavenheath-Higham	Vince's Farm Corner	Higham County Bridge	5.63
A1141 B.1070	Bury-Lavenham-Hadleigh	Junction with A.134 nr. Cross Green	County Boundary at Masons Bridge	13.97
B.1071	Lavenham-Sudbury	'Swan Inn' Lavenham	Holbrook Hall	3.03
B.1078	Bildeston-Needham Market	Junction with B.1115 at Bildeston House	County Boundary near Doe's Farm	2.72
B.1087	Nayland-Stoke-by-Nayland	Church St. Nayland	'Angel' Hill, Stoke	1.63
B.1115	Sudbury-Stowmarket	Sudbury Borough Boundary	County Boundary	12.42
F.1115	Bildeston-Hadleigh	Bildeston Corner	Junction with B.1070 at Cherry Hill	2.34 <u>41.96</u>
C.25	Gt. Waldingfield-Aldham	Junction with B.1115 (excluding portion in Hadleigh)	Junction with C.55 north of Red Hill	7.69
C.44	Cockfield-Rattlesden	Junction with B.1070	Cockfield Green	1.60
^{C.45} C.47	Long Melford-Lavenham	Junction with A.134 at Bull Inn	Junction B.1071	3.71
C.48	Sudbury-Acton-Lavenham	Sudbury Borough Boundary	Junction B.1071 at Washmere Green	3.70
C.49	Acton-Waldingfield	Junction C.47 at Gravel Pit	Junction B.1115 near Babergh Place	2.02
C.50	Acton-Waldingfield	Junction C.49	Junction B.1115 near the Heath	0.47
C.45	Cockfield-Hitcham	Junction with C.44 at Cockfield Stone	Junction with B.1115	5.42 20 61 62 46 87 07

SE

Road No.	Name of road	From	To	Length Miles
C.52	Gt. Waldingfield-Newton	Junction with B.1115	Junction with A.134	1.18
C.53	Brent Eleigh-Leavenheath	Junction with B.1070	Junction with B.1068	6.52
C.54	Bures-Nayland	Junction with A.133	Junction with A.134	4.15
C.55	Hadleigh-Aldham-Elmsett	Hadleigh U.D. Boundary at Red Hill	County Boundary	2.80
C.60	Bridge Street-Lavenham	Junction A.134	Junction B.1071	2.26
C.61	Brent Eleigh-Hitcham	Junction with B.1070	Junction with C.45 at Hitcham Street	3.63
C.62	Boxford-Stoke-by-Nayland	Junction with A.1071 at Watson's Corner	Junction with B.1068 near Well House	2.55
C.63	Polstead-Shelley	Junction with C.62	County Boundary	1.02
C.64	Layham	Continuation of C.63 to Shelley		0.40
C.65	Bures-Assington	Junction with A.133	Junction with A.134	3.85
C.66	Hitcham-Rattlesden	Junction with C.45	County Boundary	1.79
C.67	Hadleigh-Whatfield-Naughton	Junction with C.25 at Hadleigh Bdy.	Junction with B.1078	3.80
C.68	Boxford-Kersey	Junction with A.1071	Junction with B.1070	3.93
C.69	Kersey Street	Junction with C.25	Junction with C.68	0.36
C.87	Lavenham-Rattlesden	Junction B.1070 at Lavenham Common	Junction C.45 near Poplars Farm, Brettenham	3.74
C.87	Lavenham-Rattlesden	Junction C.45 at Brettenham Park Gates	R.D. Bdy. west of Fen Farm	1.69
C.88	Preston-Brent Eleigh	Junction C.87 at Mill Corner	Junction C.61 south of Colliers Farm	1.38
C.89	Windsor Green Road, Cockfield	Junction with A.134	Junction with B.1070	0.38 ^{0.60}
C.90	Lt. Waldingfield-Boxford	Junction with B.1115 at Waldingfield Church	Junction with C.53 near Boxford	4.01
C.91	Edwardstone-Chelsworth	Junction with C.90 near Willow Farm	Junction with B.1115 at Chelsworth	4.82
C.92	Hadleigh-Layham-Polstead	Hadleigh U.D. Boundary	Junction with C.64 at County Boundary	2.11
C.97	Bildeston-Wattisham-Finborough	Junction with B.1115 in Bildeston	via Wattisham to B.1115 at Luckey's Farm	4.06
C.98	Camard-Newton	Junction A.133 near Cornard Mill	Junction A.134 near the Elms	1.75 1.46
U.192	Cockfield	Roads to the Church, Palmer's Green and Colchester Green.		0.81

Road No.	Name of road	From	To	Length Miles
U.196	Cockfield	Oldhall Green Road	-	0.47
U.197	Smithwood Green Road	Junction B.1070 near Cleft Bush Farm and Knights Hill (incl. Knights Hill Road to Railway Br.)	Junction with L.134 at Thern Court and Elms Farm <i>4 Old Windsor Lane</i>	2.81 2.73
U.199	Hill Green-Thorpe Morieux	Junction with B.1070 at Hill Green (including branch to Down Hall and loop near Rushbrooke Farm)	Junction with C.45 at Thorpe Church	3.46
U.200	Hill Green-Preston	Junction with U.199 nr. Water Run Bridge (with branch to Moneyhole Corner and road to Hillhouse Farm)	Junction with U.198 at Mortimer's Farm	2.61
U.201	Cockfield-Thorpe	Junction with C.44 near Cockfield Stn. (inc. Earl's Hall Road and Knights Hall Road)	Junction with U.199 at Thorpe Farm	2.89
	Cockfield-Thorpe	Junction with above at Bullswood Lane	Junction with U.199 at Hill Farm	0.91
U.202	Felsham-Thorpe	R.D. Bdy. north of Home Farm (including link between Home Farm and Reads Farm and road to Thorpe School)	Junction with C.45 near Thorpe Church	1.94
U.203	Felsham-Brettenham	R.D. Bdy. south of Castle Farm	Junction U.198 ^{C.87} near Rose's Farm, with branch to U.204 C.87.	2.17
U.206	Lavenham	Clay Hill Road, Frogs Hall Road and Streets East of Lavenham High Street		3.17
U.209	Lavenham	Hall Road, Park Road and Scars Lane		1.83
U.210	Preston	Whelp Street to Swifts Farm and roads to Kettlebaston Rectory and Preston Church		1.28
U.211	Kettlebaston	Junction with C.61 at The School	Parish Boundary	1.04
U.214	Brettenham-Cross Green	Junction with C.87 at the Church	Junctions with B.1115 at Cross Green and C.66 at County Boundary (including roads to The Hobbets, Loose Hall, Bloxhall and Castlehill Farm)	2.72
U.215	Brent Eleigh-Monks Eleigh	Junction with C.61 north of Brent Eleigh Rectory (including Cock Lane, Brent Eleigh)	Junctions with B.1070 at Scripscross Bridge and Monks Eleigh Church	2.77
U.215	Kettlebaston-Monks Eleigh	Junction with C.61 at Swift's Farm	Junction with B.1070 at Lion Bridge	1.56
	Kettlebaston-Monks Eleigh	Junction with C.61 near Kettlebaston Church	Junction with U.215 near Manor Farm	1.38
U.218	Hitcham-Brettenham	Junction with C.97 near Lodge Farm	County Boundary near Eastwood Farm	0.95

~~33.77~~
33.93

Road No.	Name of Road	From	To	Length Miles
U.218	Wattisham	Ware Road, Smithy Road and Needham Lane		1.49
U.219	Bildeston	Bildeston Street west of B.1115		1.18
U.220	Hitcham-Wattisham	Junction with B.1115 near Hitcham Church (including roads to Hitcham Church and Rectory)	Junction with C.97 at Wattisham Stone	1.60
U.221	Nedging-Nedging Tye	Junction with B.1115 near Nedging Cross	Junction with B.1078 at Nedging Tye	1.92
U.222	Semer-Ash Street	Junction with B.1115, near Semer Bridge	Junction with U.225 at Ash Street	0.60
U.223	Kersey-Whatfield-Elmsett	Junctions with U.225 at Cherry Hill (including roads to Hill Farm and Gate Farm)	County Boundary at Rhodd's Farm	4.56
U.224	Whatfield-Elmsett	Junction with C.67 near Church Farm	Junction with U.223 at Laurel Cottage	2.16
	Whatfield-Elmsett	Junction with U.223 at Laurel Cottage (including Hall Farm Road)	County Boundary at Hole in the Wall	0.78
U.225	Semer-Ash Street-Naughton	Junction with B.1070 at the Workhouse	Junction B.1078 near Coopers Farm	2.86
	Semer-Ash Street-Naughton	Junction with above at The Crouch (including roads to Aldham Rectory, Whatfield Hall and Wallers Lane, Nedging)	Whatfield School	1.21 1.21
U.226	Aldham-Elmsett	Junctions with C.55 at Firtree and Elmsett Gate Farms (including roads to Aldham Hall, Aldham Priory and Wolves Wood Lane)	Junctions with U.223 in Elmsett	1.72
U.228	Boxford-Gt. Waldingfield	Junction with B.1115, near The Heath (including roads to the Rectory, Brook House, the Garrison and Hole Farm)	High Wood	2.88
U.230	Edwardstone-Waldingfield	Junctions with C.90 at Lynns Hall (with branches to Rural District Boundary)	Junction with C.25 at the Grove	1.10
	Edwardstone-Waldingfield	Junction with C.25 at Round Maple	Junctions with C.90 at The School and with C.91 at Mill Green	1.21
U.231	Milden-Monks Eleigh	Junction with C.53 at Milden School (including roads to Pound Farm, Slough Farm and Monks Eleigh Mill)	Junctions with B.1070 at Foyster's Hall and with B.1115 at Scripscross Bridge	2.57
U.233	Monks Eleigh-Lindsey	Junction with B.1070 at Foyster's Hall	Junctions with C.91 at Lindsey Tye (both branches) and loop to C.25 near Lindsey Hall and School	2.41
	Monks Eleigh-Lindsey	Junction with above	Stackyard Green	1.14
				31.59

Road No.	Name of Road	From	To	Length Miles
U.235	Chelsworth Common Rd.	Parsonage Lane, Cakebridge Lane, and Lane near the School, at Common Rd.		1.23 1.29
U.236	Lindsey Tye-Semer-Kersey	Junction with U.234 ^{C.91} at Lindsey Tye	Common Farm Corner	1.25
	Lindsey Tye-Semer-Kersey	Junction with B.1115 near Cherry Hill	Junction with C.25 at The Row, Kersey	1.06
	Lindsey Tye-Semer-Kersey	Junction with B.1115 near Semer Bridge (including road to Semer Church)	Junction with Section 1 at Drakestone Green	1.06
U.237	Kersey	Streets in Kersey, and roads to Oaks Tye, Kersey Vale and Kersey Farm		1.35
U.238	Groton-Kersey	Junction with C.53, near The Smithy, Groton (including branch to C.53 at Parliament Heath road past Groton Place and road to Bridges Farm)	Junctions with C.68 near Kersey Upland and Williams Green	4.51
U.239	Boxford-Castlings Heath	Junction with A.1071 in Boxford Street	Junction with U.238 at Manor Farm with branch to Groton Hall	2.06
U.240	Kersey-Polstead	Junctions with C.68 at Kersey Upland and Williams Green (including Culphs Lane and Road to Bower House)	Junction with A.1071 near Bower House Tye	1.88
U.241	Boxford-Assington	Junction with A.1071 at Calais Street (including Avely Hall Road)	Junction with A.134 near Assington Vicarage	2.96
U.242	Boxford-Stoke-by-Nayland	Junction with A.1071 at Calais Street (including Calves Lane and Mill Lane and roads to White Street Green and Tills Farm)	Junction with B.1068 at The Howe	3.47 3.24
U.243	Polstead-Hadleigh Heath	Junction with C.62 at Bells Corner (with branch to County Boundary)	Junction with A.1071 at Hadleigh Heath	3.01
	Polstead-Hadleigh Heath	Junction with C.63 at Polstead Heath Polstead Green (including Polstead Streets)		1.26
	Polstead-Hadleigh Heath	Watson's Farm	Junction with Section 1 at 'Shoulder of Mutton' Inn and branch to Evan's Heath	1.11
U.244	Layham-Sholley	Junction with B.1070 (both branches)	County Boundary at Sholley House Farm	1.51
U.246	Layham-Hadleigh Heath	Junction with U.244 at Layham Church	Junction with U.243 near Hadleigh Heath and branch to U.D. boundary	2.73
U.247	Layham-Rands Farm	Junction with U.246 near Overbury Hall	Beyond Rands Farm	1.34

~~33.01~~
72.82

Road No.	Name of Road	From	To	Length Miles
U.248	Layham-Popes Green	Junction with U.246 (including loop via Wyncolls Farm and branch to Overbury Hall)	Popes Green Farm	2.50
U.250	Alpheton Church Road			0.62
U.260	Long Melford	Liston Lane, St. Catherine's Road, Back Lane and other lanes in Long Melford		1.34
U.264	Acton	Link between C.47 and C.48 and roads to Slough Farm		0.54 0.34
U.265	Rodbridge-Waldingfield	Junction with A.134 at Rodbridge Corner	Junction with C.48	1.65
U.266	Long Melford-Acton	Junction with A.134 at Melford Place	Junction with C.49 at Bawergh Heath	2.40
	Long Melford-Acton	Junction with C.47 at Bull Lane Farm (including road to Clay Hall)	Junction with U.265 at Newman's Green	1.53
U.267	Stoke-by-Nayland-Hadleigh	Junction with B.1068 at Stoke	Junction with U.243 near Red Barn Cottages	1.45
U.268	Polstead-Higham	Junction with U.267 near Withernmarsh Green	Junction with B.1068 at Wasses Farm	2.51
	Polstead-Higham	Junction with Sec.1 at Giffords Hall Lodge	Junction with B.1068 at Nether Hall Farm	1.22
	Polstead-Higham	Junction with Sec.1 at Green Farm	Junctions with B.1068 at Thorington Street (Both branches)	1.28
U.269	Stoke-by-Nayland	Boxted Mill and Langham Mill Roads		1.42
U.270	Nayland-Polstead	Junction with B.1087 at Nayland	Junction with B.1068 (both branches) and including Back Streets, Nayland and Stoke	2.55
U.271	Leavenheath-Polstead	Junction with A.134 at 'Plough' Inn	Junctions with B.1068, near Reverends Farm and Little Howe, with road to Doctors Farm	2.36
	Leavenheath-Polstead	Junction with A.134 at 'Hare and Hounds' P.H.	Junction with B.1068	0.81
U.273	Bures	Hollow Lane and Deadman's Lane and road to Bures Hall		0.93
U.274	Assington-Wormingford	Junction with C.65 near Rose Green	County Boundary at Wormingford Bridge	2.93
U.275	Assington-Leavenheath	Junction with C.65 near Pump Farm	Junctions with A.134 near Assington House and near 'Plough' Inn (including roads to two farms)	2.47 <u>3.38</u>

Road No.	Name of Road	From	To	Length Miles
U.276	Honey Tye-Wissington	Junction with A.134 at Honey Tye	Wissington Hall	1.35 /
	Honey Tye-Wissington	Junction with A.134 near Honey Tye (including road to Farthing Hall)	Junction with C.54 at the 'Fox' Inn	1.97
U.277	Assington-Little Cornard	Junction with C.65 at Dorking Tye	Junction with A.133 near Cornard School	2.09
	Assington-Little Cornard	Junction with Sec.1 at Workhouse Green (including road to Peacock Hall)	Junctions with A.133 at Malting Farm and Brickworks	2.15
U.278	Cornards-Newton	Junction with C.98 at Cornard Tye (including part of road to Newton Green)	Junctions with A.133, near Stone Farm	3.55
	Cornards-Newton	Junction with Sec.1 near Prospect House	Great Cornard School with branch to A.133 near 'Brook' Inn	1.40
	Cornards-Newton	Pot Kiln Road (^{and} both ends), Lane and road to Corn Mill	Broom Street, Cat's	1.49
U.279	Newton	Church Road, Rectory Road, Park Farm Road, Siam Hall Road and Roger's Farm Road		2.77
U.281	Little Waldingfield-Washmere Green	Junction with B.1115 near Camps Wood	Junction with B.1071 at Washmere Green	1.35

~~18.12~~
~~17.12~~
~~30.38~~ x
~~32.12~~ x
~~31.39~~ x
~~33.93~~ x
~~0.51~~ x
~~147.60~~
 146.75

2300m x 5
 1760 80.914

THE PARISH OF MELFORD.

NAMES OF ROADS.	DESCRIPTION.	DISTANCE.				TOTALS.			
		Miles.	Furlongs	Chains.	Links.	Miles.	Furlongs	Chains.	Links.
A-A	Hadleigh and Melford Road.	From Melford street corner of Bull Inn to Back lane	0	0	1	50			
		Back lane to Kings lane	0	4	6	50			
		Kings lane to Acton boundary	0	0	4	30	0	5	2
B-B	Kings Lane.....	From Hadleigh and Melford road to Acton boundary	0	0	0	90			
		Part of Kings lane divided with Acton—6674	0	3	3	37	0	3	4
C-C	Back Lane	From Hadleigh and Melford road to end of Cottages	0	0	6	0	0	0	6
D-D	Hooping Lane.....	From Melford street to Stream	0	0	6	25	0	0	6
E-E	Liston Hall Road ...	From gate near Melford street to Liston Hall Bridge	0	1	7	94	0	1	7
F-F	Borley Road	From Turnpike road near gate to centre of Bridge							
		Borley boundary	0	1	8	50	0	1	8
G-G	Potters Tye Road ...	From Sudbury and Bury Turnpike road to Gull road	0	7	7	80			
		Gull road to Acton boundary	0	1	8	14	1	1	5
H-H	Gull Road	From Potters Tye road to post	0	2	0	10	0	2	0
J-J	Highfield Green Road	From Sudbury and Bury Turnpike road to Acton							
	and Water Lane.	boundary Kings lane	1	1	8	35	1	1	8
K-K	Glemsford and Clare	From Sudbury and Bury Turnpike road to road on							
	Road.	Melford green	0	0	6	85			
		Road on Melford green to Stanstead road ...	0	4	4	0			
		Stanstead road to County Bridge Glemsford							
		boundary	0	6	7	80	1	3	8
L-L	Stanstead Road	From Glemsford and Clare road to Parsonage road..							
		Parsonage road to post Stanstead boundary...	0	5	2	0	1	0	2
A-M	Parsonage Road	From Stanstead road to Parsonage Farm gate ...	0	1	1	10	0	1	1
N-N	Road on Melford Gn.	From Sudbury and Bury Turnpike road near School							
		to Glemsford and Clare road	0	1	8	86	0	1	8
P-P	Church Roads.....	From Glemsford and Clare road to Churchyard gate	0	0	6	87			
		Turnpike road to Upper Churchyard gate ...	0	0	6	0	0	1	2
Q-Q	Road over Melford	From Glemsford and Clare road to Sudbury and							
	Green.	Bury Turnpike road	0	0	9	70	0	0	9
R-R	Slough Farm Road or	From Sudbury and Bury Turnpike road to Lavenham							
	New Road.	boundary	1	1	8	84	1	1	8
		Total.....	8	6	1
TURNPIKE ROAD.									
S-S	Sudbury and Bury	From Sudbury boundary to Borley road and Potters							
	Turnpike Road.	Tye road	0	4	5	5			
		Potters Tye road to Water lane	0	5	3	80			
		Water lane to Liston Hall lane	0	2	0	25			
		Liston Hall lane to Cock and Bell lane ...	0	1	9	60			
		Cock and Bell lane to Hooping lane	0	1	3	75			
		Hooping lane to road on Melford green begin-							
		ning near School	0	1	5	0			
		Melford Green road to Heaven lane	0	0	0	60			
		Heaven lane to Glemsford and Clare road ...	0	1	3	0			
		Glemsford and Clare road to road top of green	0	1	2	35			
		Road top of green to Upper Church road ...	0	0	0	95			
		Upper Church road to Primrose Hill spring...	1	3	8	50			
		Carried forward.....	3	7	2

THE PARISH OF MELFORD, (CONTINUED.)

TOTALS.	NAMES OF ROADS.	DESCRIPTION.	DISTANCE.				TOTALS.			
			Miles.	Furlongs	Chains.	Links.	Miles.	Furlongs	Chains.	Links.
		Brought forward.....			3	7	2	85
5.2.30	Do.	Primrose Hill spring to Barrow lane—1440...								
3.4.27	Divided with Alpheton Parish.	Barrow lane to Lavenham lane (new road)								
0.6.0		—1000								
0.6.25		Lavenham lane (new road) to centre of Bridge								
1.7.94		—1620.								
		Divided with Alpheton—4060...	0	2	0	30	0	2	0	30
1.8	T-T Part Liston Hall Lane	From Sudbury and Bury Turnpike road to gate ...	0	0	2	70	0	0	2	70
		Total Turnpike.....			4	1	5	85
		GREEN ROADS.								
1.5.94	U-U Back Lane	From Cottages in lane to Water lane	0	4	8	75	0	4	8	75
2.0.10	V-V Green Lane.....	From Highfield green to Potters Tye	0	3	0	15	0	3	0	15
1.8.35	W-W Cock and Bell Lane..	From Sudbury and Bury Turnpike road to gate end of lane	0	0	5	85	0	0	5	85
	X-X Hooping Lane.....	From Sudbury and Bury Turnpike road to Crossways (Heaven lane)	0	1	9	50				
		Crossways (Heaven lane) to Glemsford and Clare road	0	2	9	95	0	4	9	45
3.8.65	Y-Y Heaven Lane	From road on green near School to Crossways (Hooping lane)	0	1	9	70	0	1	9	70
0.2.0	Z-Z Bully Moore's Lane...	From Crossways (Hooping lane) to Cranfield barn...	0	6	5	30	0	6	5	30
1.1.10	A-A Cranfield Barn Road.	From Cranfield Barn to Glemsford and Clare road near Burton's Farm	0	2	0	25	0	2	0	25
8.86	B-B Parsonage Road near Burton's Farm.	From Glemsford and Clare road to gate (Hard road)	0	4	0	85	0	4	0	85
2.87	C-C	From Gate Alpheton boundary to fence Lavenham boundary	0	7	8	70	0	7	8	70
9.70	D-D	Part of Shimpling lane	0	0	7	60	0	0	7	60
8		Total Green lanes...			4	4	6	60
1.67		„ Hard roads...			8	6	1	67
		„ Turnpike „...			4	1	5	85
		Total.....			17	4	4	12

Schedule of Highways Maintainable at Public Expense within Babergh District

Hint: To find a parish or street use Ctrl F

The information in this "List of Streets" was derived from Suffolk County Council's digital Local Street Gazetteer. While considerable care is taken to ensure the accuracy of the Street Gazetteer, Suffolk County Council cannot accept any responsibility for errors, omissions, or positional accuracy. There are no warranties, expressed or implied, including the warranty of merchantability or fitness for a particular purpose, accompanying this product. However, notification of any errors will be appreciated.

Street	Part public location	Length Km	NSG Ref	Route No.
Acton				
Carriageway				
Babergh Close		0.18	01500147	U8229
Barrow Hill		0.97	01500165	C712
Browns Close		0.10	01500241	U8229
Bull Lane		1.33	01510114	C711, NCR13
Canon Pugh Drive		0.50	01500278	U8229
Clay Hall Lane		0.37	01500374	U8231
Clay Hall Place		0.44	01500375	U8231
Coblers Way		0.21	01500384	U8228

Street	Part public location	Length Km	NSG Ref	Route No.
Little Waldingfield Footpath 011		0.27	01592127	Y379/011/0
Long Melford				
Carriageway				
A134 Long Melford Bypass		5.11	01511031	A134
Abbott Close	Junc With Braithwaite Road For 15 M		01512619	U8232
B1066 From A1092 To C683		0.60	01501666	B1066
Borley Road		0.37	01500195	C767
Braithwaite Road		0.40	01512618	U8232
Bridge Street		2.16	01510811	A134
Bridge Street Road		2.00	01510104	C709
Bull Lane		1.24	01500247	C711, NCR13
Chadburn Road		0.18	01500301	U8232
Church Walk		0.14	01500365	U8207
Clare Road		1.65	01510759	A1092
Clopton Drive	Junc Roman Way To Opp Rear No 3 Roman Way : Hwy Bdy Outside No 4 To Hwy Bdy At Rear No 3		01500381	U8217
Cock And Bell Lane	From Junction With B1064 To End Of Housing Where Road Bears Right		01500385	U8209
Cordell Place		0.64	01500396	NCR13, U8213
Cordell Road		0.74	01500397	U8212
Cotswold Drive		0.16	01500404	U8217
Cranmore Green		1.05	01510796	U7340
Cranmore Hill		1.07	01510801	B1066
Cuckoo Tye		0.27	01511046	U8220
Hall Street		0.84	01500584	B1064, NCR13
Harefield		0.55	01500588	U8233
High Street		1.95	01500622	A1092, B1064
Hill Close		0.04	01500633	U8232
Lakforth		0.08	01510359	U8232
Laurel Drive		0.18	01500708	U8216
Liston Lane		0.41	01500729	NCR13, U8210
Little St Marys		0.58	01500733	B1064, NCR13
Martyns Rise		0.04	01500779	U8218
Meeting Field		0.18	01510799	U8209
Middle Way		0.18	01500792	U8232
Mills Lane		1.56	01510415	U8221
New Road	From St Catherine'S Road To Just North Of Meeting Field		01510426	U8209
Old Court	Junc Opp Mill Ford House To End Of Hwy Adj Old Court House : Junc Bull Lane To Hwy Bdy Outside No 9 : Hwy Bdy Outside No 10 To Hwy Bdy Outside No 7 : Junc Bull Lane To Hwy Bdy Outside No 18 : Junc Bull Lane To Hwy Bdy Outside No 32		01500857	U8233
Olivers Close		0.52	01500862	U8214

Street	Part public location	Length Km	NSG Ref	Route No.
Long Melford Footpath 021		0.91	01590447	Y383/021/0
Long Melford Footpath 022		1.96	01590448	Y383/022/0
Long Melford Footpath 023		1.15	01590449	Y383/023/0
Long Melford Footpath 025		0.94	01590451	Y383/025/0
Long Melford Footpath 026		1.13	01590452	Y383/026/0
Long Melford Footpath 027		1.11	01590453	Y383/027/0
Long Melford Footpath 028		0.31	01590454	Y383/028/0
Long Melford Footpath 029		1.14	01590455	Y383/029/0
Long Melford Footpath 030		0.05	01590456	Y383/030/0
Long Melford Footpath 034		0.10	01590460	Y383/034/0
Long Melford Footpath 037		0.50	01591926	Y383/037/0
Long Melford Footpath 038		0.13	01590707	Y383/038/0
Long Melford Footpath 039		0.12	01590708	Y383/039/0
Long Melford Footpath 040		1.90	01592153	Y383/040/0
Long Melford Footpath 041		0.12	01592154	Y383/041/0
Long Melford Footpath 042		0.52	01592166	Y383/042/0
Green Lane				
Back Lane		0.37	01511240	U8212
Water Lane		1.55	01501227	U8220
Shared use Foot and Cycle Way				
Braithwaite Road Unassociated Footway		0.24	01581163	
Footway Between Bull Lane And Braithwaite Road		0.04	01581164	
Long Melford Boat 035		0.60	01590461	Y383/035/0
Long Melford Boat 036		1.55	01590462	Y383/036/0
Long Melford Bridleway 009		1.64	01590435	Y383/009/0
Long Melford Bridleway 014		1.44	01590440	Y383/014/0
Long Melford Bridleway 015		1.11	01590441	Y383/015/0
Long Melford Bridleway 024		1.55	01590450	Y383/024/0
Long Melford Bridleway 032		0.94	01590458	Y383/032/0
Long Melford Bridleway 033		1.41	01590459	Y383/033/0
Long Melford Restricted Byway 007		0.39	01590433	Y383/007/0
Long Melford Restricted Byway 010		1.41	01590436	Y383/010/0
Long Melford Restricted Byway 031		0.30	01590457	Y383/031/0
Shared Use Between Sampson Drive And Lakforth		0.11	01512530	F8645
Shared Use Between Shaw Road And Cordell Place		0.04	01512532	F8645, NCR13

Lower Holbrook

ORDNANCE SURVEY

LONG MELFORD CP

217

87

44'

88

45'

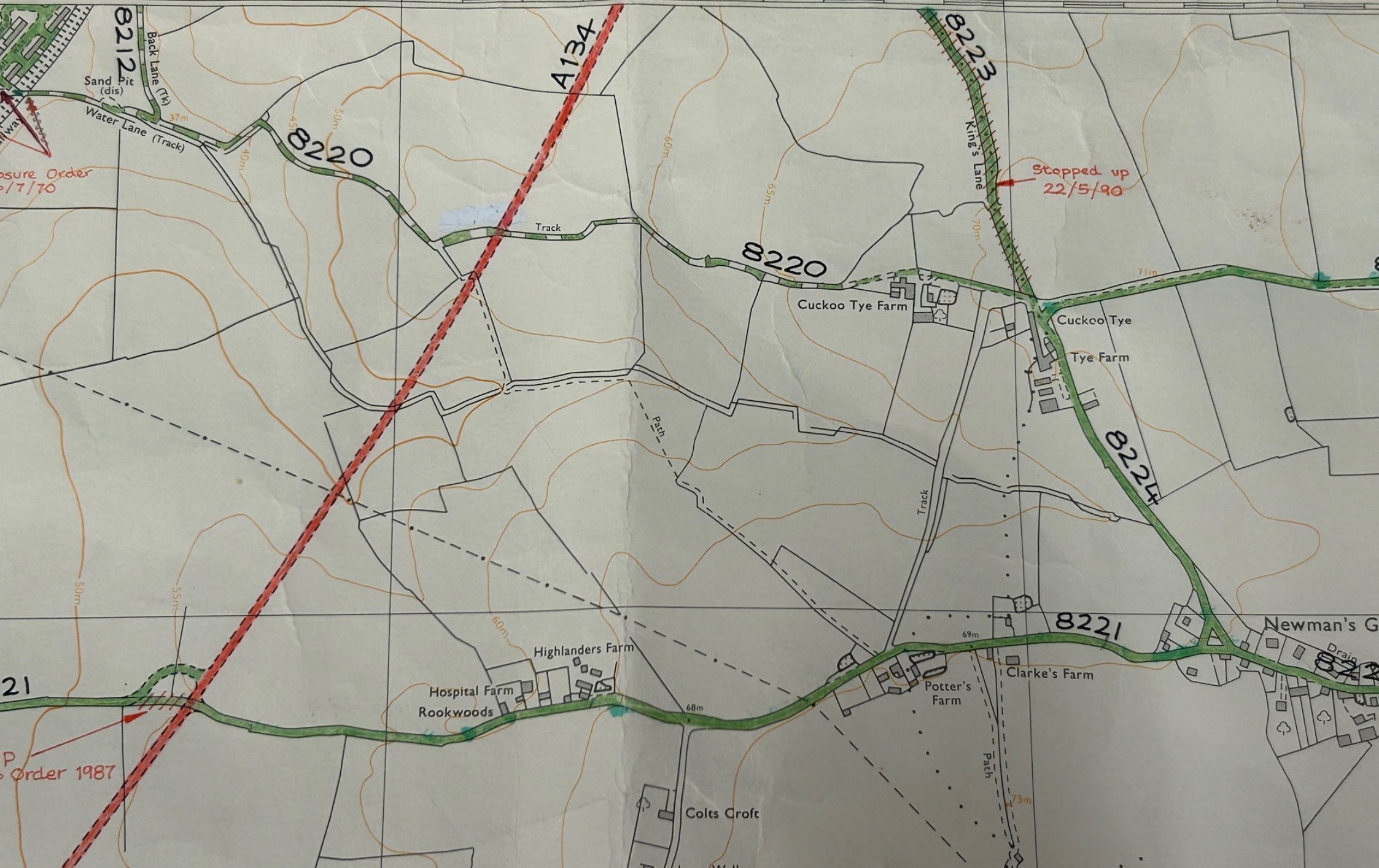

losure Order
/7/70

Stopped up
22/5/90

21
P
Order 1987

Newman's G

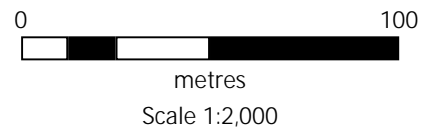
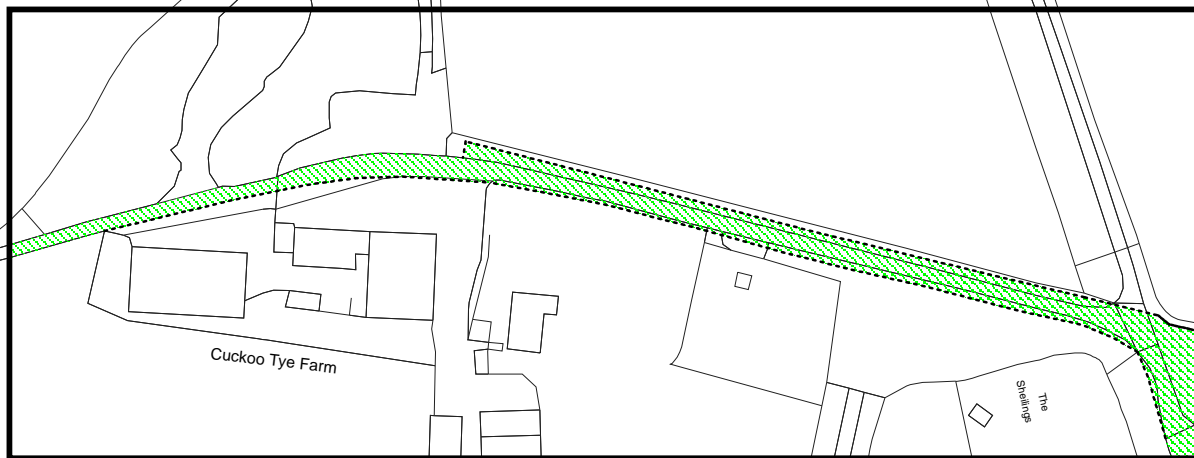

Growth, Highways and Infrastructure,
Endeavour House,
8 Russell Road,
Ipswich,
Suffolk IP1 2BX.

You are permitted to use this data solely to enable you to respond to, or interact with, the organisation that provided you with the data.
You are not permitted to copy, sub-licence, distribute or sell any of this data to third parties in any form.

Date: 19/03/2026

Title: U8220 Cuckoo Tye, Acton

Author: [REDACTED]

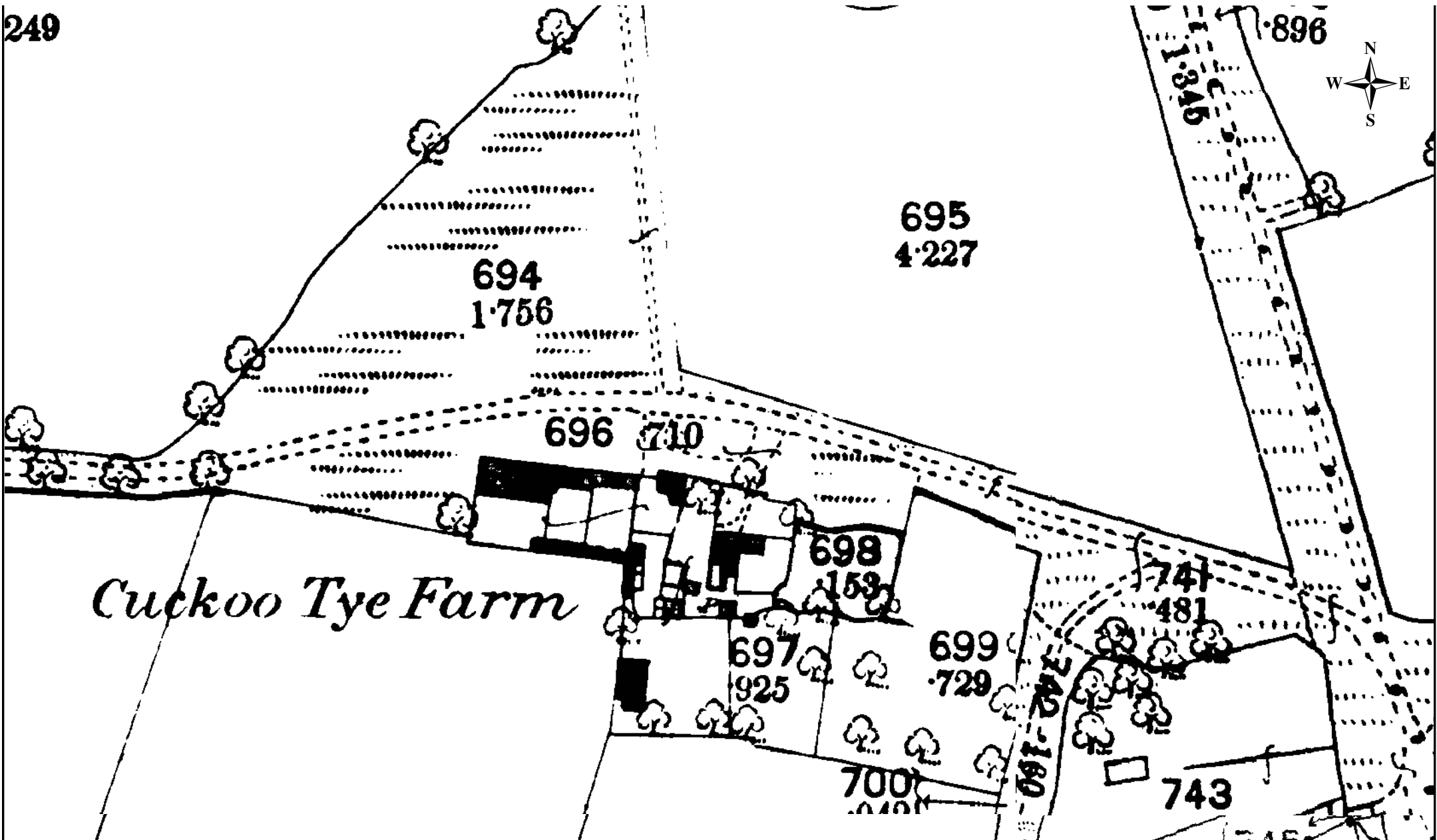

Growth, Highways & Infrastructure,
 Endeavour House,
 8 Russell Road,
 Ipswich,
 Suffolk,
 IP1 2BX

You are permitted to use this data solely to enable you to respond to, or interact with, the organisation that provided you with the data. You are not permitted to copy, sub-license, distribute or sell any of this data to third parties in any form.

Title: 1st Edition OS circa 1886



metres
 Scale 1:1,250

Date: 22/04/2026

Author: [REDACTED]

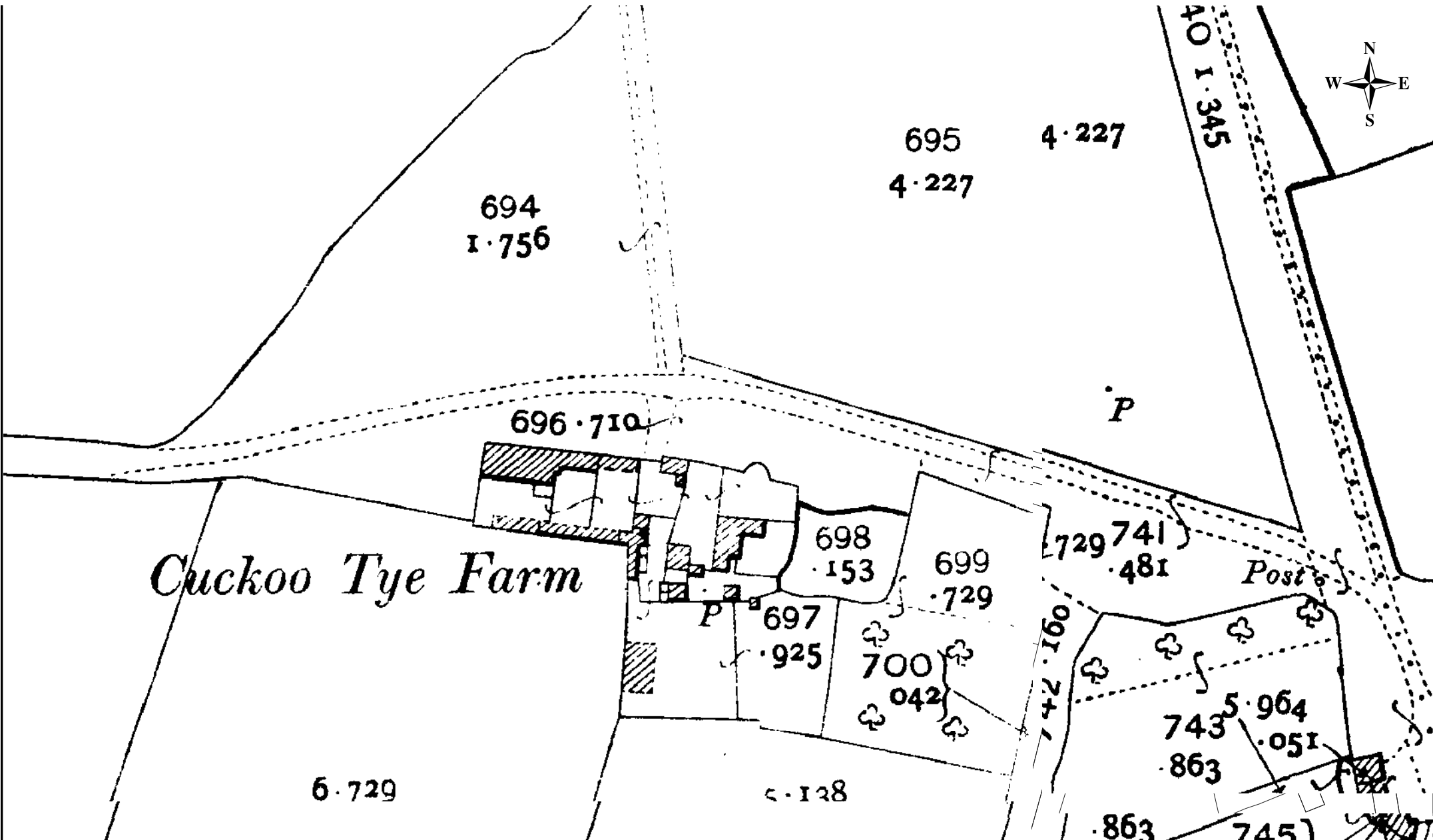

Growth, Highways & Infrastructure,
 Endeavour House,
 8 Russell Road,
 Ipswich,
 Suffolk,
 IP1 2BX

You are permitted to use this data solely to enable you to respond to, or interact with, the organisation that provided you with the data. You are not permitted to copy, sub-licence, distribute or sell any of this data to third parties in any form.

Title: 2nd Edition OS circa 1904

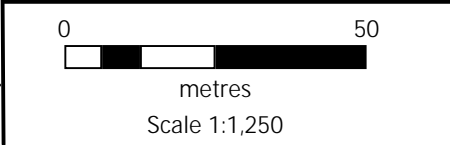

Date: 22/04/2026
 Author: [REDACTED]