

THIS IS AN EXPLANATORY STATEMENT AND DOES NOT FORM PART OF THE ORDER

WILDLIFE AND COUNTRYSIDE ACT 1981

**SUFFOLK COUNTY COUNCIL
(PARISH OF MILDENHALL) MODIFICATION ORDER (No. 2) 2025**

Public footpaths, bridleways, restricted byways and byways open to all traffic are recorded on definitive maps and statements. These maps and statements provide conclusive legal evidence of the existence of public rights. Suffolk County Council is responsible for the definitive map and statement and has a duty to amend them when evidence suggests that they are inaccurate or incomplete. Such amendments are made by means of modification orders under section 53 of the Wildlife and Countryside Act 1981. These orders do not come into effect until confirmed, and if there are any objections the County Council must refer the order and objections to the Department of Environment, Food and Rural Affairs in Bristol.

The County Council has made a modification order under Section 53 to add a footpath as detailed in the order. This order simply recognises the public rights that the authority believes exist. The order does not create any new public rights.

The evidence which the County Council has considered may be consulted free of charge at the following locations:

By prior appointment at the offices of the County Council, Phoenix House, Goddard Road, Ipswich, IP1 5NP:

- Formal Application with attachments dated 16 December 2021
- Hodskinson's Map 1783
- Bryant's Map 1824/5
- Greenwood's Map 1825
- 1979 Review Material
- Ordnance Survey Old Series Map 1836
- Trudy Lovatt landowner information form dated 2 June 2024
- Matthew Culling and Helen Spriggs landowner information form dated 10 June 2024
- Email dated 10 May 2024 from Jenny Bradin, Ramblers Association
- Email dated 1 August 2024 from Sharon Vale, West Row Parish Clerk
- CPM1002 - Applicant Response to Draft Report document from Michael Peachey dated 8 August 2024
- Letter dated 19 November 2024 from Helen Sparks at the Planning Inspectorate to officers
- Grounds of Appeal document dated 19 November 2024 from Micheal Peachey
- Email dated 13 December 2024 from West Row Parish Council to Helen Sparks at the Planning Inspectorate
- Email dated 16 December 2024 from Michael Peachey to Helen Sparks at the Planning Inspectorate
- Letter dated 20 December 2024 from Helen Sparks at the Planning Inspectorate to officers

- Letter dated 10 January 2025 from Helen Sparks at the Planning Inspectorate to officers
- Letter dated 9 July 2025 from Helen Sparks at the Planning Inspectorate to officers
- Schedule 14 Appeal decision dated 9 July 2025 by Paul Freer an Inspector on direction of the Secretary of State for Environment, Food and Rural Affairs

By prior appointment at The Hold, Suffolk Archives, 131 Fore Street, Ipswich, IP33 2AR:

- Mildenhall Tithe Map and Apportionment 1838 (IRO ref: T97/1,2)
- Finance Act 1910 – District Valuer’s Maps and accompanying schedules (IRO ref: 20/207 & 20/206)
- Mildenhall Estate: Plan of the Highland Portion and West Row Village for sale by auction by Messrs Bidwell & Sons from 1911 (IRO ref: A3/3/1/4/25/28)
- 6 inch Ordnance Survey Mapping (1st Edition 1886, Suffolk Sheet XX.SE and 2nd Edition 1903 Cambridgeshire Sheet XXXI.SE)
- 25 inch Ordnance Survey Mapping (2nd Edition 1903, Cambridgeshire Sheet XXXI/11 & 2nd Edition 1904 Suffolk Sheet XX.12)
- 6 inch Ordnance Survey Mapping (Published 1953, Cambridgeshire Sheet XXXI.SE)
- 6 inch Ordnance Survey National Grid Map (Published 1959, Sheet TL67NE – A)
- Mildenhall Parish Survey Map 6/5/51 (IRO ref: A3/3/2/3332/70)
- Mildenhall Parish Survey Statement file May 1951 (IRO ref: A3/3/2/3319/2/12)

Objections or representations relating to the order must be made in writing by 14 October 2025 to the Definitive Map Manager, Suffolk Highways, Phoenix House, 3 Goddard Road, Ipswich, IP1 5NP. The Rights of Way and Access Privacy Notice can be viewed at <https://www.suffolk.gov.uk/about/privacy-notice/rights-of-way-and-access-privacy-notice/> To be relevant, objections or representations should relate to the question of the existence or status of rights of way. Other objections or representations (eg relating to privacy, security or amenity) are irrelevant to the evidential test.

The County Council is willing to discuss the concerns of those considering objecting or making representations relating to the order, and you may contact Lisa Hammarstrom by email: lisa.hammarstrom@suffolk.gov.uk by telephone: 01473 260177, or at the above address.

The right of objection to an order is a statutory right, but it should be exercised in a reasonable manner. The costs involved in dealing with objections to orders are normally awarded against objectors only in cases of unreasonable behaviour.

If there are no objections to the order, or if all objections are withdrawn, the County Council will confirm the order, and the definitive map and statement will then be modified. If there are any objections which are not withdrawn, the County Council must refer the order and objections to the Department of Environment, Food and Rural Affairs, who will appoint an independent Inspector to consider the order and hear the objections, normally by holding a public inquiry. The Inspector may confirm the order, with or without modifications, or may decide that the order should not be confirmed.

**NOTICE OF MODIFICATION ORDER
SECTION 53 OF THE WILDLIFE AND COUNTRYSIDE ACT 1981**

**DEFINITIVE MAP AND STATEMENT FOR THE PARISH OF MILDENHALL IN THE DISTRICT
OF WEST SUFFOLK**

**SUFFOLK COUNTY COUNCIL
(PARISH OF MILDENHALL) MODIFICATION ORDER (No. 2) 2025**

The above order made on 13 August 2025 if confirmed as made, will modify the definitive map and statement for the area by adding a footpath from Mildenhall Footpath 30 on Gravel Drove at Ordnance Survey Grid Reference (OSGR) 56708,27533 to Mildenhall Footpath 2 at OSGR 56763,27504 as shown on the order map.

A copy of the order and the order map and an explanatory statement may be obtained by email or post free of charge by contacting Lisa Hammarstrom on tel: 01473 260177 or email: lisa.hammarstrom@suffolk.gov.uk. They can also be viewed at <https://www.suffolk.gov.uk/roads-and-transport/public-rights-of-way-in-suffolk/making-changes-to-the-definitive-map-and-statement> or inspected at Mildenhall Library, Mildenhall Hub, Sheldrick Way, Mildenhall IP28 7JX. Opening times: Monday to Friday 9.00am until 5.30pm, Saturday 9.00am until 5.00pm and Sunday 10.00am until 4.00pm.

Any representation or objection relating to the order must be sent in writing to the Definitive Map Manager, Rights of Way and Access, Suffolk Highways, Phoenix House, 3 Goddard Road, Ipswich IP1 5NP. Objections should be received not later than 14 October 2025, and applicants are requested to state the grounds on which they are made. Please bear in mind that such correspondence cannot be treated as confidential and may be inspected by any interested party. The Rights of Way and Access Privacy Notice can be viewed at: <https://www.suffolk.gov.uk/about/privacy-notice/rights-of-way-and-access-privacy-notice/>

If no representations or objections are duly made to the order, or to any part of it, or if any so made are withdrawn, Suffolk County Council, instead of submitting the order to the Secretary of State (or part of it if the authority has by notice to the Secretary of State so elected under paragraph 5 of Schedule 15 to the Wildlife and Countryside Act 1981) may itself confirm the order (or that part of the order). If the order is submitted to the Secretary of State for the Environment, Food and Rural Affairs in whole or in part, any representations or objections which have been duly made and not withdrawn will be sent with it.

Dated: 1 September 2025



Nigel Inniss

Head of Governance, Suffolk County Council,
Endeavour House, 8 Russell Road, Ipswich, IP1 2BX

WILDLIFE AND COUNTRYSIDE ACT 1981

DEFINITIVE MAP AND STATEMENT FOR THE PARISH OF MILDENHALL
IN THE DISTRICT OF WEST SUFFOLK

SUFFOLK COUNTY COUNCIL (PARISH OF MILDENHALL)
MODIFICATION ORDER (No. 2) 2025

This Order is made by Suffolk County Council under section 53(2)(b) of the Wildlife and Countryside Act 1981 ("the Act"), in accordance with a direction made to the Council by the Secretary of State under paragraph 4(2) of Schedule 14 to the Act to modify the Definitive Map and Statement for the parish of Mildenhall in the District of West Suffolk in consequence of an event specified in section 53(3)(c)(iii) namely the discovery of evidence which shows that: a footpath which is not shown in the map and statement subsists or is reasonably alleged to subsist, as shown on the order map.

The authority has consulted with every local authority whose area includes the land to which the Order relates. The Suffolk County Council hereby order that:

1. For the purpose of this Order the relevant date is 1 August 2025.
2. The Definitive Map and Statement for the parish of Mildenhall in the District of West Suffolk shall be modified as described in Part 1 and Part 2 of the Schedule and shown on the map attached to the Order.
3. This Order shall take effect on the date it is confirmed and may be cited as the Suffolk County Council (Parish of Mildenhall) Modification Order (No.2) 2025.

Date: 13th Aug 2025

THE COMMON SEAL of SUFFOLK
COUNTY COUNCIL was hereunto
affixed in the presence of:-

 69925
A. McQuinn-Millard
An authorised Officer of the Council

SCHEDULE

Part 1: Modification of Definitive Map

Description of footpath to be added:

There shall be added to the Definitive Map for the parish of Mildenhall a footpath from a point at Ordnance Survey grid reference 56708,27533 (point A) to a point at Ordnance Survey grid reference 56763,27504 (point D) as shown on the attached map.

Part 2: Modification of Definitive Statement

Particulars of footpath to be added:

There shall be added to the Definitive Statement for Mildenhall the following particulars:



Mildenhall Footpath 66

Commencing at a junction with Mildenhall Footpath 30 on Gravel Drove at Ordnance Survey Grid Reference (OSGR) 56708,27533 (point A) and progressing in a generally south south easterly direction across a field for approximately 108 metres to OSGR 56714,27524 (point B) and crossing a track then running across a field in a south easterly direction for approximately 302 metres to a hedge at OSGR 56738,27505 (point C) then progressing in an easterly direction for 254 metres to a junction with Footpath 2 at OSGR 56763,27504 (point D).

Width: 1 metre

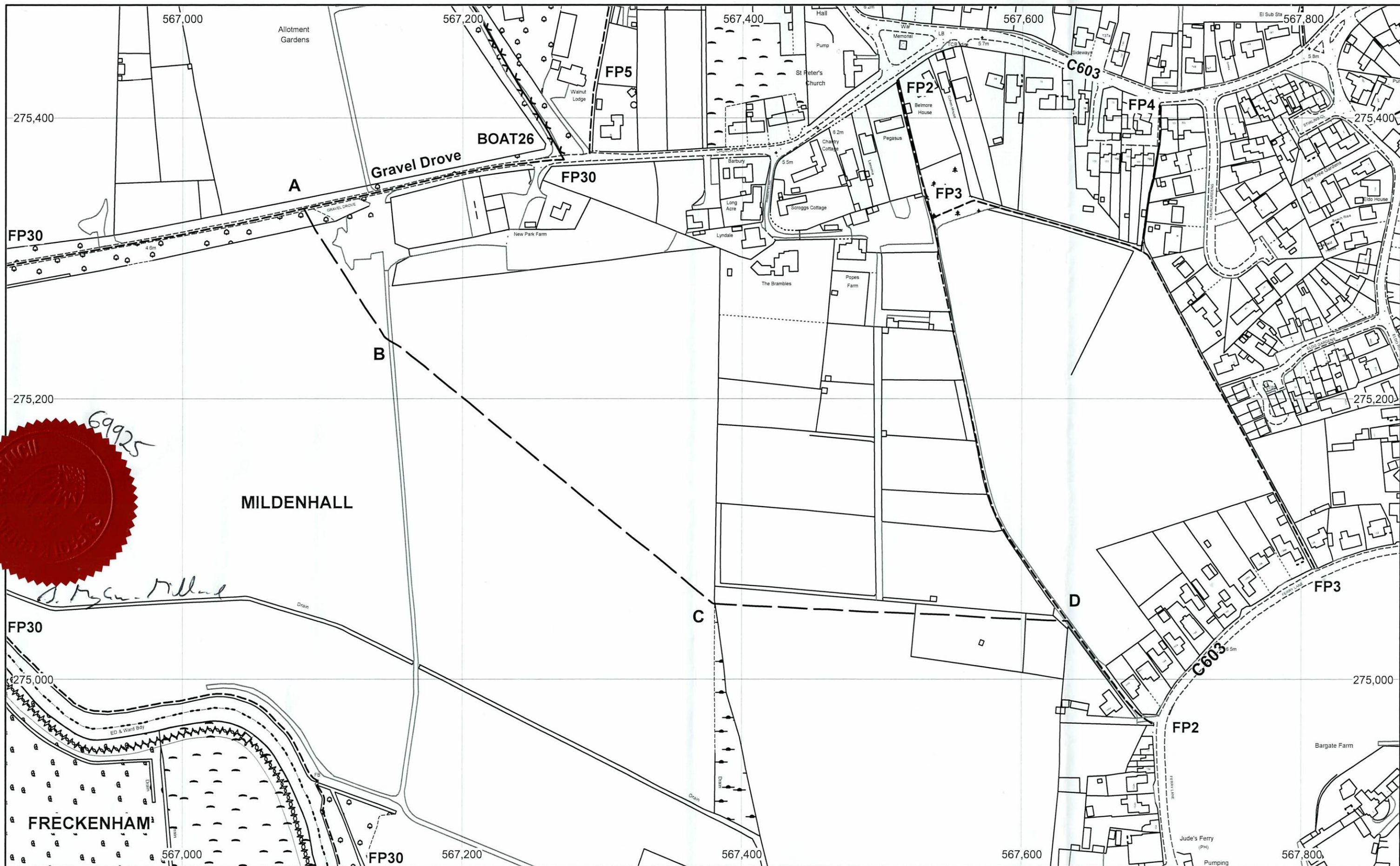
(In the absence of any other evidence of width this is the minimum width that the highway authority would seek to be reinstated for a cross-field footpath following disturbance or obstruction, as set out in the Highways Act 1980 Schedule 12a).



 <p>Suffolk County Council</p> <p>Executive Director of Growth, Highways and Infrastructure Endeavour House, 8 Russell Road, Ipswich, Suffolk. IP1 2BX.</p>	<p>Scale: 1:2,500 at A3</p> <p>Ordnance Survey MasterMap</p> <p>© Crown copyright and database rights OS AC0000849963 2025</p>	<table border="0"> <tr> <td>-----</td> <td>Proposed Footpath (A-B-C-D)</td> </tr> <tr> <td>-----</td> <td>Existing Footpath</td> </tr> <tr> <td>-----</td> <td>Existing Byway</td> </tr> <tr> <td>-----</td> <td>Parish Boundary</td> </tr> </table> <div style="text-align: center;">  </div>	-----	Proposed Footpath (A-B-C-D)	-----	Existing Footpath	-----	Existing Byway	-----	Parish Boundary	<p style="text-align: center;">PROPOSED PUBLIC FOOTPATH IN MILDENHALL</p>
-----	Proposed Footpath (A-B-C-D)										
-----	Existing Footpath										
-----	Existing Byway										
-----	Parish Boundary										