

THIS IS AN EXPLANATORY STATEMENT AND DOES NOT FORM PART OF THE ORDER

WILDLIFE AND COUNTRYSIDE ACT 1981

**SUFFOLK COUNTY COUNCIL
(PARISH OF MILDENHALL) MODIFICATION ORDER (No. 3) 2025**

Public footpaths, bridleways, restricted byways and byways open to all traffic are recorded on definitive maps and statements. These maps and statements provide conclusive legal evidence of the existence of public rights. Suffolk County Council is responsible for the definitive map and statement and has a duty to amend them when evidence suggests that they are inaccurate or incomplete. Such amendments are made by means of modification orders under section 53 of the Wildlife and Countryside Act 1981. These orders do not come into effect until confirmed, and if there are any objections the County Council must refer the order and objections to the Department of Environment, Food and Rural Affairs in Bristol.

The County Council has made a modification order under Section 53 to add a footpath as detailed in the order. This order simply recognises the public rights that the authority believes exist. The order does not create any new public rights.

The evidence which the County Council has considered may be consulted free of charge at the following locations:

By prior appointment at the offices of the County Council, Phoenix House, Goddard Road, Ipswich, IP1 5NP:

- Formal Application with attachments dated 18 December 2021
- Hodskinson's Map 1783
- Bryant's Map 1824/5
- Greenwood's Map 1825
- Ordnance Survey Old Series Map 1836
- Google Earth aerial photography dated circa. 1945
- 1979 Review Material
- Email dated 21 January 2025 from Michael Peachey
- Email dated 10 February 2025 from Michael Peachey
- Barrie Taylor Landowner information form dated 14 January 2025
- Michael Hammond Landowner information form dated 18 January 2025
- Stuart Norman Landowner information form dated 22 January 2025
- Email dated 12 January 2025 from Michael Hammond
- Email dated 18 January 2025 from Michael Hammond to the West Row parish council
- Email dated 21 January 2025 from Michael Peachey to Michael Hammond
- Email dated 7 February 2025 from officers to Matthew Bastick
- Email dated 17 February 2025 from Matthew Bastick
- Email dated 20 February 2025 from officers to Matthew Bastick
- Email dated 29 January 2025 from West Row parish council
- Email dated 13 May 2025 from Cllr. Colin Noble, local county councillor to officers

- Email dated 13 May 2025 from Jenny Bradin, local Ramblers Association representative to officers
- Email dated 13 May 2025 from Michael Peachey to officers
- Email dated 15 May 2025 from Sharon Vale, West Row parish clerk to officers
- Photographs from site visit taken by officers on 26 February 2025

By prior appointment at The Hold, Suffolk Archives, 131 Fore Street, Ipswich, IP33 2AR:

- Mildenhall Pre-Inclosure map and award 1810 (IRO ref: Q/RI/30A & Q/RI/24)
- Mildenhall Inclosure map and award 1812 (IRO ref: EF 505/1/81)
- Mildenhall Tithe map and apportionment 1858 (IRO ref: T97/1,2)
- Finance Act 1910 – District Valuer's working map sheets and field books (IRO ref: 20/168 & 20/169)
- Mildenhall Estate: Plan of the Highland Portion and West Row Village for sale by auction by Messrs Bidwell & Sons from 1911, Declaration as to Title by Mr. R. A. Boyce and Sir H. C. J. Bunbury Bart. to James Muir Dunlop Esq. Conveyance dated 11 October 1911 (IRO ref: A3/3/1/4/25/28)
- Mildenhall parish council meeting minutes dated circa. 1919-1920 (IRO ref: EG 711/1/1)
- Mildenhall parish council meeting minutes dated 1938 (IRO ref: EG 711/1/3)
- Mildenhall parish council meeting minutes dated 1950 (IRO ref: EG 711/1/4)
- 6 inch Ordnance Survey Mapping (1st Edition 1886 & 2nd Edition 1905 Cambridgeshire Sheet XX.NE)
- 25 inch Ordnance Survey Mapping (1st Edition 1904, Suffolk Sheet XX.8 & 2nd Edition 1935 Suffolk Sheet XX.7)
- 6 inch Ordnance Survey Mapping (Published 1952, Suffolk Sheet XX.NE)
- 6 inch Ordnance Survey National Grid Map (Published 1959, Sheet TL67NE – A)
- Mildenhall Parish Survey Map 6/5/51 (IRO ref: A3/3/2/3332/70)
- Mildenhall Parish Survey Statement file May 1951 (IRO ref: A3/3/2/3319/2/12)

Objections or representations relating to the order must be made in writing by 14 October 2025 to the Definitive Map Manager, Suffolk Highways, Phoenix House, 3 Goddard Road, Ipswich, IP1 5NP. The Rights of Way and Access Privacy Notice can be viewed at <https://www.suffolk.gov.uk/about/privacy-notice/rights-of-way-and-access-privacy-notice/> To be relevant, objections or representations should relate to the question of the existence or status of rights of way. Other objections or representations (eg relating to privacy, security or amenity) are irrelevant to the evidential test.

The County Council is willing to discuss the concerns of those considering objecting or making representations relating to the order, and you may contact Lisa Hammarstrom by email: lisa.hammarstrom@suffolk.gov.uk by telephone: 01473 260177, or at the above address.

The right of objection to an order is a statutory right, but it should be exercised in a reasonable manner. The costs involved in dealing with objections to orders are normally awarded against objectors only in cases of unreasonable behaviour. If there are no objections to the order, or if all objections are withdrawn, the County

Council will confirm the order, and the definitive map and statement will then be modified. If there are any objections which are not withdrawn, the County Council must refer the order and objections to the Department of Environment, Food and Rural Affairs, who will appoint an independent Inspector to consider the order and hear the objections, normally by holding a public inquiry. The Inspector may confirm the order, with or without modifications, or may decide that the order should not be confirmed.

**NOTICE OF MODIFICATION ORDER
SECTION 53 OF THE WILDLIFE AND COUNTRYSIDE ACT 1981**

**DEFINITIVE MAP AND STATEMENT FOR THE PARISH OF MILDENHALL IN THE DISTRICT
OF WEST SUFFOLK**

**SUFFOLK COUNTY COUNCIL
(PARISH OF MILDENHALL) MODIFICATION ORDER (No. 3) 2025**

The above order made on 13 August 2025 if confirmed as made, will modify the definitive map and statement for the area by adding a footpath from Cow and Sheep Drove (U6018 road) at Ordnance Survey Grid Reference (OSGR) 56727,27705 to Pollard's Lane (C603 road) at OSGR 56760,27650 as shown on the order map.

A copy of the order and the order map and an explanatory statement may be obtained by email or post free of charge by contacting Lisa Hammarstrom on tel: 01473 260177 or email: lisa.hammarstrom@suffolk.gov.uk. They can also be viewed at <https://www.suffolk.gov.uk/roads-and-transport/public-rights-of-way-in-suffolk/making-changes-to-the-definitive-map-and-statement> or inspected at Mildenhall Library, Mildenhall Hub, Sheldrick Way, Mildenhall IP28 7JX. Opening times: Monday to Friday 9.00am until 5.30pm, Saturday 9.00am until 5.00pm and Sunday 10.00am until 4.00pm.

Any representation or objection relating to the order must be sent in writing to the Definitive Map Manager, Rights of Way and Access, Suffolk Highways, Phoenix House, 3 Goddard Road, Ipswich IP1 5NP. Objections should be received not later than 14 October 2025, and applicants are requested to state the grounds on which they are made. Please bear in mind that such correspondence cannot be treated as confidential and may be inspected by any interested party. The Rights of Way and Access Privacy Notice can be viewed at: <https://www.suffolk.gov.uk/about/privacy-notice/rights-of-way-and-access-privacy-notice/>

If no representations or objections are duly made to the order, or to any part of it, or if any so made are withdrawn, Suffolk County Council, instead of submitting the order to the Secretary of State (or part of it if the authority has by notice to the Secretary of State so elected under paragraph 5 of Schedule 15 to the Wildlife and Countryside Act 1981) may itself confirm the order (or that part of the order). If the order is submitted to the Secretary of State for the Environment, Food and Rural Affairs in whole or in part, any representations or objections which have been duly made and not withdrawn will be sent with it.

Dated: 1 September 2025



Nigel Inniss

Head of Governance, Suffolk County Council,
Endeavour House, 8 Russell Road, Ipswich, IP1 2BX

WILDLIFE AND COUNTRYSIDE ACT 1981

**DEFINITIVE MAP AND STATEMENT FOR THE PARISH OF MILDENHALL
IN THE DISTRICT OF WEST SUFFOLK**

**SUFFOLK COUNTY COUNCIL (PARISH OF MILDENHALL)
MODIFICATION ORDER (No. 3) 2025**

This Order is made by Suffolk County Council under section 53(2)(c)(i) of the Wildlife and Countryside Act 1981 ("the Act"), because it appears to that authority that the Definitive Map and Statement for the parish of Mildenhall in the District of West Suffolk require modification in consequence of the occurrence of an event specified in section 53(3)(c)(i) namely, the discovery by the authority of evidence which shows that a right of way which is not shown in the map and statement subsists or is reasonably alleged to subsist over land in the area to which the map relates being a right of way such that the land over which the right subsists is a public path.

The authority has consulted with every local authority whose area includes the land to which the Order relates. The Suffolk County Council hereby order that:

1. For the purpose of this Order the relevant date is 1 August 2025.
2. The Definitive Map and Statement for the parish of Mildenhall in the District of West Suffolk shall be modified as described in Part 1 and Part 2 of the Schedule and shown on the map attached to the Order.
3. This Order shall take effect on the date it is confirmed and may be cited as the Suffolk County Council (Parish of Mildenhall) Modification Order (No.3) 2025.

Date: 13th August 2025

THE COMMON SEAL of SUFFOLK
COUNTY COUNCIL was hereunto
affixed in the presence of:-

S. Myles-Miller

An authorised Officer of the Council



SCHEDULE

Part 1: Modification of Definitive Map

Description of footpath to be added:

There shall be added to the Definitive Map for the parish of Mildenhall a footpath from a point at Ordnance Survey grid reference 56727,27705 (point A) to a point at Ordnance Survey grid reference 56760,27650 (point F) as shown on the attached map.

Part 2: Modification of Definitive Statement

Particulars of footpath to be added:

There shall be added to the Definitive Statement for Mildenhall the following particulars:

Mildenhall Footpath 65

Commencing at a junction with the U6018 road (Cow and Sheep Drove) at Ordnance Survey Grid Reference (OSGR) 56727,27705 (point A) and progressing in a southerly direction for approximately 80 metres to OSGR 56728,27697 (point B); changing to a south-easterly direction following the northern side of a wooden post and rail fence for approximately 47 metres to OSGR 56731,27694 (point C); changing to a southerly direction and continuing along the eastern side of the post and rail fence for approximately 96 metres to OSGR 56731,27685 (point D); leaving the fence and changing to a south-easterly direction for approximately 148 metres to OSGR 56742,27675 (point E); then running in a generally south-south-easterly direction for approximately 304 metres to a junction with the C603 road (Pollard's Lane) at OSGR 56760,27650 (point F).

Width: From a point at OSGR 56727,27705 to a point at OSGR 56731,27685: 1.22 metres

(The path width for this section is the metric equivalent of the width set out in the Mildenhall 1812 Inclosure award as 4 feet).

From a point at OSGR 56731,27685 to a point at OSGR 56760,27650: minimum of 1 metre

(The path width for this section is based on Schedule 12A of the Highways Act 1980, which sets out the minimum widths that the highway authority can enforce when seeking the reinstatement of a public right of way following surface disturbance of a cross-field route).



A. Mason - Millard

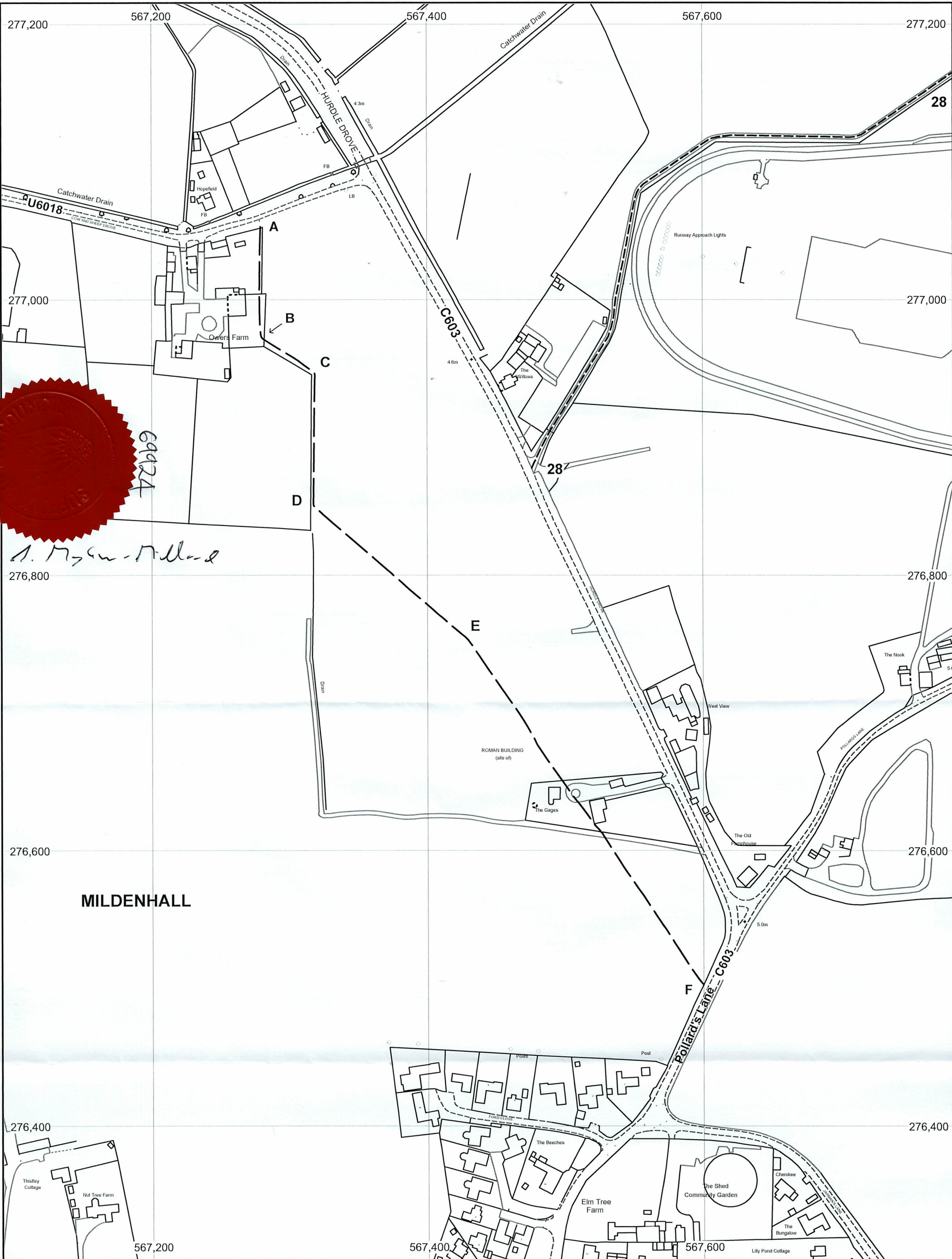

Executive Director of Growth, Highways and Infrastructure
Endeavour House, 8 Russell Road, Ipswich, Suffolk. IP1 2BX.

- Proposed Footpath (A-B-C-D-E-F)
- Existing Footpath

Ordnance Survey MasterMap Crown Copyright. All rights reserved.
Suffolk County Council Licence No. AC0000849963 2025



PROPOSED PUBLIC FOOTPATH IN MILDENHALL

Scale: 1:2,500 at A3