

DATED 19 July 2023

SUFFOLK COUNTY COUNCIL (1)

- and -

HILLS RESIDENTIAL CONSTRUCTION LTD (2)

- and -

AGREEMENT

made pursuant to Sections 278 and 38 of the Highways Act 1980
and any other enabling power relating to
the development of land on the south side of Heath Road, East Bergholt, Colchester

Nigel Inniss
Head of Legal Services
Suffolk County Council
8 Russell Road Ipswich
Suffolk IP1 2BX

Ref: AS/72219/LEGAL

I HEREBY CERTIFY THIS DOCUMENT
TO BE A TRUE COPY OF THE ORIGINAL
A Siddika
HEAD OF LEGAL SERVICES Case worker
SUFFOLK COUNTY COUNCIL
THE CONSTANTINE HOUSE, 5 CONSTANTINE ROAD
IPSWICH IP1 2DH
DATED 26 July 2023

**SECTION 278 AGREEMENT
INDEX**

		Page
Recitals & Definitions		
RECITALS AND DEFINITIONS.....		4
1	LEGAL EFFECT	9
2	NOTICES	10
3	GENERAL.....	11
4	ARBITRATION	11
5	COVENANTS.....	12
1	THE DESIGN OF THE HIGHWAY WORKS	15
2	LETTING OF THE CONTRACT.....	16
3	INSPECTION OF THE HIGHWAY WORKS	17
4	TESTING OF MATERIALS	18
5	OPENING OF THE HIGHWAY WORKS.....	19
6	UNDERTAKERS.....	20
7	PROTECTION OF THE PUBLIC	21
10	TIMING.....	23
11	SAFETY	23
12	ACCOMMODATION WORKS	24
13	CONSTRUCTION (DESIGN AND MANAGEMENT) REGULATIONS 2015	24
14	SITE CLEARANCE AND CERTIFICATE(S) OF SUBSTANTIAL COMPLETION	26
15	DEFECTS CORRECTION PERIOD AND CERTIFICATE OF FINAL COMPLETION	26

16	INDEMNITY	28
17	PERFORMANCE BOND / PERFORMANCE Cash deposit	29
18	COMMUTED SUMS FOR MAINTENANCE.....	30
19	LEGAL AND ADMINISTRATIVE COSTS.....	31
20	PARTS I AND II OF THE LAND COMPENSATION ACT 1973.....	32
	SCHEDULE II.A.....	34
	SCHEDULE II.B – <i>not used</i>	38
	SCHEDULE III	38
	SCHEDULE IV.....	39

THIS AGREEMENT is made the 19th day of July 2023
BETWEEN the following parties :-

- (1) SUFFOLK COUNTY COUNCIL of Endeavour House 8 Russell Road Ipswich Suffolk IP1 2BX ("the County Council")
- (2) HILLS RESIDENTIAL CONSTRUCTION LTD (company number 03919214) of Bridge Mill House, Brook Street Business Centre, Brook Street, Colchester CO1 2UZ ("the Developer")

RECITALS AND DEFINITIONS

(A) In this Agreement unless the context otherwise requires the following words shall have the following meanings :-

"1980 Act"	Means the Highways Act 1980 (as amended)
"Approved Contractor"	Means the contractor(s) approved by the County Council for carrying out the Highway Works of the value and complexity proposed
"Approved Sub-Contractor"	Means the sub-contractor(s) approved by the County Council for carrying out the Highway Works of the value and complexity proposed
"CDM Regulations"	Means the Construction (Design and Management) Regulations 2015 (SI 2015/51)
"Certificate of Final Completion"	Means any of the certificates referred to in paragraph 15.3 of Schedule I
"Certificate of Substantial Completion"	Means any of the certificates referred to in paragraph 14.2 of Schedule I
"Committed Sums"	Means the sum of £29,994.63 (twenty-nine thousand nine hundred and ninety-four and sixty-three pence) which is calculated, as set out in paragraph 18.1 on Schedule I towards the cost of the County Council's future maintenance liability of the Highway Works

"Compensation Figure"	Means the sum of £6,650.00 (six thousand six hundred and fifty pounds) which is the amount which the Director reasonably considers sufficient to meet the likely cost of settling claims and connected costs under Part I of the Land Compensation Act 1973
"Compensation Cash Deposit"	Means the cash deposit to be paid to the County Council in the sum of the Compensation Figure being the sum the County Council reasonably considers sufficient to meet the likely cost of settling claims and connected costs under Part I of the Land Compensation Act 1973
"Contract"	Means the contract or contracts in respect of each and all of the Highway Works
"Contractor"	Means the contractor or contractors who have been awarded the Contract to execute the Highway Works. For the avoidance of doubt the aforementioned definition does not include any subcontractor
"Development"	Means the development to be carried out pursuant to the Permission
"Director"	Means the County Council's Executive Director of Growth, Highways and Infrastructure or other officers of the County Council acting under his hand
"Easement Strips"	Means jointly and severally the areas to be accessible by the Council for the purposes of inspecting, maintaining, and reinstating the Highway Concrete Culverts which is shown shaded in purple on Plans 22-030-603 REV D and 22-030-604-REV C
"Highway Concrete Culverts"	means jointly and severally the culverts being established beneath the proposed highway shown by thick blue dashes on Plans 22-030-603 REV D and 22-030-604-REV C including their associated brick headwalls as identified on the key to those plans

“Highway Works”	Means the works collectively or individually as the context requires which are set out in Schedule III of this Agreement and shown in the Works Drawings
“Highway Structure”	Means any bridge, subway, culvert, pipe, tunnel, or other structure built in, over, under or adjacent to any part of the highway
“Performance Bond”	Means the bond with the Performance Bond Surety for each and all of the Highway Works, such bond to be in the form set out in Schedule II.A, to the effect that should the Developer default in the execution of its obligations to carry out the Highway Works and to maintain the same in accordance with the provisions of this Agreement then the County Council will call upon the Performance Bond Surety to provide the full value of the Performance Bond (subject to the provisions hereinafter contained) to carry out the Highway Works and maintain the same as aforesaid
“Performance Figure”	Means the sum of £182,357.98 (one hundred and eighty-two thousand, three hundred and fifty-seven pounds and ninety-eight pence) being the Tender Sum plus 10 per cent in respect of the Highway Works and as set out in each of the Contracts
“Performance Bond Surety”	Means FIDELIS UNDERWRITING LIMITED (incorporated in England registered number 09753615 and FCA reference number 709360) whose registered office is at 22 Bishopsgate Level 42, London, England, EC2N 4BQ
“Permission”	Means the planning permission granted by Babergh District Council dated 9 February 2018 granted with reference number B/16/01092 in respect of the Site together with any modification of it
“Road Safety Audit”	Means the evaluation of each and all of the Highway Works during design and at the end of construction to identify potential road safety problems that may affect any users of the highway and to suggest measures to eliminate or mitigate

	those problems in accordance with Department for Transport standards or by the County Council as agreed by the Director
“Site”	Means land situated at the south side of Heath Road, East Bergholt, Colchester shown edged red for identification only on the attached plan no 170120/P75/01
“Specification”	The County Council’s “Specification for Estate Roads” dated May 2007 (or later amendment current at the date of this Agreement) so far as this is consistent with the Works Drawings and description in Schedule III (subject to any variations agreed in writing by the Director)
“Sub-contractor”	Means the sub-contractor(s) working for the Contractor(s) who have been contracted to execute the Highway Works
“Substantial Completion”	Means complete to the reasonable satisfaction of the Director and so that the Highway Works can be used for the purpose and operate in the manner for which they were designed
“Technical Standards”	Means the standards necessary to ensure complete conformity with all UK primary and secondary legislation (including by-laws) all guidance standards and codes of practice issued by the Department for Transport the County Council statutory undertakers and relevant professional institutes the Road Safety Audit and formal instructions issued by the Director from time to time during the design and implementation of the Highway Works and for the avoidance of doubt this shall include the Traffic Signs Regulations and General Directions 2016 and BS5489 in relation to the design of any street lighting
“Tender Sum”	Means the sum of £165,779.98 (one hundred and sixty five thousand, seven hundred and seventy nine pounds and ninety eight pence) (including the costs associated with statutory undertakers work and traffic management) agreed by the Director for carrying out the Contract by the Contractor
“Works Drawings”	Means the attached drawings bearing the numbers referred to in Schedule IV or any subsequent revision of them which has

been approved or requested by the Director and which relate to the Highway Works

- (B) In this Agreement unless the context otherwise requires :-
- (i) Words importing the singular meaning where the context so admits include the plural meaning and vice versa; and
 - (ii) Words of the masculine gender include the feminine and neuter genders and words denoting actual persons include companies, corporations and firms and all such words shall be construed interchangeably in that manner; and
 - (iii) "party" or "parties" means a party or parties to this Agreement; and
 - (iv) references to any party shall include the successors in title and assigns of that party; and in the case of the County Council the successors to its statutory functions; and
 - (v) where a party includes more than one person any obligations of that party can be enforced against all of them jointly and severally unless there is an express provision otherwise; and
 - (vi) the headings and contents list in this Agreement shall not form part of or affect its construction; and
 - (vii) references to clauses schedules and paragraphs are references to clauses in and schedules to this Agreement and paragraphs in schedules to this Agreement; and
 - (viii) where a party or any officer or employee is required to give its consent approval or agreement to any specific provision in this Agreement such consent approval or agreement shall not be unreasonably withheld or delayed; and
 - (ix) any mention herein of any act or of any section regulation or statutory instrument shall be deemed to refer to the same source as at any time amended and where such act section regulation or statutory instrument has been replaced consolidated or re-enacted with or without amendment such mention shall be deemed to refer to the relevant provision of the updating consolidating or re-enacting act or section or regulation or statutory instrument

- (C) The County Council is the highway authority (except for trunk roads) for the purposes of the 1980 Act for the area within which the Site is situated and the Highway Works will be carried out
- (D) The Developer has the benefit of the Permission
- (E) The Developer is the registered proprietor with title absolute of the Site in so far as it is registered at the Land Registry under Title Number SK420041
- (F) The Developer wishes to dedicate as public highway that part of the Site upon which the Highway Works are to be constructed which does not currently form part of the public highway and the County Council agrees to accept such dedication and adopt that part of the Site and the Highway Works as highway maintainable at public expense on the terms and conditions hereinafter contained
- (G) The Developer wishes to grant easements to the County Council for the benefit of draining surface water from the highway and for the maintenance of such surface water drains
- (H) Having regard to the development plan and other material considerations the County Council considers it expedient in the interests of the proper planning of their area that the Highway Works need to be carried out to facilitate the Development and that entering into this Agreement will be of benefit to the public

NOW THIS DEED WITNESSES as follows:-

1 LEGAL EFFECT

- 1.1. This Agreement and the covenants that appear hereinafter are made pursuant to Sections 38 72 and 278 of the 1980 Act Section 111 of the Local Government Act 1972 and Section 1 of the Localism Act 2011 and all other enabling powers to the intent that the provisions of this Agreement shall bind the Site and the parties hereto and all persons deriving title through or under them
- 1.2. This Agreement is a Deed. Any financial default under this Agreement will be registered as a Local Land Charge under section 278(5)(c) of the 1980 Act

- 1.3. No waiver (whether express or implied) by the County Council of any breach or default by the Developer in the performance or observance of any of the covenants, terms or obligations in this Agreement shall constitute a continuing waiver and no such waiver shall prevent the County Council from enforcing any of the covenants, terms or obligations or from acting upon any subsequent breach or default in respect thereof
- 1.4. Any provision of this Agreement which is or may be unlawful void or unenforceable shall to the extent of such unlawfulness invalidity or unenforceability be deemed severable and shall not affect any other provision of this Agreement
- 1.5. This Agreement is governed by and interpreted in accordance with English law and shall be determined in the Courts of England

2 NOTICES

- 2.1. Any notices or other written communication to be served or given by one party upon or to any other party under the terms of this Agreement shall be deemed to have been validly served or given if delivered by hand or sent by recorded delivery post or sent by the DX service to the party upon whom it is to be served or to whom it is to be given or as otherwise notified for the purpose by notice in writing provided that the notice or other written communication is addressed and delivered by hand or by recorded delivery post or by the DX service to the address of the party concerned as nominated in sub-clause 2.2. below
- 2.2. The address for any notice or other written communication in the case of each party to this Agreement shall be as follows:-

The County Council Suffolk County Council Endeavour
House 8 Russell Road Ipswich IP1
2BX marked for the attention of the
Assistant Director of Governance,
Legal and Assurance (or where the
context requires the Executive
Director of Growth, Highways and
Infrastructure, Endeavour House 8
Russell Road Ipswich IP1 2BX)

- 2.3. The Developer marked for the attention of the Stephen Williams of Bridge Mill House, Business Centre, Brook St, Colchester CO1 2UZ Any notice or other written communication to be given by the County Council shall be deemed to be valid and effective if on its face it is signed on behalf of the County Council by a duly authorised officer

3 GENERAL

- 3.1. All works and activities to be carried out under the terms of this Agreement (including for the avoidance of doubt such works as are of a preparatory ancillary or of a maintenance nature) are (save where expressly provided otherwise) to be at the sole expense of the Developer and at no cost to the County Council
- 3.2. All consideration given and payments made in accordance with the provisions of this Agreement shall be exclusive of any VAT properly payable in respect thereof and in the event of VAT becoming chargeable at any time in respect of any supply made in accordance with the terms of this Agreement then to the extent that VAT had not previously been charged in respect of that supply the person making the supply shall raise a VAT invoice to the person to whom the supply was made and the VAT shall be paid accordingly
- 3.3. The County Council and their respectively duly authorised officers and agents may enter upon the land on which the Highway Works are being carried out at any reasonable time to ascertain whether the terms of the Agreement are being or have been complied with

4 ARBITRATION

- 4.1. Any dispute or difference arising between the parties as a result of this Agreement may be referred to the arbitration of a single arbitrator to be agreed upon between the parties or failing agreement within fourteen days after either of the parties has given to the other a written request requiring the appointment of an arbitrator to a person to be appointed at the request of either of the parties by the President for the time being of The Institution of Civil Engineers

- 4.2. Any reference to arbitration shall be undertaken in accordance with and subject to the provisions of the Arbitration Act 1996 save as follows:-
- (a) the seat of the arbitration shall be at the County Council's offices in Ipswich Suffolk
 - (b) where appropriate the arbitrator may consolidate arbitral proceedings
 - (c) with the parties' agreement the arbitrator may appoint experts or legal advisers
- 4.3 A party wishing to refer any such dispute or difference to arbitration shall notify the other party in writing of such intention without delay
- 4.4 The arbitrator shall act as a referee and not as an expert except in any case where the parties to a dispute or difference agree on the arbitrator when such parties may also agree that such arbitrator shall act as an expert
- 4.5 Subject to Sections 67 68 and 69 of the Arbitration Act 1996 the parties agree to be bound by the decision of the arbitrator

5 COVENANTS

- 5.1 The Developer covenants and warrants to the County Council that they have full power to enter into this Agreement and there is no other person having a charge over or any other interest in the Site whose consent is necessary for the Developer to enter into this Agreement and to comply with the obligations set out at paragraph 14.3 of Schedule I
- 5.2 The Developer hereby covenants and undertakes with the County Council that from the date of this Agreement it will (unless otherwise agreed by the County Council) carry out and comply with the obligations set out in Schedule I and the details set out in Schedules III and IV hereto
- 5.3 The County Council without prejudice to its statutory powers and duties hereby appoints the Developer to act as its agent and gives to the Developer licence (in so far as is reasonably necessary for the Developer to perform the obligations under the terms of this Agreement) to enter into and upon and remain upon the highway to carry out the construction of

the Highway Works within the timescales referred to in Schedule III hereto or such other period as may be agreed in writing by the Director, provided that this licence shall not extend to the Developer's successors in title or assigns unless otherwise agreed in writing by the Director prior to that successor or assignee commencing work in the public highway

5.4 The Developer covenants with the County Council not to commence the Highway Works set out in Schedule III unless road space has first been booked with the County Council

5.5 The Developer covenants with the County Council as highway authority to give written notice not less than three calendar months prior to works commencing, in order that the County Council as highway authority has sufficient time to ensure that the commencement of works will cause the least disruption possible to road users and the County Council reserves the right to refuse consent and/or to stop or require the stopping of works under the terms of this Agreement and relevant legislation where the aforesaid notice period is not complied with

5.6 The Developer covenants with the County Council as highways authority to comply with the provisions of the New Roads and Street Works Act 1991, the Traffic Management Act 2004 and any amendments thereof

5.7 The County Council covenants with the Developer that on the date of issue of the Certificate of Final Completion the roads subject to the Highway Works shall thenceforth be, to the extent they are not already, adopted as highways maintainable at the public expense

6 THIRD PARTY RIGHTS

6.1 It is hereby agreed and declared that the provisions of Contracts (Rights of Third Parties) Act 1999 shall not apply to this Agreement

7 LAPSE

7.1 If the Highway Works have not been commenced within one (1) year from the date of this Agreement, save as this period is otherwise extended in writing by the Director at his discretion, then this Agreement shall lapse and be of no further effect (save to the extent already complied with) and the Developer agrees to pay to the County Council any costs properly

incurred by the County Council prior to the lapse of this Agreement (which have not already been paid) including but not limited to those costs set out in paragraph 19 of Schedule I to this Agreement

7.2 Where, in accordance with clause 7.1 above the Director, at his discretion, agrees in writing to an extension to the period of one (1) year after which this Agreement shall lapse, this Agreement shall lapse at the end of such period as agreed in writing by the Director where the Highway Works have not been commenced by the expiry of that extension period

In witness whereof this Agreement has been executed and delivered as a Deed on the date first written above

The COMMON SEAL of)
SUFFOLK COUNTY COUNCIL)
was hereunto affixed)
in the presence of)



Anna Mulholland
A Duly Authorised Officer

EXECUTED AS A DEED
by **HILLS RESIDENTIAL
CONSTRUCTION
LTD** in the presence of:

Name: MATT ROLLINGS

STEPHEN WILLIAMS

Address: 456 IPSWICH ROAD, COLCHESTER, Essex

Occupation: ARCHITECT

Director:

SCHEDULE I

1 THE DESIGN OF THE HIGHWAY WORKS

1.1 The design of the Highway Works shall be to the satisfaction of the Director with due consideration of the Technical Standards

1.2 No work on any of the Highway Works shall commence and no Contract for their construction shall be let until

1.2.1 full details of the design of the Highway Works to be commenced in the form of plans, drawings, specifications and other materials have been submitted to the Director together with the name of the principal designer (whom the Developer shall appoint for the full duration of the design and construction of each and all of the Highway Works) in accordance with the CDM Regulations and any codes of practice referred to therein

1.2.2 the Director has given his written approval to the Highway Works to be commenced and such approval shall not be given if the said plans, drawings, specifications and other documentation have not adequately addressed the issues raised in the pre-construction stages of the Road Safety Audit process and if given shall lapse if the Highway Works are not commenced within twelve (12) months of the date of the said Director's approval

1.2.3 preliminary proposals, detailed contract drawings, schedules and specifications for Highway Structures have been prepared by the Developer and submitted for written approval to the Director's Bridge Office in accordance with Department for Transport Document BD2/12 and the structural design and checking procedure has been carried out by an incorporated or chartered engineer familiar with Department for Transport Codes of Practice and experienced in the design of Highways Structures. The documents are to be agreed as applicable with the Director before the design is commenced and details are submitted for approval

- 1.3 If the Director does not propose to give his approval in relation to those matters referred to in paragraph 1.2 of this Schedule he shall in each case as soon as possible in writing inform the Developer and if the Director requires amendments or additions to the plans drawings specifications and other materials referred to in paragraph 1.2 of this Schedule these amendments shall be undertaken by the Developer at his own expense and a revised set of updated documents shall be re-submitted to the Director for his approval
- 1.4 Without prejudice to paragraph 1.2 of this Schedule, the Director shall not give his approval as referred therein until the Developer has paid the sum referred to in paragraph 19.1.3 towards the cost of checking the design of the Highway Works and inspecting the Highway Works. The Highway Works at all times shall be carried out in accordance with the plans, drawings, specifications and other materials which have received the Director's approval referred to in paragraph 1.2 of this Schedule and the Developer shall in the execution of the Highway Works comply or ensure that the Contractor complies with the Technical Standards

2 LETTING OF THE CONTRACT

- 2.1 No Contract shall be let until all traffic management measures have been prepared by the Developer and approved in writing by the Director ("the approved programme") and thereafter each of the Contracts will be offered to an Approved Contractor
- 2.2 The Contract to be let under paragraph 2.1 of this Schedule shall be let under NEC3 suite of contracts (and any amendments thereto shall be approved by the Director) and the Developer shall obtain the agreement of the Contractor to be bound by the agreed drawings in Schedule IV
- 2.3 The Contract shall be awarded by the Developer subject to the Director having first given his written approval to the proposed chartered engineer(s) or other suitably qualified person(s) who shall be independent of the Contractor and will supervise the execution of the Highway Works by the Contractor
- 2.4 The Developer shall not award the Contract unless the Approved Contractor and the Approved Sub-Contractor/s concerned are insured throughout the period of the Contract (such period to include the

maintenance period detailed in paragraph 15.1 of this Schedule) for public liability risks in the sum of at least ten million pounds (£10,000,000) in respect of any single claim and the Developer shall ensure that the Contractor remains so insured throughout the period of the Contract and prior to the commencement of each or all of the Highway Works or any maintenance works carried out in accordance with paragraph 15.1 of this Schedule the Developer shall produce to the Director insurance policies fully covering the Developer's liability in respect of the matters set out in this Agreement

- 2.5 The Developer shall not sub-contract or assign the Contract without the written approval of the Director and any sub-contractor shall be an Approved Sub-Contractor

3 INSPECTION OF THE HIGHWAY WORKS

- 3.1 The Developer shall provide the Director with not less than twenty-four (24) hours nor more than seventy-two (72) hours notice (excluding weekends and bank holidays) of any intended execution of the Highway Works specifying the tasks to be carried out in accordance with the approved programme referred to in paragraph 2.1 of this Schedule
- 3.2 Without prejudice to the approved programme the Developer shall notify the Director in writing at least twenty-eight (28) days prior to the commencement of any work connected with statutory undertaker's equipment
- 3.3 Without prejudice to the approved programme the Developer shall notify the Bridge Office and the Director in writing at least seventy-two (72) hours prior to the commencement of each and every stage of excavation and concrete operations associated with any Highway Structures
- 3.4 The Developer shall during the progress of each and all of the Highway Works give to or procure for the Director and any person or persons duly authorised by him free access to every part of the Highway Works and the Site and permit him or them to inspect the same as they proceed and all materials used or intended to be used therein and shall give effect to any reasonable and proper requirements made or reasonable and proper directions given by the Director to conform to the approved detailed plans

Works Drawings and specification referred to in paragraph 1.2 of this Schedule

- 3.5 The Developer shall not cover up or put out of view any works forming part of the Highway Works without the approval of the Director and shall afford full opportunity for the Director to examine and measure any work which is about to be covered up or put out of view and to examine foundations before permanent work is placed thereon and shall give at least seventy-two (72) hours' notice to the Director whenever any such work or foundations is or are ready or about to be ready for examination
- 3.6 The Director shall without unreasonable delay, unless she considers it unnecessary and advises the Developer accordingly, attend when required by the Developer for the purpose of examining such works or of examining such foundations
- 3.7 The Director shall for the purposes of paragraphs 3.1 to 3.6 be allowed reasonable access and admission to the Highway Works or the places where materials or plant for the Highway Works may be stored or in the course of preparation manufacture or use (unless such access or admission is refused due to circumstances beyond the control of the Developer)

4 TESTING OF MATERIALS

- 4.1 The Developer shall reimburse the County Council for all reasonable costs and expenses whatsoever arising from the operation of paragraphs 4.2 to 4.5
- 4.2 The Director shall require the testing of materials plant and workmanship used or proposed to be used in the Highway Works and in his reasonable discretion have the power to reject any materials plant or workmanship so tested which he may reasonably and properly find to be not in accordance with the approved detailed plans Works Drawings and specification referred to in paragraph 1.2 of this Schedule In relation to Highways Structures the Director will require a schedule of testing to be agreed prior to the commencement of works or any part thereof
- 4.3 The Developer shall as soon as is reasonably practicable replace or repair any materials plant or workmanship which have been found to be

not in accordance with the approved detailed plans Works Drawings and specification referred to in paragraph 1.2 of this Schedule

4.4 The Director shall for the purposes of paragraphs 4.2 to 4.5 be allowed reasonable access and admission to the Highway Works or the places where materials or plant for the Highway Works may be stored or in the course of preparation manufacture or use (unless such access or admission is refused due to circumstances beyond the control of the Developer)

4.5 The Developer shall as soon as is reasonably practicable remove such materials and plant as are rejected by the Director pursuant to paragraph 4.2. of this Schedule which are not capable of repair or remedy from the Site and if the Developer shall wish to continue to store such rejected materials and plant on the Site they shall be stored separately from those materials and plant which have not been so rejected or which the Developer shall wish in future to use in execution of the Highway Works

5 OPENING OF THE HIGHWAY WORKS

5.1 During the construction of each and all of the Highway Works and prior to the issue of the Certificate of Substantial Completion:

(a) the Director may issue instructions to the Developer to open or expose any of the Highway Works which has been covered up without previously being inspected by the Director

(b) should the Developer fail to comply with any such instructions the County Council may so take up or expose the relevant part of the Highway Works causing as little damage or inconvenience as is possible in respect of any other part or parts of the Highway Works the reasonable and proper cost of such taking up or exposure and reinstatement to be met by the Developer

PROVIDED THAT if the Highway Works or any part or parts thereof are covered up by the Developer after giving the notice referred to in paragraph 3.5 of this Schedule and the Director shall have failed to inspect in the period therein referred to and the Director shall subsequently require the Highway Works or any part of them to be uncovered for the purposes of inspection:-

- (a) if inspection reveals the relevant part or parts of the Highway Works to have been completed in accordance with the approved detailed plans drawings and specification referred to in paragraph 1.2 of this Schedule all costs in respect of such uncovering and inspection and of reinstating the part or parts of the Highway Works uncovered shall be borne by the County Council; or
- (b) if inspection reveals the relevant part or parts of the Highway Works not to have been completed in accordance with the approved detailed plans drawings and specifications referred to in paragraph 1.2 of this Schedule all reasonable and proper costs in respect of uncovering and inspection and of reinstating the part or parts of the Highway Works uncovered shall be borne by the Developer

6 UNDERTAKERS

6.1 Insofar as the County Council as Highway Authority is required by any legislation regulation direction or code of practice (including in particular but without prejudice to the generality of the foregoing the New Roads and Street Works Act 1991) to serve a notice or notices in respect of the Highway Works on undertakers or other persons the Developer shall comply with such requirement on behalf of the County Council before the Highway Works commence and shall thereafter assume on behalf of the County Council such responsibilities as follow on therefrom in particular during the construction of the Highway Works and prior to the issue of the Certificate of Substantial Completion the Developer shall also:-

- (a) carry out or procure the carrying out of such works and activities in regard to the plant and equipment of undertakers as are required by undertakers in accordance with their statutory powers under the New Roads and Street Works Act 1991 as a result of the construction or intended construction of each and all of the Highway Works
- (b) cause all public sewers, highway drains gas and water mains electric cables and telecommunications ducts or other apparatus which are to be laid by the Developer under the Highway Works together with all necessary connections from them to the boundary of the Highway Works to be laid so far as is practicable under the

Highway Works before the foundation of the Highway Works are laid and shall also in so far as is practicable cause the connections from electric cables to any street lamp to be laid before the paving of the footways comprised in the Highway Works is carried out

- (c) cause all trench works within the highway to be backfilled and reinstated in accordance with the Specification for the Reinstatement of Openings in the Highway as determined from time to time under the New Roads and Street Works Act 1991
- (d) not at any time give consent to the erection by any telecommunications operator of telegraph poles or telephone poles or to the erection by any statutory undertaker or public or private company firm or individual of any over ground or underground equipment without the consent in writing of the Director

7 PROTECTION OF THE PUBLIC

- 7.1 The Developer shall give due consideration to adjoining owners and occupiers at all times and shall organise activities relating to the Highway Works in such a manner as to cause the least practicable disruption
- 7.2 Prominent notices shall be displayed and maintained around the perimeter of the site of each and all of the Highway Works to warn the public of the dangers of entering the Site
- 7.3 The Developer shall nominate a member of the site management team as the contact point for the Director in the event of an emergency and shall advise a daytime and twenty-four (24) hour contact number to the Director for the same purpose
- 7.4 The Developer shall take or procure the taking of all necessary steps to avoid creating a nuisance from noise and in particular:
 - 7.4.1 the Developer shall afford all reasonable facilities to enable the Director to carry out such site investigations as she may deem necessary in order to determine noise emission levels
 - 7.4.2 all vehicles and plant including compressors shall be fitted with effective silencers and acoustic covers as appropriate and maintained in good working order and all static plant shall be

located to minimise nuisance to persons living or working in the vicinity

7.4.3 all portable traffic signals and pumps shall be operated from mains electricity unless otherwise agreed with the Director

7.4.4 noisy activities shall not be permitted on Sundays and Bank Holidays and except as agreed in writing by the Director shall not be permitted outside the hours of 9.30 a.m. to 4.30 p.m. Monday to Friday and 9.30 a.m. to 1 p.m. on Saturdays

PROVIDED THAT if in the reasonable opinion of the Director the Developer is not dealing adequately with the control of noise the Developer shall carry out or procure the carrying out of such additional measures as the Director considers necessary at the Developer's expense

7.5 Compliance with the provisions of paragraph 7.4 shall not relieve the Developer of any of his obligations and liabilities under this Agreement the Control of Pollution Act 1974 or the Environmental Protection Act 1990

7.6 The Developer shall take or procure the taking of all necessary steps to avoid creating a nuisance from dust and as far as practicable works are to be carried out in such a way that dust is kept to a minimum PROVIDED THAT if in the reasonable opinion of the Director the Developer is not dealing adequately with the control of dust the Developer shall carry out or procure the carrying out of such additional measures as the Director considers necessary at the Developer's expense

7.7 The Developer shall arrange the regular removal of refuse likely to encourage vermin and arrange for suitable secure storage containers to be provided for collection

7.8 The Developer shall keep a log book on site to record all complaints received from the public and the action taken in response and the log book shall be available for inspection by the Director

8 PREVENTION OF MUD BEING CARRIED ON THE PUBLIC HIGHWAY

- 8.1 Provision shall be made at the Site to limit in so far as is practicable the amount of mud dust and other materials carried on to adjacent public highways by vehicles and plant leaving the Site
- 8.2 The Developer shall keep or procure the keeping of all roads footpaths rights of way and other means of passage leading to or from or crossing the Site free from mud slurry or other hazardous substances that are deposited through the construction of the Highway Works and any such substance so deposited on any such road footpath right of way or other means of passage shall be promptly removed by or at the direction of the Developer
- 8.3 The Director may close any associated crossings entrances and exits if such substances deposited are not promptly removed by the Developer and any losses or expenses incurred as a result shall be borne by the Developer and on removal of such substances the Director shall reopen such crossings entrances and exits and the Developer shall bear the costs incurred

9 TRAFFIC CONTROL

- 9.1 During the periods when the Highway Works are being executed the Developer shall institute at his own expense measures previously approved in writing by the Director to maintain the safe flow of traffic on the highways in the vicinity of the site of the Highway Works
- 9.2 The Highway Works shall be signed and protected to at least the standards of Chapter 8 of the Traffic Signs Manual published by His Majesty's Stationery Office and the proposed arrangements shall be approved in writing by the Director before the Highway Works commence

10 TIMING

- 10.1 No Highway Works within or affecting existing public highways or temporary diversions which could interfere with the traffic flow will be permitted within the morning and evening peak periods i.e. 7.30 - 9.30 a.m. and 4.30 - 6.30 p.m. Monday to Friday except as agreed in writing by the Director

11 SAFETY

11.1 During the periods when the Highway Works are being carried out the Developer shall provide all watching and lighting as required and shall maintain all lights, guards, fencing, warning signs when and, where necessary, undertake such further measures as may be reasonably required by the Director

12 ACCOMMODATION WORKS

12.1 The Developer shall carry out or ensure that there shall be carried out all related accommodation works associated with the Highway Works

13 CONSTRUCTION (DESIGN AND MANAGEMENT) REGULATIONS 2015

13.1 The Developer shall be the only client for the purpose of the CDM Regulations and the Developer agrees to undertake the obligations of a client under the CDM Regulations and to use all reasonable endeavours to ensure that the Highway Works are carried out in accordance with the CDM Regulations

13.2 The Highway Works shall not commence until the Developer as the only client has provided to the Director:

13.2.1 an estimate of the number of working days and/or person days of construction work and the number of workers working on site simultaneously at any one point in the project which the Contract will entail

13.2.2 written details of the principal designer and the principal contractor appointed for the project and also provide copies of the Construction Phase Plan and Health & Safety File

13.2.3 a copy of the Notification of Project (form HSE F10) to the HSE pursuant to Regulation 6 of the CDM Regulations

13.3 Throughout the Highway Works the Developer shall provide to the Director copies of the updates and revisions to the construction phase plan and Health and Safety File pursuant to Regulation 12

13.4 Within twenty-eight (28) days of issue of the Certificate of Substantial Completion for any or all of the Highway Works the Developer shall provide to the Director

- 13.4.1 a plan showing the land over which those Highways Works have been constructed and
 - 13.4.2 a Health and Safety file conforming in all respects with the CDM Regulations and which shall accord with the current format used by the County Council to include a separate Health and Safety File for each Highway Structure
- 13.5 The Director shall be at liberty to delay issue of the Certificate of Final Completion in respect of any of the Highway Works if the Developer fails to provide the Director with the documents referred to in 13.4.1 and 13.4.2 above within twenty-eight (28) days of issue of any Certificate of Substantial Completion for any of the Highway Works equivalent to the number of days after the twenty-eight (28) day period that the documents were submitted
- 13.6 In respect of the Highway Works generally the Developer shall provide to the Director the final information in both paper and electronic format and shall at least comprise:
- 13.6.1 1:500 scale (or alternative scale as may be specified by the Director) "as built" drawings
 - 13.6.2 records of the earthworks showing sources of material used in areas of fill description of fill materials descriptions of sub-grades in cut areas copies of results of tests of material carried out as part of the supervision of the construction of the earthworks
 - 13.6.3 records of the sources of supply of all deliveries of road construction materials with details of the location of the Highway Works at which each load is placed
 - 13.6.4 records of the sources of supply of all other manufactured materials (e.g. drainage goods, fencing materials, traffic signs, electrical components and cables etc).
- 13.7 No work on Highway Structures shall commence until the general Health and Safety file information including format to be supplied in respect of Highway Structures has been agreed with the County Council's Bridge Engineer and shall accord with the County Council's current Technical

Approval Procedure for Highway Structures

13.8 The Developer shall indemnify and keep the County Council indemnified against any breach of the Developer's obligations under this paragraph
13

14 SITE CLEARANCE AND CERTIFICATE(S) OF SUBSTANTIAL COMPLETION

14.1 On Substantial Completion of the Highway Works the Developer shall:-

14.1.1 clear away and remove from the site of the Highway Works all constructional plant and temporary works of every kind and leave the site of the Highway Works in a neat and tidy condition to the satisfaction of the Director and

14.1.2 carry out stage 3 of the Road Safety Audit process and comply to the satisfaction of the Director with recommendations arising thereunder prior to the opening of the Highway Works to the public

14.2. Upon Substantial Completion of the Highway Works including any additional work resulting from stage 3 of the Road Safety Audit process to the satisfaction in all respects of the Director he shall issue a Certificate of Substantial Completion in respect of those Highway Works to the Developer provided that all costs and expenses owing to the County Council have been paid in respect of those Highway Works

14.3. The Developer hereby agrees that on the date of Substantial Completion that part of the Site upon which the Highways Works are constructed which does not currently form part of the public highway shall be dedicated as highway under section 38 of the 1980 Act

14.4. After the issue of the Certificate of Substantial Completion the County Council may approve a reduction of up to 90% of the Performance Figure in respect of the relevant Highway Works and the County Council may release the Developer and the Performance Bond Surety and each of them from their obligations under the Performance Bond in respect of the relevant Highway Works to such extent

15 DEFECTS CORRECTION PERIOD AND CERTIFICATE OF FINAL COMPLETION

- 15.1 The Developer shall maintain each and all of the Highway Works for a period of eighteen (18) months (unless the Director agrees in writing a lesser period having considered paragraph 15.2) from the issue of the related Certificate of Substantial Completion and prior to the expiration of this period the Developer shall reinstate and make good any damage or defect which may have arisen from any cause whatsoever or be discovered during the said period of eighteen months (including any defect in or damage to the surface water drainage system) so as to place the highway and the Highway Works in a condition satisfactory to the Director
- 15.2 After the expiration of the period of twelve (12) months from Substantial Completion or the date the Development becomes operational (whichever is the latter) the Developer shall (unless the Director writes to the Developer informing him that it is to be carried out sooner or that he does not need to do so) carry out stage 4 of the Road Safety Audit and comply to the satisfaction of the Director with any recommendations arising thereunder
- 15.3 After the expiration of the period of eighteen (18) months referred to in paragraph 15.1 (or such lesser period as agreed in writing by the Director under paragraph 15.1) and after any defects have been made good as therein provided including any improvements arising under stage 4 of the Road Safety Audit to the satisfaction of the Director and after the provisions of paragraph 13.4 and paragraph 20.2 of this Schedule have been fulfilled the Director shall issue forthwith to the Developer the Certificate of Final Completion in respect of the Highway Works provided that the Certificate of Final Completion shall in the case of road gullies extend only as far as their points of entry to the surface water sewers where those are not being adopted by the County Council as highway drains and upon the issue of the Certificate of Final Completion the County Council shall release the Developer and the Performance Bond Surety and each of them from all subsisting obligations under the Performance Bond in respect of those Highway Works
- 15.4 If called upon to do so by notice in writing served within twenty-one years of the date hereof by the County Council the Developer agrees to transfer to the County Council in consideration of one pound any land over which

any part of the Highway Works have been constructed which does not at the date of this Agreement already form part of the highway together with any other land dedicated as public highway by the Developer hereunder free in each case from encumbrances and together with all rights necessary to permit the use inspection maintenance repair and replacement of all utility systems servicing the Highway Works and not vested in the relevant undertaker as are situated outside the limits of the Highway Works and the said other land

15.5 Following the issue of the Certificate of Substantial Completion the Developer hereby grants and assigns to the Council for the benefit of the aforementioned highways full right and liberty over such unbuilt part or parts of the Developer's land shown by blue lines and shading on the attached plan 22-030-603 Rev D and 22-030-604 Rev C to use the same for the passage or discharge of surface water from the aforementioned highways and to enter onto such unbuilt part or parts of the Easement Strips to cleanse repair maintain and replace the same and any conveyance of any such part or parts of the Developer's Land shall be expressed to be subject to the Council's easement

16 INDEMNITY

16.1 The Developer shall from the date of this Agreement indemnify the County Council against all claims charges costs expenses liability or loss whatsoever arising out of and incidental to any or all of the Highway Works including but not limited to those arising out of any legally sustainable claims for payments under Section 10 of the Compulsory Purchase Act 1965 and Part I of the Land Compensation Act 1973 (as amended) in connection with those Highway Works provided that the Developer's indemnity will not extend to any claims submitted to the County Council arising out of the negligence of the County Council's employees or arising out of any works of alteration carried out to any of the Highway Works by the County Council after the issue of the related Certificate of Final Completion

16.2 The County Council shall notify the Developer forthwith upon receipt of any such claim or liability

16.3 The County Council shall not accept or settle any claim without first having given the Developer the opportunity to provide the County Council with representations as to the validity of such claim

16.4 The indemnification referred to in paragraph 16.1 includes:

16.4.1 all fees incurred by claimants which the County Council is obliged to pay, and those of the County Council or its agent or contractor, in negotiating any claims (together with VAT payable on the claimants' professional advisors' fees);

16.4.2 statutory interest payments to claimants and their professional advisors; and

16.4.3 the County Council's reasonable and proper legal costs in making the compensation, fees and interest payments

17 PERFORMANCE BOND / PERFORMANCE CASH DEPOSIT

17.1 Without expense to the County Council the Developer and the Performance Bond Surety shall on the date of this Agreement enter into the Performance Bond for each and all of the Highway Works and the Developer and Performance Bond Surety shall be bound to the County Council in the amount of the Performance Figure for the Highway Works

17.2 Should the Developer default in the execution of its obligations to carry out any or all of the Highway Works and to maintain the same in accordance with the provisions of this Agreement then the County Council may (subject to the provisions hereinafter contained) itself carry out the Highway Works and maintain the same as aforesaid having first called upon the Performance Bond Surety for the cost to be expended in so doing

17.2.1 Unless there is a danger to users of the highway the County Council shall give twenty (20) working days prior written notice (or lesser period as may in the circumstances be reasonable) of its intention to commence work under Paragraph 17.2

17.2.2 any notice served under this paragraph shall specify the period of the notice ("the Notice Period") the extent of the work which the County Council proposes to carry out and full details of all

16.3 The County Council shall not accept or settle any claim without first having given the Developer the opportunity to provide the County Council with representations as to the validity of such claim

16.4 The indemnification referred to in paragraph 16.1 includes:

16.4.1 all fees incurred by claimants which the County Council is obliged to pay, and those of the County Council or its agent or contractor, in negotiating any claims (together with VAT payable on the claimants' professional advisors' fees);

16.4.2 statutory interest payments to claimants and their professional advisors; and

16.4.3 the County Council's reasonable and proper legal costs in making the compensation, fees and interest payments

17 PERFORMANCE BOND / PERFORMANCE CASH DEPOSIT

17.1 Without expense to the County Council the Developer and the Performance Bond Surety shall on the date of this Agreement enter into the Performance Bond for each and all of the Highway Works and the Developer and Performance Bond Surety shall be bound to the County Council in the amount of the Performance Figure for the Highway Works

17.2 Should the Developer default in the execution of its obligations to carry out any or all of the Highway Works and to maintain the same in accordance with the provisions of this Agreement then the County Council may (subject to the provisions hereinafter contained) itself carry out the Highway Works and maintain the same as aforesaid having first called upon the Performance Bond Surety for the cost to be expended in so doing

17.2.1 Unless there is a danger to users of the highway the County Council shall give twenty (20) working days prior written notice (or lesser period as may in the circumstances be reasonable) of its intention to commence work under Paragraph 17.2

17.2.2 any notice served under this paragraph shall specify the period of the notice ("the Notice Period") the extent of the work which the County Council proposes to carry out and full details of all

matters in respect of which the Director considers that the Highway Works have not been carried out in accordance with the terms of this Agreement

17.2.3 if before the expiry of the Notice Period the Developer serves written notice upon the County Council that the Developer intends diligently to execute the works specified in the notice in accordance with the terms of this Agreement and specifies a time to complete that the County Council considers reasonable in the circumstances the County Council shall not be entitled to execute the relevant part or parts of the Highway Works specified in the notice served under this paragraph unless the Developer then fails to execute those works within the agreed time scale

17.3 If the Developer should default in the execution of its obligations to carry out any or all of the Highway Works and to maintain the same in accordance with the provisions of this Agreement then the County Council will call upon the Performance Bond Surety to provide the full Performance Figure (or such sum that remains following reduction of the Performance Bond in accordance with Paragraph 14.4 of this Schedule) in accordance with this Agreement. Save that the County Council after all works are completed and all contracts and any contract claims settled will return any Performance Bond sum unused with interest at the Bank of England Base Rate minus 2 basis points, compounding annually at financial year end on receipt of a written request to the Performance Bond Surety within one month of all the aforementioned completing and settling. If for any period the Bank of England Base Rate is at or below 0.02% then no interest shall be payable for that period by any party to this Agreement

18 COMMUTED SUMS FOR MAINTENANCE

18.1 Prior to the date of this Agreement the Developer shall pay to the County Council the Commuted Sums calculated as follows:

	£
Roads	4,099.04

Footways	9,042.30
Street Lighting	11,406.90
Verges, Trees and Street Furniture	5,446.39

19 LEGAL AND ADMINISTRATIVE COSTS

19.1 The Developer shall pay to the County Council:-

19.1.1 the whole of the costs of the County Council's Legal Services Department in connection with the preparation and completion of this Agreement and these costs shall be payable prior to sealing of this Agreement;

19.1.2 interest at four per cent above the Bank of England Base Rate from time to time on any sum due to the County Council under this Agreement which is outstanding for more than twenty-eight (28) days from the date on which it was demanded or in the event that a dispute or difference regarding such payment is referred to arbitration pursuant to clause 4.1 of this Agreement the said twenty-eight (28) day period shall run from the date of the decision of the arbitrator (such interest to be charged on the amount outstanding each day from the date of issue of a written demand for any sum due or in the event that a dispute or difference regarding such payment is referred to arbitration pursuant to clause 4.1 of this Agreement such interest to be charged on the amount outstanding each day from the date of issue of the decision of the arbitrator)

19.1.3 The greater of £5000 (Five thousand pounds) or 7½% of the Performance Figure (excluding the costs associated with statutory undertakers work and traffic management) for the Highway Works towards the costs and expenses of the County Council of checking the design of each and all of the Highway Works and inspecting each and all of the Highway Works such sum shall be payable prior to sealing of this Agreement

19.1.4 the reasonable cost to the County Council of undertaking Road Safety Audits and also the cost of the safety checks of details

submitted which sum shall be payable prior to the safety audit commencing

19.1.5 the cost of any temporary and permanent traffic regulation orders which sum shall be payable prior to any work on the making of such order being commenced

19.1.6 the full cost of any other road traffic orders required to facilitate the Highway Works which sum shall be payable prior to any work on the making of such order being commenced

19.1.7 the whole of the costs of the County Council in connection with surveying and assessing the land upon which the Highways Works are to be constructed and land in the vicinity of the Highway Works as deemed necessary by the County Council in order to provide the Compensation Figure for the Compensation Bond, and these costs shall be payable prior to sealing of this Agreement

20 PARTS I AND II OF THE LAND COMPENSATION ACT 1973

Part I and II Claims

20.1 On the date of this Agreement and without expense to the County Council the Developer shall pay the Compensation Cash Deposit to the County Council

20.2 The Compensation Cash Deposit shall provide that should the Developer default in any way in his obligation to pay to the County Council the sums specified in paragraph 16 of this Schedule the County Council may call upon the Compensation Cash Deposit to pay the sums due under paragraph 16 and paragraph 20.4 of this Schedule to the County Council or any shortfall in the event that some of the monies have already been paid to the County Council

Part I Claims - Depreciation Caused By Public Works

20.3 Upon the date which falls seven (7) years from the point at which the last of the Highway Works is first open to public traffic and if all duly made claims are settled the County Council will release the Developer from all subsisting obligations under the Compensation Cash Deposit and the

remainder of the Cash Deposit shall be returned together with interest as applied at the Bank of England Base Rate minus 2 basis points, compounding annually at financial year end on receipt of a written request. If for any period the Bank of England Base Rate is at or below 0.02% then no interest shall be payable for that period by any party to this Agreement save that if all duly made claims are not settled all but an amount reasonably sufficient to settle such claims will be released

20.4 The Developer hereby undertakes and agrees with the County Council that in the event of any claim for compensation or otherwise or costs or charges arising in connection with or incidental to or in consequence of the carrying out of the Highway Works whether mandatory or discretionary which may be incurred by virtue of any enactment or statutory instrument and otherwise hereby provided for he will hold the County Council fully indemnified from and against all claims charges costs and expenses in connection therewith or arising therefrom

Part II Claims

20.5 The Developer covenants with the County Council to comply with the requirements of the Noise Insulation Regulations 1975 (SI 1975/1763) as amended and to provide to the County Council such evidence as is required by the Director to demonstrate compliance with the Noise Insulation Regulations 1975 prior to the issuing by the County Council of the Certificate of Final Completion in accordance with paragraph 15.3 of this Schedule

SCHEDULE II.A

Performance Bond Agreement

DATED 19 July 2023

HILLS RESIDENTIAL CONSTRUCTION (1)
LTD

- and -

FIDELIS UNDERWRITING LIMITED (2)

PERFORMANCE BOND

relating to the development of land at on the south side of Heath Road, East
Bergholt, Colchester Suffolk

BY THIS BOND HILLS RESIDENTIAL CONSTRUCTION LTD of Bridge Mill House,
Brook Street Business Centre, Brook Street, Colchester CO1 2UZ ("the Developer")
and

FIDELIS UNDERWRITING LIMITED (incorporated in England registered number
09753615 and FCA reference number 709360) whose registered office is at 22
Bishopsgate Level 42, London, England, EC2N 4BQ ("the Surety") are held and
firmly bound to **SUFFOLK COUNTY COUNCIL** of Endeavour House 8 Russell
Road Ipswich Suffolk IP1 2DH ("the County Council") in the sum of £182,357.98 (one
hundred and eighty two thousand three hundred and fifty seven pounds and ninety
eight pence) to be paid to the County Council for the payment of which sum the
Developer and the Surety bind themselves their successors and assigns jointly and
severally

IN WITNESS whereof the Developer and the Surety have hereunto executed and
delivered the same on but not before this 19th day of July Two
thousand and twenty three

1. The Developer has entered into an Agreement under seal with the County Council of even date made under Section 278 of the 1980 Act whereby the Developer undertook at its own expense to carry out works as set out in Schedule III of the said Agreement and shown in the Works Drawings annexed to the said Agreement ("the Highway Works")
2. It is intended that this Bond shall be construed as one with the said Agreement

NOW THE CONDITION of the above-written Bond is such that if the Developer shall duly perform and observe all the terms provisions conditions and stipulations of the said Agreement (in so far as they relate to the Highway Works) on the Developer's part to be performed and observed according to the true intent and meaning thereof or if on default by the Developer the Surety shall duly satisfy and discharge the damages sustained by the County Council up to the amount of the above-written Bond then the above-written Bond shall be null and void but otherwise shall remain in full force and effect **PROVIDED ALWAYS** that the giving by the County Council of any extension of time for performing the said Agreement or any stipulations therein contained and on the part of the Developer to be performed or any other forgiveness or forbearance on the part of the County Council or its successors or assigns shall not in any way release the Surety from any liability under the above-written Bond

EXECUTED AS A DEED)
by **HILLS RESIDENTIAL**)
CONSTRUCTION)
LTD in the presence of:)

Name: MATT ROLLINGS

Address: 456 IPSWICH ROAD, COLCHESTER, ESSEX

Occupation: ARCHITECT



Director/

Secretary

STEPHEN WILLIAMS

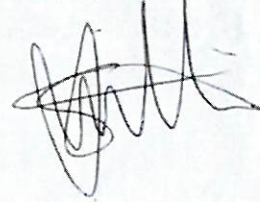

EXECUTED AND DELIVERED as a deed

by

FIDELIS UNDERWRITING LIMITED)

in the presence of:)



.....
(Signature)

MIKE MICHAEL SMITH

Authorized Signatory

Full Name

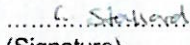
Pursuant to a Power of Attorney dated 1st January 2023
AM

.....
(Signature)

GREGORY DANIEL STALLARD

Witness

Full Name

BOND REFERENCE: SS-23-FPG-0

SCHEDULE II.B – not used

SCHEDULE III

The Highways Works comprising the following works:

<u>Location</u>	<u>Works</u>	<u>Delivery Programme</u>
Land on Heath Road and Mill Bank which abuts the Site	Provision of two new site accesses; zebra crossing; traffic calming; new footways with associated street lighting, road signs and road markings	

Timescales: The Highways Works are to be commenced within 12 (twelve) months of the date of this Agreement and completed within 3 (three) months of commencement of the Highway Works

SCHEDULE IV

Approved List of drawings

	Title	Drawing number
1.	S278 General Arrangement Sheet 1.	22-030-201/E
2.	S278 General Arrangement Sheet 2.	22-030-202/D
3.	Signing and Road Markings Sheet 1.	22-030-203/D
4.	Signing and Road Markings Sheet 2.	22-030-204/C
5.	Construction Details Sheet 1.	22-030-501/C
6.	Construction Details Sheet 2.	22-030-502/E
7.	Construction Details Sheet 3.	22-030-503/A
8.	Construction Details Sheet 4.	22-030-504/E
9.	Drawing Number S278 Legal Plan Sheet 1.	22-030-603/D
10.	S278 Legal Plan Sheet 2.	22-030-604/C
11.	Street Lighting	SL01/0001/S278/ZEBRAEASTBER GHOLT
12.	Site Location Plan	170120/P75/01

1. All drawings are based on the latest available aerial photography and other information contained on this drawing. The client is responsible for providing accurate and up-to-date information. The client is responsible for providing accurate and up-to-date information. The client is responsible for providing accurate and up-to-date information.

1. All drawings are based on the latest available aerial photography and other information contained on this drawing. The client is responsible for providing accurate and up-to-date information. The client is responsible for providing accurate and up-to-date information. The client is responsible for providing accurate and up-to-date information.
2. All drawings are based on the latest available aerial photography and other information contained on this drawing. The client is responsible for providing accurate and up-to-date information. The client is responsible for providing accurate and up-to-date information. The client is responsible for providing accurate and up-to-date information.
3. All drawings are based on the latest available aerial photography and other information contained on this drawing. The client is responsible for providing accurate and up-to-date information. The client is responsible for providing accurate and up-to-date information. The client is responsible for providing accurate and up-to-date information.
4. All drawings are based on the latest available aerial photography and other information contained on this drawing. The client is responsible for providing accurate and up-to-date information. The client is responsible for providing accurate and up-to-date information. The client is responsible for providing accurate and up-to-date information.
5. All drawings are based on the latest available aerial photography and other information contained on this drawing. The client is responsible for providing accurate and up-to-date information. The client is responsible for providing accurate and up-to-date information. The client is responsible for providing accurate and up-to-date information.
6. All drawings are based on the latest available aerial photography and other information contained on this drawing. The client is responsible for providing accurate and up-to-date information. The client is responsible for providing accurate and up-to-date information. The client is responsible for providing accurate and up-to-date information.
7. All drawings are based on the latest available aerial photography and other information contained on this drawing. The client is responsible for providing accurate and up-to-date information. The client is responsible for providing accurate and up-to-date information. The client is responsible for providing accurate and up-to-date information.
8. All drawings are based on the latest available aerial photography and other information contained on this drawing. The client is responsible for providing accurate and up-to-date information. The client is responsible for providing accurate and up-to-date information. The client is responsible for providing accurate and up-to-date information.
9. All drawings are based on the latest available aerial photography and other information contained on this drawing. The client is responsible for providing accurate and up-to-date information. The client is responsible for providing accurate and up-to-date information. The client is responsible for providing accurate and up-to-date information.
10. All drawings are based on the latest available aerial photography and other information contained on this drawing. The client is responsible for providing accurate and up-to-date information. The client is responsible for providing accurate and up-to-date information. The client is responsible for providing accurate and up-to-date information.

LEGEND

- PROPOSED**
- Proposed 500 Series Road Markings
 - Proposed 204 Series Road Markings
 - Proposed 201 & 202 Series Road Markings
 - Proposed 501, 502, 503 & 504 Series Road Markings
 - Proposed 201 & 202 Series Road Markings
 - Proposed 203 & 204 Series Road Markings
 - Proposed 501, 502, 503 & 504 Series Road Markings
 - Proposed 201 & 202 Series Road Markings
 - Proposed 203 & 204 Series Road Markings
 - Proposed 501, 502, 503 & 504 Series Road Markings

FIDELIS

ICENI CONSULTING

HEATH ROAD EAST BERGHOLT SUFFOLK

hillsbuildinggroup

SECTION 278
SIGNING & ROAD MARKING
LAYOUT SHEET 1 OF 2

DATE: JULY 2022
DRAWN BY: [Name]
CHECKED BY: [Name]
APPROVED BY: [Name]

PRELIMINARY

22-030/203

Refer to Icen drawings:
201 & 202 for General Arrangement
203 & 204 for Signing & Road Markings
501, 502, 503 & 504 for Construction Details

Refer to Icen drawings:
201 & 202 for General Arrangement
203 & 204 for Signing & Road Markings
501, 502, 503 & 504 for Construction Details

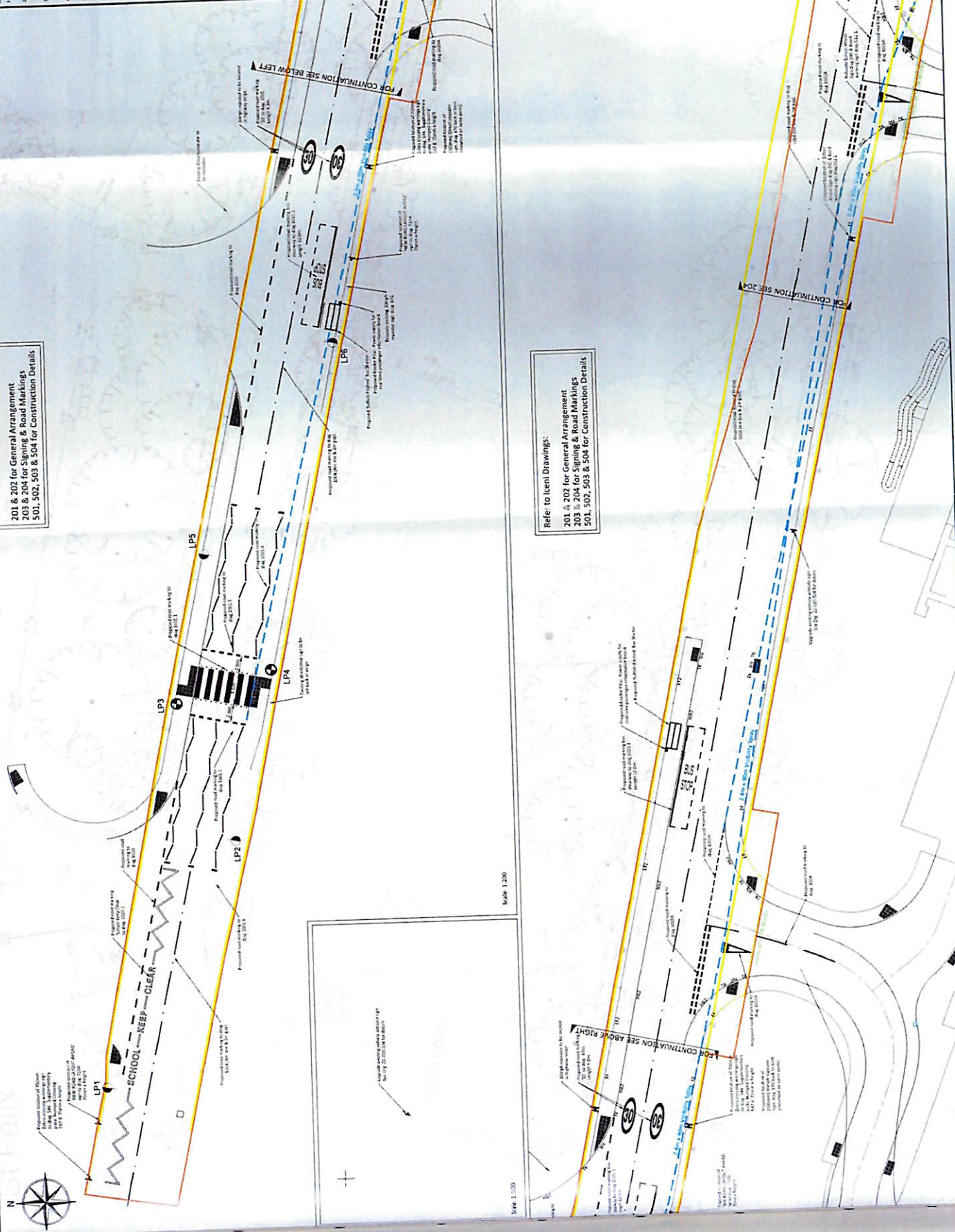

Scale: 1:200

Scale: 1:200

FOR CONTINUATION SEE 203

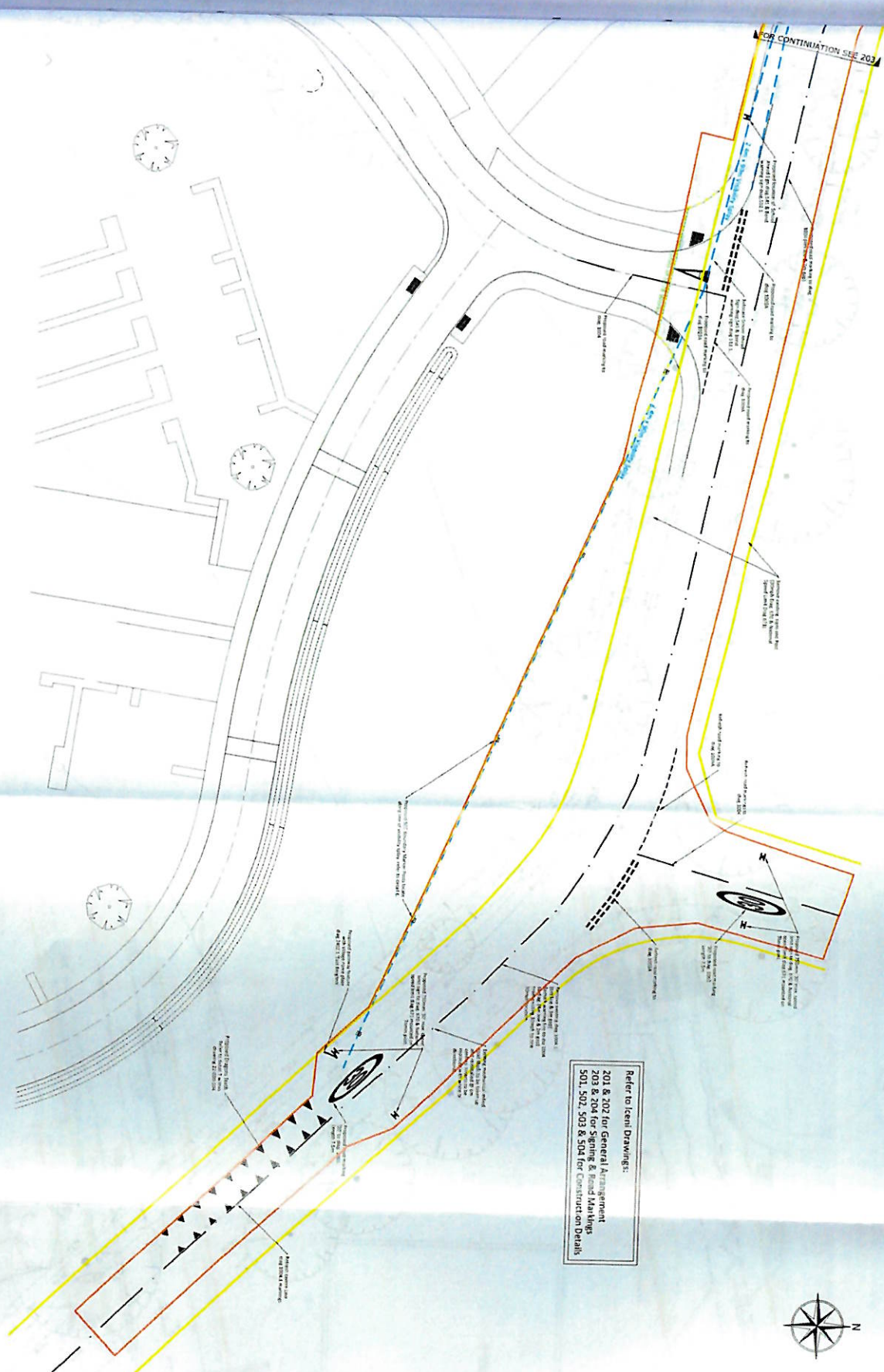

Refer to Isent Drawings:
 201 & 202 for General Arrangement
 203 & 204 for Signing & Road Marking
 501, 502, 503 & 504 for Construction Details



The information is the property of the drawing office. It is not to be used for any other purpose without the written consent of the drawing office. The drawing office is not responsible for any errors or omissions in the drawing. The drawing office is not responsible for any damage or loss of property resulting from the use of the drawing. The drawing office is not responsible for any liability incurred by the use of the drawing. The drawing office is not responsible for any loss of profit or business resulting from the use of the drawing. The drawing office is not responsible for any loss of income or revenue resulting from the use of the drawing. The drawing office is not responsible for any loss of reputation or credit resulting from the use of the drawing. The drawing office is not responsible for any loss of goodwill or other intangible assets resulting from the use of the drawing. The drawing office is not responsible for any loss of time or opportunity resulting from the use of the drawing. The drawing office is not responsible for any loss of interest or dividends resulting from the use of the drawing. The drawing office is not responsible for any loss of honor or respect resulting from the use of the drawing. The drawing office is not responsible for any loss of peace of mind or tranquility resulting from the use of the drawing. The drawing office is not responsible for any loss of sleep or rest resulting from the use of the drawing. The drawing office is not responsible for any loss of health or vitality resulting from the use of the drawing. The drawing office is not responsible for any loss of life or limb resulting from the use of the drawing. The drawing office is not responsible for any loss of soul or spirit resulting from the use of the drawing. The drawing office is not responsible for any loss of heaven or hell resulting from the use of the drawing. The drawing office is not responsible for any loss of paradise or purgatory resulting from the use of the drawing. The drawing office is not responsible for any loss of heaven or hell resulting from the use of the drawing. The drawing office is not responsible for any loss of paradise or purgatory resulting from the use of the drawing.

LEGEND

PROPOSED

1. Proposed Road Markings
 2. Proposed Road Signs
 3. Proposed Road Layout
 4. Proposed Road Width
 5. Proposed Road Gradient
 6. Proposed Road Surface
 7. Proposed Road Drainage
 8. Proposed Road Lighting
 9. Proposed Road Fencing
 10. Proposed Road Planting

ICENI CONSULTING
 14 Sturminster Road
 Lulworth, Dorset, DT24 8JF
 Tel: 01305 371111
 Fax: 01305 371112
 Email: info@iceni.co.uk
 www.iceni.co.uk

FIDELIS
 14 Sturminster Road
 Lulworth, Dorset, DT24 8JF
 Tel: 01305 371111
 Fax: 01305 371112
 Email: info@iceni.co.uk
 www.iceni.co.uk

hillsbuilding group
 Heath Road
 East Bergholt
 Suffolk

SECTION 278
SIGNING & ROAD MARKING
LAYOUT SHEET 2 OF 2
PRELIMINARY

22-01/01/2014

Refer to IcenI Drawings:
 201 & 202 for General Arrangement
 203 & 204 for Signaling & Road Markings
 501, 502, 503 & 504 for Construction Details

SCHOOL — KEEP CLEAR

FOR CONTINUATION SEE BELOW LEFT

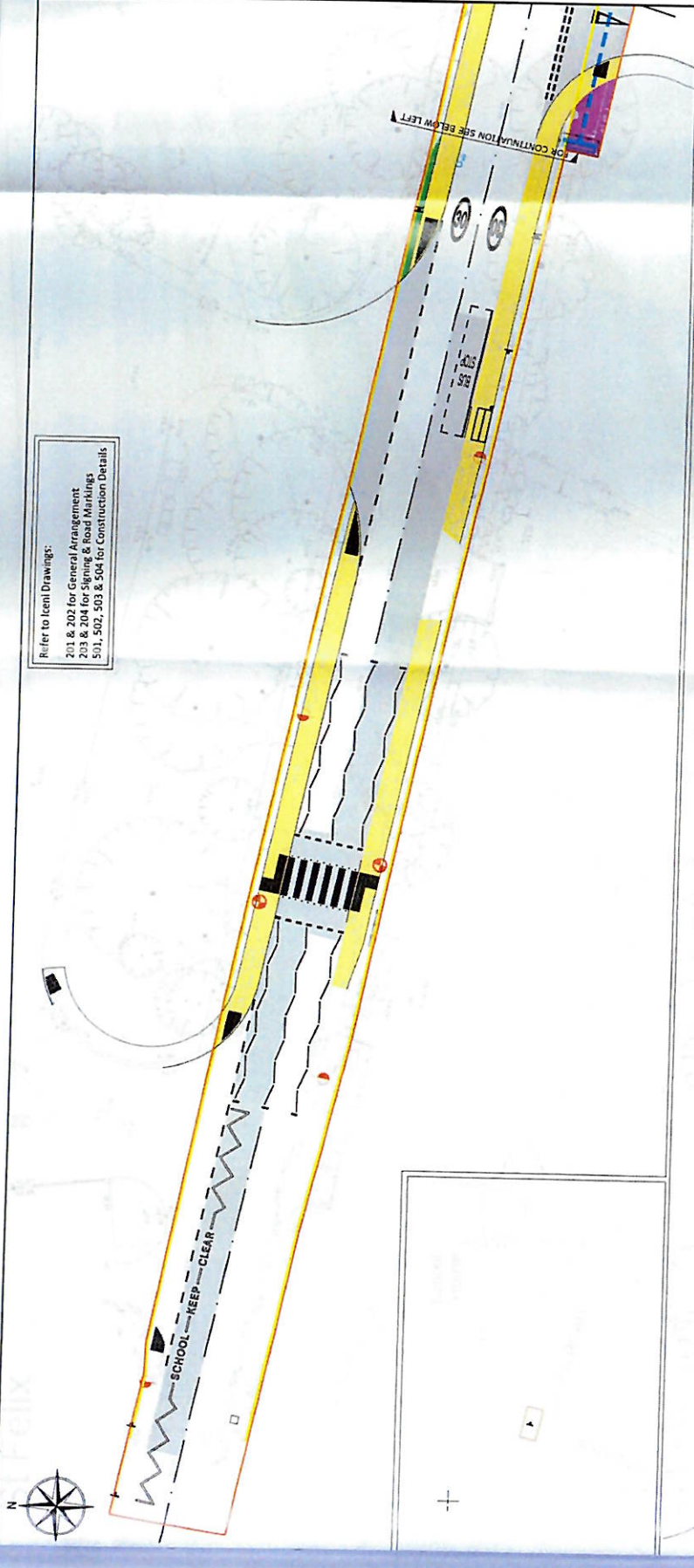

Refer to IcenI Drawings:
 201 & 202 for General Arrangement
 203 & 204 for Signaling & Road Markings
 501, 502, 503 & 504 for Construction Details

FOR CONTINUATION SEE ABOVE RIGHT



NOTES
 1. All drawings are subject to the following conditions:
 a. The design is based on the information provided to IcenI by the client and is based on the information provided to IcenI by the client and is based on the information provided to IcenI by the client.
 b. IcenI does not accept responsibility for the accuracy of the information provided to IcenI by the client.
 c. IcenI does not accept responsibility for the accuracy of the information provided to IcenI by the client.

LEGEND

EXISTING	PROPOSED
Existing highway boundary	Proposed highway boundary
Proposed highway boundary	Proposed highway boundary
Proposed highway boundary	Proposed highway boundary
Proposed highway boundary	Proposed highway boundary
Proposed highway boundary	Proposed highway boundary
Proposed highway boundary	Proposed highway boundary
Proposed highway boundary	Proposed highway boundary

ICENI CONSULTING
 IcenI Consulting (Anglo) Limited
 200 St. Mary Street, Ipswich, Suffolk IP1 2DU
 Telephone: +44 (0)1473 606100
 Fax: +44 (0)1473 606101
 Email: info@iceni.co.uk

hillsbuildinggroup
 Hillside House, Wood Street, Ipswich, Suffolk
 Telephone: +44 (0)1473 606100

SECTION 278 LEGAL PLAN
SHEET 1 OF 2

Scale: 1:100
 Date: SEPT 2022
 Drawn: AL
 Checked: JMD

PRELIMINARY

22-030/603
 Rev: 0
 D

FOR CONTINUATION SEE 603



Refer to Icm Drawings:
 201 & 202 for General Arrangement
 203 & 204 for Signing & Road Markings
 301, 302, 303 & 304 for Construction Details

This drawing is the property of Hills Building Group and is not to be used for any other project without the written consent of Hills Building Group. It is to be used only for the project and site described herein. It is not to be used for any other purpose without the written consent of Hills Building Group. It is not to be used for any other project without the written consent of Hills Building Group. It is not to be used for any other purpose without the written consent of Hills Building Group.

LEGEND

EXISTING

- Existing Footpath
- Existing Road
- Existing Boundary
- Existing Drainage
- Existing Tree
- Existing Building
- Existing Wall
- Existing Fence
- Existing Gate
- Existing Light
- Existing Sign
- Existing Pole
- Existing Post
- Existing Foundation
- Existing Foundation Extension
- Existing Foundation Replacement
- Existing Foundation Removal
- Existing Foundation Underpinning
- Existing Foundation Strengthening
- Existing Foundation Repair
- Existing Foundation Replacement
- Existing Foundation Removal
- Existing Foundation Underpinning
- Existing Foundation Strengthening
- Existing Foundation Repair

PROPOSED

- Proposed Footpath
- Proposed Road
- Proposed Boundary
- Proposed Drainage
- Proposed Tree
- Proposed Building
- Proposed Wall
- Proposed Fence
- Proposed Gate
- Proposed Light
- Proposed Sign
- Proposed Pole
- Proposed Post
- Proposed Foundation
- Proposed Foundation Extension
- Proposed Foundation Replacement
- Proposed Foundation Removal
- Proposed Foundation Underpinning
- Proposed Foundation Strengthening
- Proposed Foundation Repair

ICEN CONSULTING
 14 Wickham Road
 Eastleigh, Hampshire
 SO50 9JG
 Tel: 01703 606000
 Fax: 01703 606001
 Email: info@icenconsulting.co.uk
 Website: www.icenconsulting.co.uk

hills building group
 14 Wickham Road
 Eastleigh, Hampshire
 SO50 9JG
 Tel: 01703 606000
 Fax: 01703 606001
 Email: info@hillsbuildinggroup.co.uk
 Website: www.hillsbuildinggroup.co.uk

FIDELIS
 14 Wickham Road
 Eastleigh, Hampshire
 SO50 9JG
 Tel: 01703 606000
 Fax: 01703 606001
 Email: info@fidelis.co.uk
 Website: www.fidelis.co.uk

**HEATH ROAD
 EAST BERGHOLT
 SUFFOLK**

**SECTION 278 LEGAL PLAN
 LAYOUT SHEET 2 OF 2**

PRELIMINARY

Drawn By: [Name]
 Checked By: [Name]
 Date: [Date]

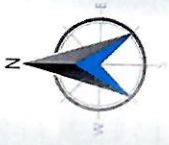

[Handwritten signature]

C. Steward

[Handwritten signature]

Project No. 10105870
Date: 11/15/2010





DETAIL 1 - SECTION THROUGH 450mm Ø CONCRETE CULVERT
SCALE 1:25

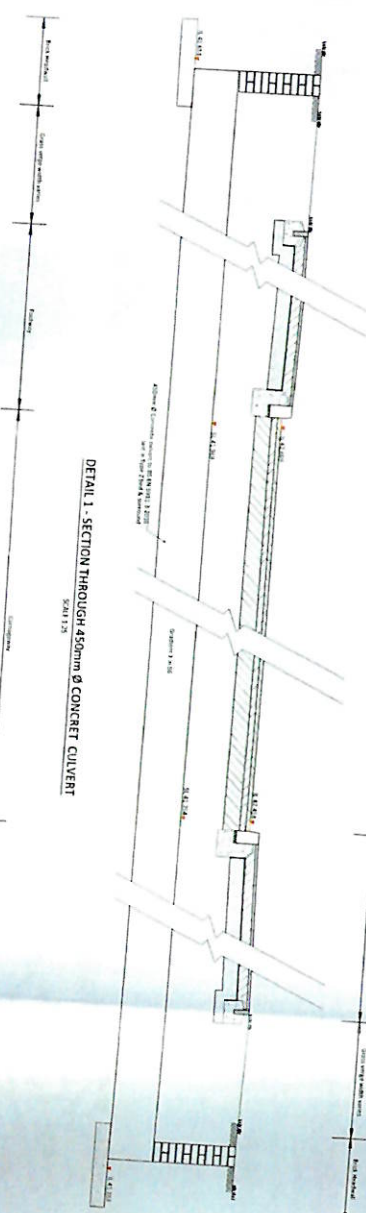

DETAIL 2 - SECTION THROUGH 450mm Ø CONCRETE CULVERT
SCALE 1:25

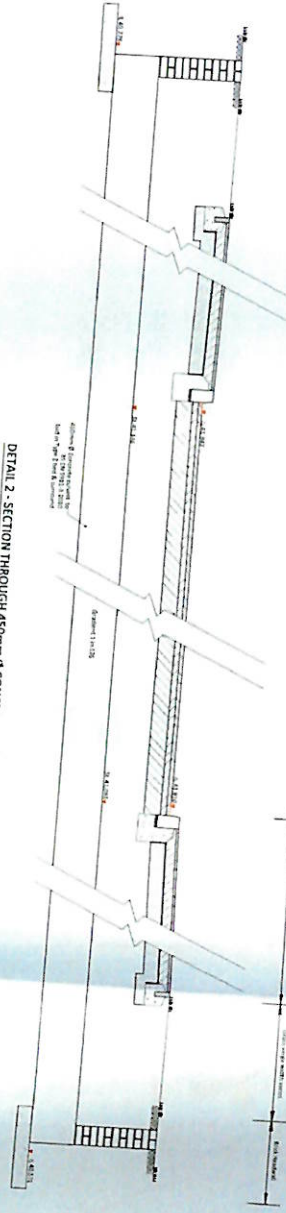

DETAIL 3 - SECTION THROUGH FOOTWAY WIDENING & 450mm Ø CONCRETE CULVERT
SCALE 1:25

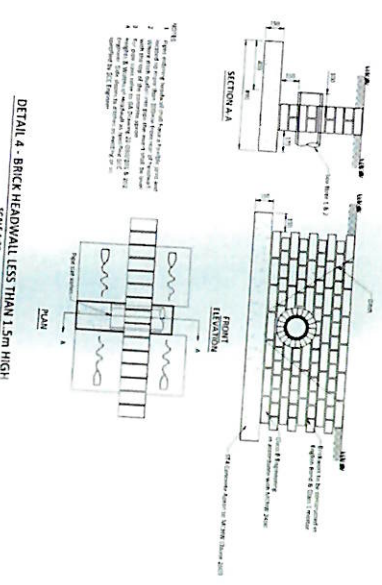

DETAIL 4 - BRICK HEADWALL LESS THAN 1.5m HIGH
SCALE 1:20

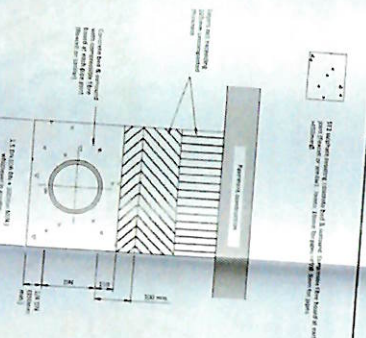

CONCRETE BED AND SURROUND - CLASS 2
PIPER AND GULLEY CONSTRUCTION DETAILS
THAN 1.2m COVER ON TYPICAL ROAD
SCALE 1:20

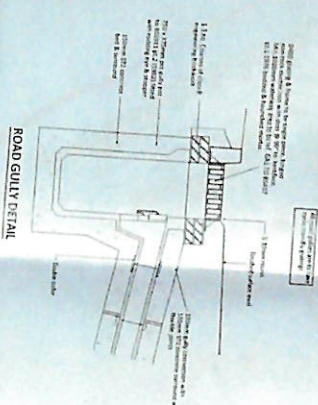

ROAD GULLY DETAIL
N/S

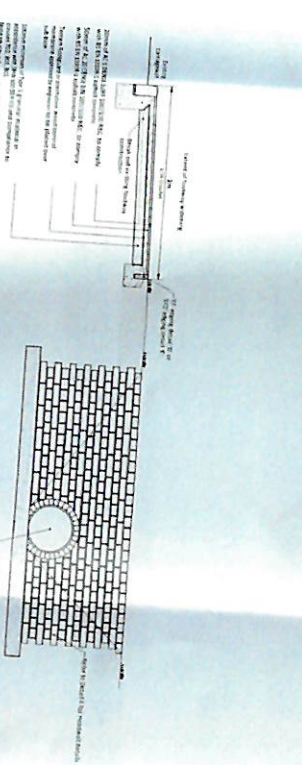

DETAIL 4 - BRICK HEADWALL LESS THAN 1.5m HIGH
SCALE 1:20

1. The work shown on this drawing is to be constructed in accordance with the specifications and standards of the Institution of Civil Engineers (ICE) and the British Standards Institution (BSI).
2. The work shown on this drawing is to be constructed in accordance with the specifications and standards of the Institution of Civil Engineers (ICE) and the British Standards Institution (BSI).
3. The work shown on this drawing is to be constructed in accordance with the specifications and standards of the Institution of Civil Engineers (ICE) and the British Standards Institution (BSI).
4. The work shown on this drawing is to be constructed in accordance with the specifications and standards of the Institution of Civil Engineers (ICE) and the British Standards Institution (BSI).
5. The work shown on this drawing is to be constructed in accordance with the specifications and standards of the Institution of Civil Engineers (ICE) and the British Standards Institution (BSI).
6. The work shown on this drawing is to be constructed in accordance with the specifications and standards of the Institution of Civil Engineers (ICE) and the British Standards Institution (BSI).
7. The work shown on this drawing is to be constructed in accordance with the specifications and standards of the Institution of Civil Engineers (ICE) and the British Standards Institution (BSI).
8. The work shown on this drawing is to be constructed in accordance with the specifications and standards of the Institution of Civil Engineers (ICE) and the British Standards Institution (BSI).
9. The work shown on this drawing is to be constructed in accordance with the specifications and standards of the Institution of Civil Engineers (ICE) and the British Standards Institution (BSI).
10. The work shown on this drawing is to be constructed in accordance with the specifications and standards of the Institution of Civil Engineers (ICE) and the British Standards Institution (BSI).

 e. secured
 J.S. v. l.

ICENI CONSULTING
 11 South In Way
 South, IP7 9JZ
 www.iceni-consulting.co.uk
 info@iceni-consulting.co.uk

hills building group
 4100 117th Street
 Chesapeake Beach, MD 20746
 410.321.1177

HEATH ROAD EAST BERGHOLT SUFFOLK

SECTION 278 CONSTRUCTION DETAILS SHEET 1 OF 4

10/01/2017
 10/01/2017
 10/01/2017
 10/01/2017



STREET LIGHTING LEGEND:-

SUPPLY & INSTALL NEW 1000MM GALVANIZED TUBULAR STEEL LIGHTING COLUMN COMPLETE WITH GLASS FLAKE ROOF & 1100 POST TOP WHITE TELENA TELECELL WITH 22 OPTIC COLLAR. (DRAWN DIMENSIONAL ELECTRIC LANTERN WITH 22 OPTIC COLLAR WITH 1 PART PHOTOCELL CLEAR FACTORY FITTED WITH COL CHANGES ENGRG 13 DOUBLE TELENA TELECELL UNIT SPECIFICATION TO CURRENT SUFFOLK COUNTY COUNCIL DIMENSIONS). INDUSTRY LED WRAP AROUND STYLE BRILINA HEAD ON TO BE MOUNTED ON THE LIGHTING COLUMN AT A HEIGHT OF APPROXIMATELY 2.4M TO GROUND LEVEL. COLUMN TO ALSO HAVE TOP COAT TO GROUND LEVEL. 2.3m ABOVE GROUND WHITE HOODED BAYES (BLACK COATED) WITH 1.5m PER BRITISH STANDARD IN 6 SQUARE METRE TELENA TELECELL COLUMN. SUPPLIES TO HAVE NEW STATUTORY MAINS ELECTRICITY.

SUPPLY AND INSTALL NEW 1000MM GALVANIZED TUBULAR STEEL LIGHTING COLUMN COMPLETE WITH GLASS FLAKE ROOF AND 1100 POST TOP MOUNTED CIP PHOTO CELL 22 OPTIC COLLAR WITH RIA COATED FITTING. COMPLETE WITH DIMENSIONAL ELECTRONIC COLLAR. PHOTOCELL CLEAR FACTORY FITTED WITH SOCKET 1 PART PHOTOCELL WITH TELENA TELECELL UNIT AND CHANGES ENGRG 13 DOUBLE TELENA TELECELL UNIT AND SUPPLIES TO HAVE NEW STATUTORY MAINS ELECTRICITY.

#NOTE: TELENA TELECELLS AND SUFFOLK COUNTY COUNCIL IDENTIFIED LANTERN PLATES ARE TO BE INSTALLED AND ILLUMINATED USING STREET LIGHTING LANTERN AND CONTRACTOR UPON ACCEPTANCE OF STREET LIGHTING (APPROXIMATELY £124 PER LIGHTING UNIT).

PLEASE ENSURE CORRECT LANTERNS ARE INSTALLED ON CORRECT COLUMN AS SPECIFIED ABOVE. A COPY OF THIS DRAWING IS TO BE REFERRED TO THE APPROPRIATE STREET LIGHTING CONTRACTOR AT ALL TIMES.

STREET LIGHTING NOTES:-

1. ALL NEW STREET LIGHTING COLUMNS ARE TO BE INSTALLED WITHIN THE SERVICE REAR OF THE FOOTPATH OR IN THE SERVICE REAR OF THE ROAD UNLESS OTHERWISE INDICATED. THE REAR OF COLUMNS ARE TO BE MARKED WITH A RED REFLECTOR. INDIVIDUAL ADDRESS NUMBERS TO BE MARKED AT THE REAR OF COLUMNS. ADDRESS NUMBERS TO BE MARKED AT THE REAR OF LIGHTING COLUMNS OF A SIMILAR DIAMETER TO LARGE LIGHTING COLUMNS. ADDRESS NUMBERS TO BE MARKED AT THE REAR OF LIGHTING COLUMNS OF A SIMILAR DIAMETER TO LARGE LIGHTING COLUMNS. ADDRESS NUMBERS TO BE MARKED AT THE REAR OF LIGHTING COLUMNS OF A SIMILAR DIAMETER TO LARGE LIGHTING COLUMNS. ADDRESS NUMBERS TO BE MARKED AT THE REAR OF LIGHTING COLUMNS OF A SIMILAR DIAMETER TO LARGE LIGHTING COLUMNS.
2. WHERE ROAD LIGHTING COLUMNS ARE TO BE INSTALLED IN THE SERVICE REAR OF THE ROAD THEY SHALL BE SET BACK FROM THE EDGE OF THE ROAD BY A MINIMUM OF 1.0M. WHERE LIGHTING COLUMNS ARE INSTALLED IN AN AREA WITHIN THE SERVICE REAR OF THE ROAD THEY SHALL BE SET BACK FROM THE EDGE OF THE ROAD BY A MINIMUM OF 1.0M. WHERE LIGHTING COLUMNS ARE INSTALLED IN AN AREA WITHIN THE SERVICE REAR OF THE ROAD THEY SHALL BE SET BACK FROM THE EDGE OF THE ROAD BY A MINIMUM OF 1.0M.
3. WHERE STREET LIGHTING COLUMNS ARE TO BE INSTALLED WITHIN THE SERVICE REAR OF THE ROAD THEY SHALL BE SET BACK FROM THE EDGE OF THE ROAD BY A MINIMUM OF 1.0M. WHERE LIGHTING COLUMNS ARE INSTALLED IN AN AREA WITHIN THE SERVICE REAR OF THE ROAD THEY SHALL BE SET BACK FROM THE EDGE OF THE ROAD BY A MINIMUM OF 1.0M.
4. ALL NEW STREET LIGHTING COLUMNS AND ILLUMINATED SIGNS ARE TO HAVE NEW STATUTORY MAINS ELECTRICITY SUPPLIES UNLESS OTHERWISE INDICATED.
5. NO TREE TRIMMING TO BE PLANNED WITHIN 6M OF ANY NEW STREET LIGHTING UNITS. ENSURE BLOCKING EFFECT ON LIGHTING UNITS IS MINIMIZED.
6. IF NO LIGHTING COLUMNS HAVE BEEN PLANTED WITHIN 18 MONTHS OF LIGHTING DESIGN BEING APPROVED BY THE COUNCIL'S STREET LIGHTING DEPARTMENT FOR RE-CHECKING / RE-APPROVAL.
7. NO CHANGES TO THE POSITIONS OR SPECIFICATION OF ANY LIGHTING EQUIPMENT SHALL BE MADE WITHOUT THE APPROVED STREET LIGHTING DESIGN BEING APPROVED BY THE COUNCIL'S STREET LIGHTING DEPARTMENT FOR RE-CHECKING / RE-APPROVAL.

TREE TRIMMING WILL BE REQUIRED THROUGHOUT THIS AREA TO ENSURE THAT NO STREET LIGHTING UNITS ARE OBSCURED BY FOLIAGE

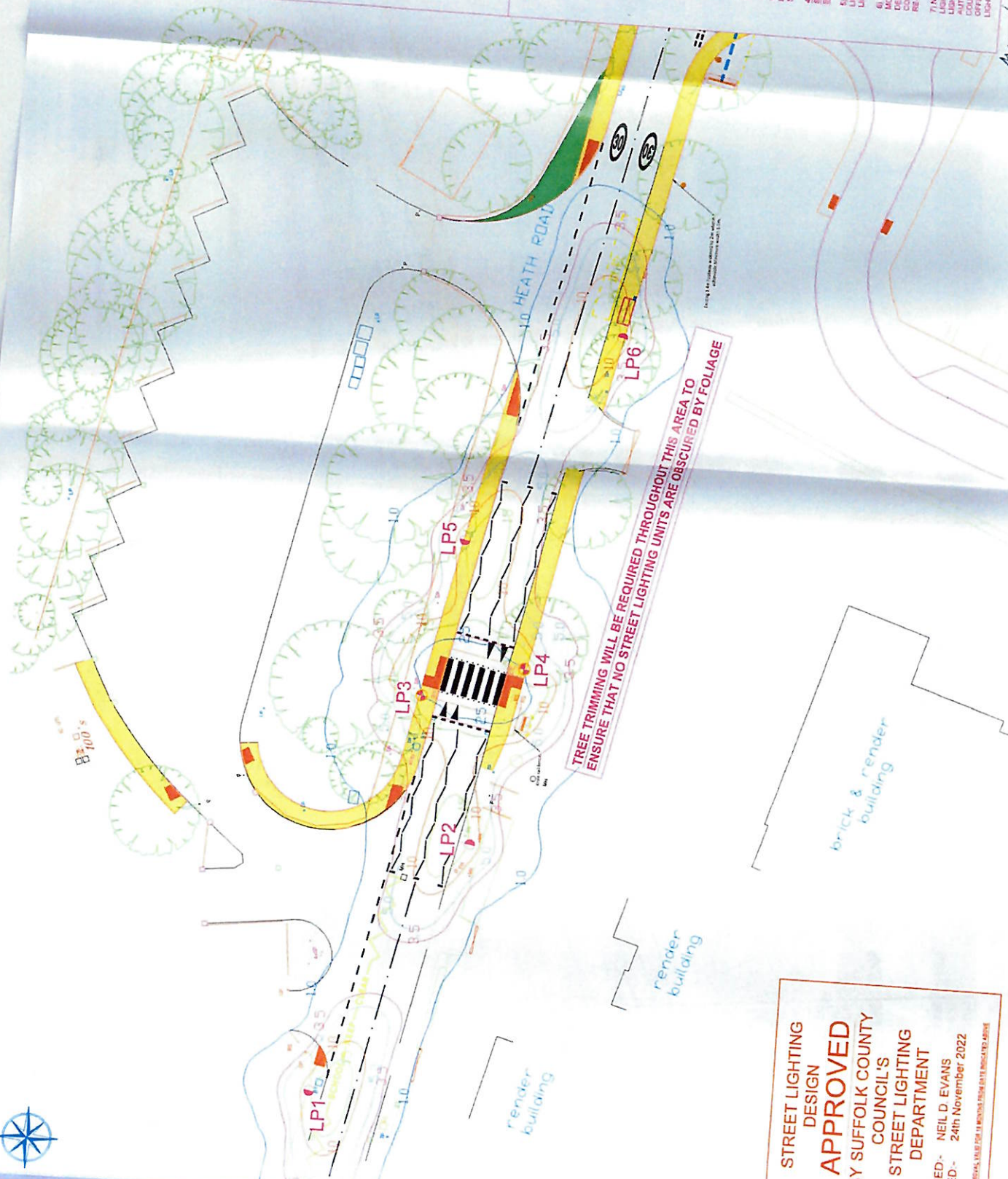

STREET LIGHTING DESIGN APPROVED BY SUFFOLK COUNTY COUNCIL'S STREET LIGHTING DEPARTMENT. SIGNED: NEIL D. EVANS. DATED: 24th November 2022.

DRAWING NO. 24/22. SIGNED: Neil D. Evans. FIDELIS logo.



Folix

LEGEND	
	EXISTING
	PROPOSED
	PROPOSED WITH KERBS
	PROPOSED WITH KERBS AND FOOTWAYS
	PROPOSED WITH KERBS, FOOTWAYS AND CYCLEWAYS
	PROPOSED WITH KERBS, FOOTWAYS, CYCLEWAYS AND GREENWAYS
	PROPOSED WITH KERBS, FOOTWAYS, CYCLEWAYS, GREENWAYS AND PUBLIC SPACES
	PROPOSED WITH KERBS, FOOTWAYS, CYCLEWAYS, GREENWAYS, PUBLIC SPACES AND LANDSCAPING
	PROPOSED WITH KERBS, FOOTWAYS, CYCLEWAYS, GREENWAYS, PUBLIC SPACES, LANDSCAPING AND STREET FURNITURE
	PROPOSED WITH KERBS, FOOTWAYS, CYCLEWAYS, GREENWAYS, PUBLIC SPACES, LANDSCAPING, STREET FURNITURE AND STREET LIGHTING
	PROPOSED WITH KERBS, FOOTWAYS, CYCLEWAYS, GREENWAYS, PUBLIC SPACES, LANDSCAPING, STREET FURNITURE, STREET LIGHTING AND STREET TREES
	PROPOSED WITH KERBS, FOOTWAYS, CYCLEWAYS, GREENWAYS, PUBLIC SPACES, LANDSCAPING, STREET FURNITURE, STREET LIGHTING, STREET TREES AND STREET PLANTING
	PROPOSED WITH KERBS, FOOTWAYS, CYCLEWAYS, GREENWAYS, PUBLIC SPACES, LANDSCAPING, STREET FURNITURE, STREET LIGHTING, STREET TREES, STREET PLANTING AND STREET ART
	PROPOSED WITH KERBS, FOOTWAYS, CYCLEWAYS, GREENWAYS, PUBLIC SPACES, LANDSCAPING, STREET FURNITURE, STREET LIGHTING, STREET TREES, STREET PLANTING, STREET ART AND STREET DESIGN

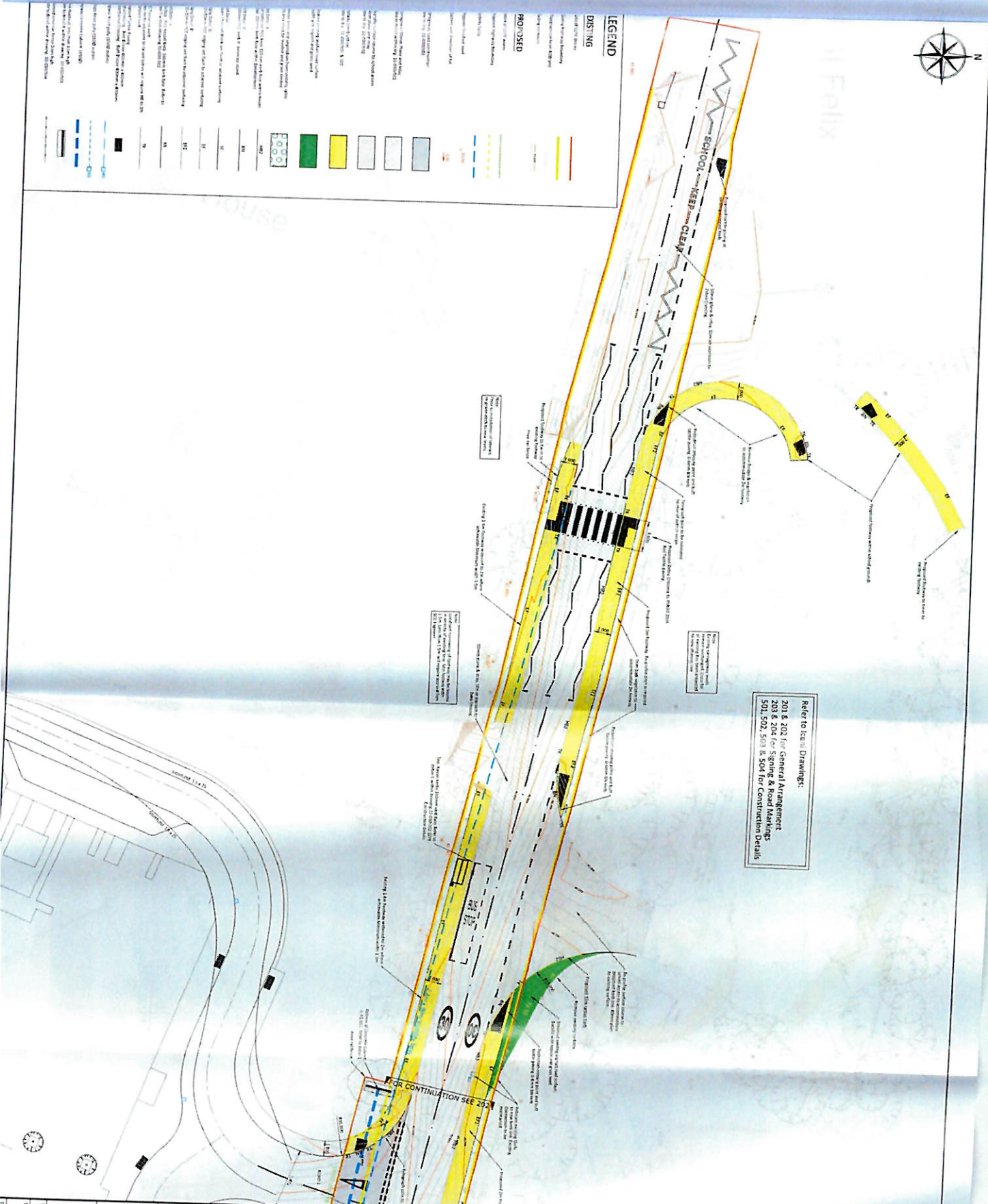

Signature
 G. Stralwd

ICENI CONSULTING
 24 Orchard Road, 2nd Floor, Singapore 238883
 Tel: +65 6339 3333
 Fax: +65 6339 3334
 Email: info@iceni.com.sg
 Website: www.iceni.com.sg

hillsbuildinggroup
 110 Robinson Road, 11th Floor, Singapore 068912
 Tel: +65 6733 3333
 Fax: +65 6733 3334
 Email: info@hillsbuildinggroup.com.sg
 Website: www.hillsbuildinggroup.com.sg

SECTION 278
 GENERAL ARRANGEMENT
 SHEET 1 OF 2
 DATE: 15/01/2022
 SCALE: 1:200
 PRELIMINARY

1. All drawings are for general arrangement only. No dimensions are shown. The contractor shall be responsible for all dimensions and for the construction of the works. The contractor shall be responsible for the construction of the works. The contractor shall be responsible for the construction of the works.

Notes
 1. All drawings are for general arrangement only. No dimensions are shown. The contractor shall be responsible for all dimensions and for the construction of the works. The contractor shall be responsible for the construction of the works. The contractor shall be responsible for the construction of the works.

2. All work shall be done in accordance with the Highway Act 1980 and the Traffic Signs Regulations and General Directions 2002. The contractor shall be responsible for the construction of the works. The contractor shall be responsible for the construction of the works. The contractor shall be responsible for the construction of the works.

3. All work shall be done in accordance with the Highway Act 1980 and the Traffic Signs Regulations and General Directions 2002. The contractor shall be responsible for the construction of the works. The contractor shall be responsible for the construction of the works. The contractor shall be responsible for the construction of the works.

4. All work shall be done in accordance with the Highway Act 1980 and the Traffic Signs Regulations and General Directions 2002. The contractor shall be responsible for the construction of the works. The contractor shall be responsible for the construction of the works. The contractor shall be responsible for the construction of the works.

Bob
 G. Skelton

1. All drawings are for general arrangement only. No dimensions are shown. The contractor shall be responsible for all dimensions and for the construction of the works. The contractor shall be responsible for the construction of the works. The contractor shall be responsible for the construction of the works.

Notes
 1. All drawings are for general arrangement only. No dimensions are shown. The contractor shall be responsible for all dimensions and for the construction of the works. The contractor shall be responsible for the construction of the works. The contractor shall be responsible for the construction of the works.

2. All work shall be done in accordance with the Highway Act 1980 and the Traffic Signs Regulations and General Directions 2002. The contractor shall be responsible for the construction of the works. The contractor shall be responsible for the construction of the works. The contractor shall be responsible for the construction of the works.

3. All work shall be done in accordance with the Highway Act 1980 and the Traffic Signs Regulations and General Directions 2002. The contractor shall be responsible for the construction of the works. The contractor shall be responsible for the construction of the works. The contractor shall be responsible for the construction of the works.

4. All work shall be done in accordance with the Highway Act 1980 and the Traffic Signs Regulations and General Directions 2002. The contractor shall be responsible for the construction of the works. The contractor shall be responsible for the construction of the works. The contractor shall be responsible for the construction of the works.



 Icen Consulting (Anglo) Limited
 15 Brooklands
 Sunningdale
 Berkshire RG40 3AH
 www.iceni.co.uk
 T: 01344 891000

HEATH ROAD
 EAST BERGHOLT
 SUFFOLK



 Hills Building Group
 15 Brooklands
 Sunningdale
 Berkshire RG40 3AH
 T: 01344 891000

SECTION 278
 GENERAL ARRANGEMENT
 SHEET 2 OF 2

Scale	1:200	Drawn By	ML	Checked By	MLP
Date	JULY 2022	Drawn By	ML	Checked By	MLP

PRELIMINARY

Date: 22-03/2022

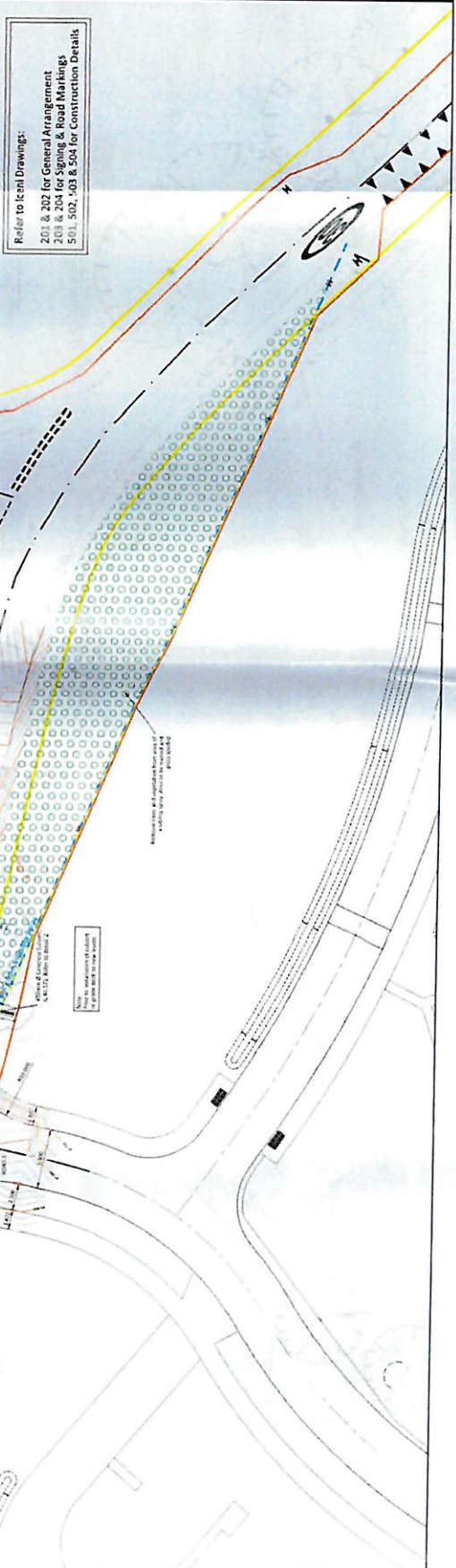
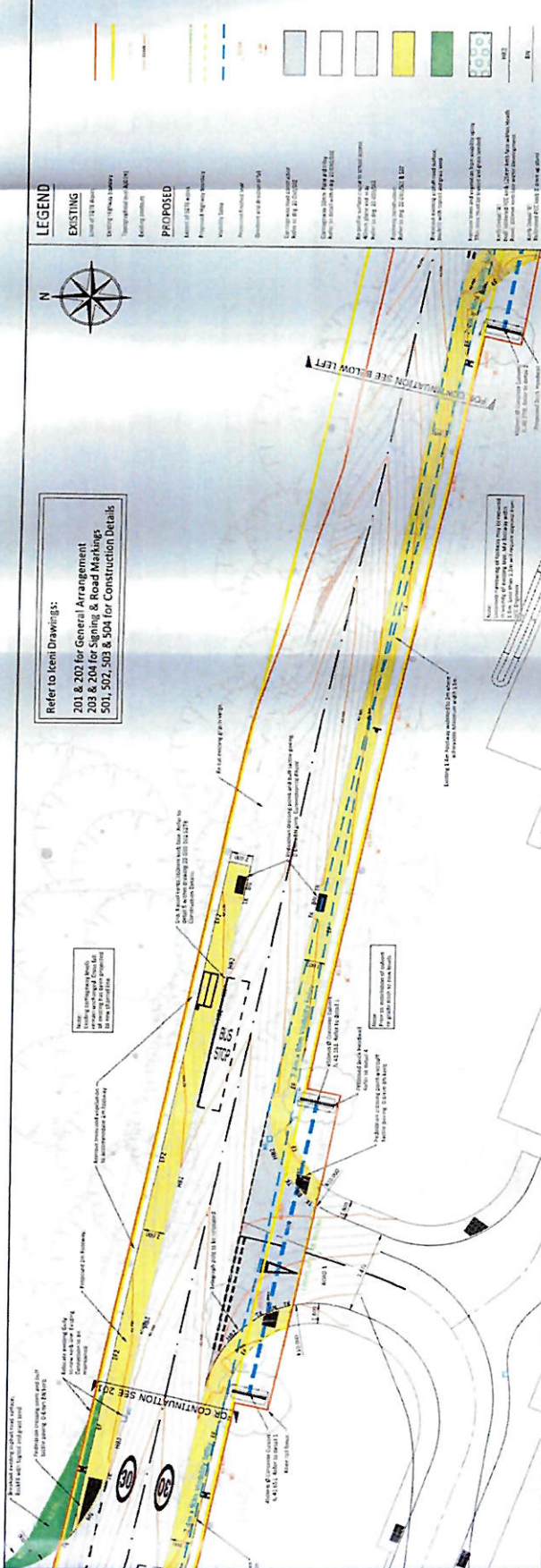

Refer to Icen Drawings:
 201 & 202 for General Arrangement
 203 & 204 for Signing & Road Markings
 501, 502, 503 & 504 for Construction Details

Refer to Icen Drawings:
 201 & 202 for General Arrangement
 203 & 204 for Signing & Road Markings
 501, 502, 503 & 504 for Construction Details

LEGEND

	Proposed Lane Markings		Existing Lane Markings
	Proposed Kerbs		Existing Kerbs
	Proposed Footpaths		Existing Footpaths
	Proposed Trees		Existing Trees
	Proposed Buildings		Existing Buildings
	Proposed Road Width		Existing Road Width
	Proposed Road Markings		Existing Road Markings
	Proposed Road Markings		Existing Road Markings
	Proposed Road Markings		Existing Road Markings
	Proposed Road Markings		Existing Road Markings

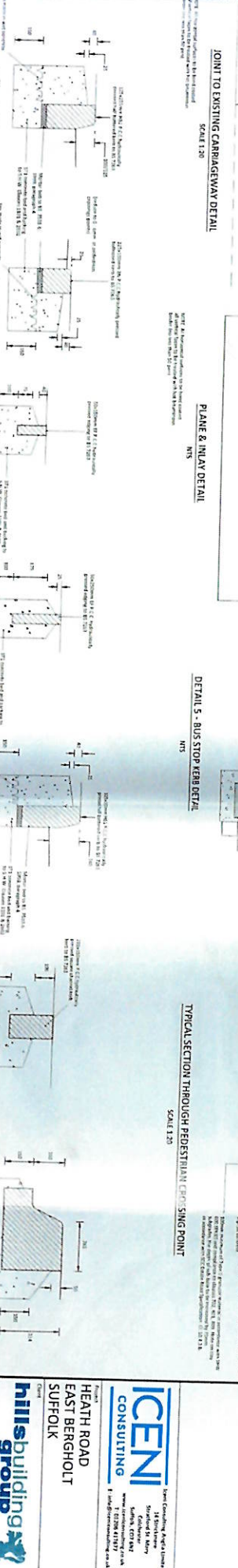
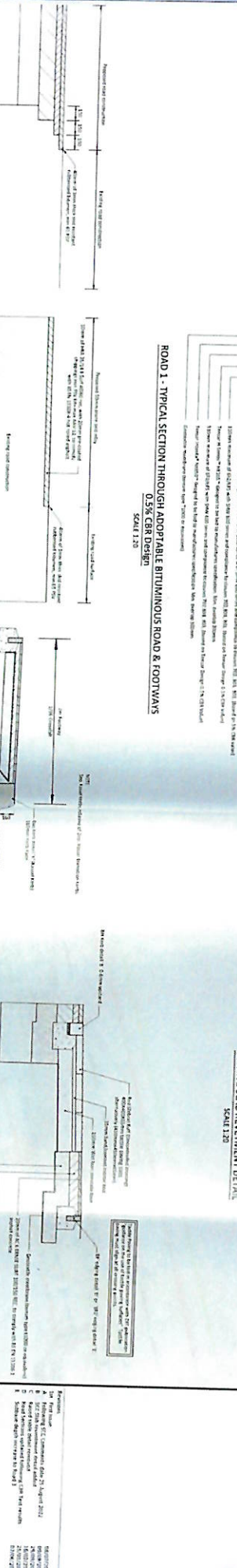
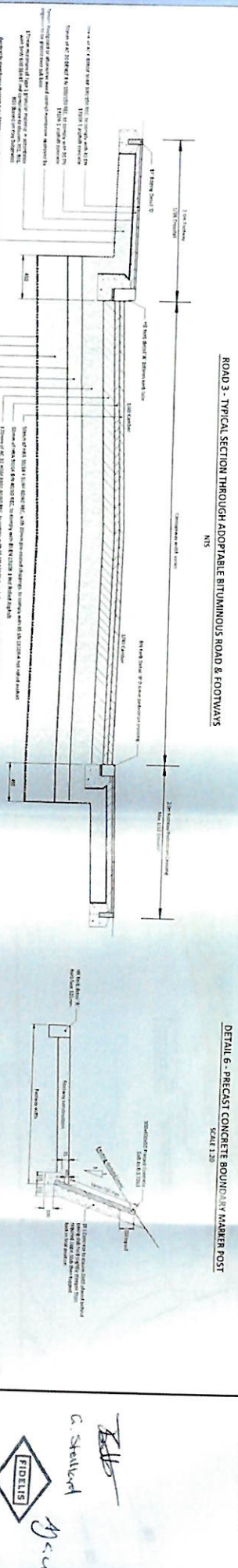
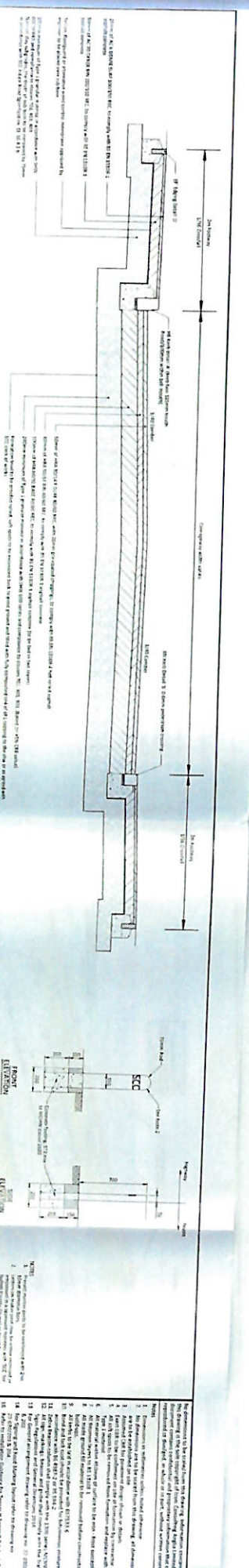

PRELIMINARY

14/04/2012

15/04/2012

16/04/2012

17/04/2012

18/04/2012

19/04/2012

20/04/2012

21/04/2012

22/04/2012

23/04/2012

24/04/2012

25/04/2012

26/04/2012

27/04/2012

28/04/2012

29/04/2012

30/04/2012

01/05/2012

02/05/2012

03/05/2012

04/05/2012

05/05/2012

06/05/2012

07/05/2012

08/05/2012

09/05/2012

10/05/2012

11/05/2012

12/05/2012

13/05/2012

14/05/2012

15/05/2012

16/05/2012

17/05/2012

18/05/2012

19/05/2012

20/05/2012

21/05/2012

22/05/2012

23/05/2012

24/05/2012

25/05/2012

26/05/2012

27/05/2012

28/05/2012

29/05/2012

30/05/2012

31/05/2012

01/06/2012

02/06/2012

03/06/2012

04/06/2012

05/06/2012

06/06/2012

07/06/2012

08/06/2012

09/06/2012

10/06/2012

11/06/2012

12/06/2012

13/06/2012

14/06/2012

15/06/2012

16/06/2012

17/06/2012

18/06/2012

19/06/2012

20/06/2012

21/06/2012

22/06/2012

23/06/2012

24/06/2012

25/06/2012

26/06/2012

27/06/2012

28/06/2012

29/06/2012

30/06/2012

01/07/2012

02/07/2012

03/07/2012

04/07/2012

05/07/2012

06/07/2012

07/07/2012

08/07/2012

09/07/2012

10/07/2012

11/07/2012

12/07/2012

13/07/2012

14/07/2012

15/07/2012

16/07/2012

17/07/2012

18/07/2012

19/07/2012

20/07/2012

21/07/2012

22/07/2012

23/07/2012

24/07/2012

25/07/2012

26/07/2012

27/07/2012

28/07/2012

29/07/2012

30/07/2012

31/07/2012

01/08/2012

02/08/2012

03/08/2012

04/08/2012

05/08/2012

06/08/2012

07/08/2012

08/08/2012

09/08/2012

10/08/2012

11/08/2012

12/08/2012

13/08/2012

14/08/2012

15/08/2012

16/08/2012

17/08/2012

18/08/2012

19/08/2012

20/08/2012

21/08/2012

22/08/2012

23/08/2012

24/08/2012

25/08/2012

26/08/2012

27/08/2012

28/08/2012

29/08/2012

30/08/2012

31/08/2012

01/09/2012

02/09/2012

03/09/2012

04/09/2012

05/09/2012

06/09/2012

07/09/2012

08/09/2012

09/09/2012

10/09/2012

11/09/2012

12/09/2012

13/09/2012

14/09/2012

15/09/2012

16/09/2012

17/09/2012

18/09/2012

19/09/2012

20/09/2012

21/09/2012

22/09/2012

23/09/2012

24/09/2012

25/09/2012

26/09/2012

27/09/2012

28/09/2012

29/09/2012

30/09/2012

01/10/2012

02/10/2012

03/10/2012

04/10/2012

05/10/2012

06/10/2012

07/10/2012

08/10/2012

09/10/2012

10/10/2012

11/10/2012

12/10/2012

13/10/2012

14/10/2012

15/10/2012

16/10/2012

17/10/2012

18/10/2012

19/10/2012

20/10/2012

21/10/2012

22/10/2012

23/10/2012

24/10/2012

25/10/2012

26/10/2012

27/10/2012

28/10/2012

29/10/2012

30/10/2012

31/10/2012

01/11/2012

02/11/2012

03/11/2012

04/11/2012

05/11/2012

06/11/2012

07/11/2012

08/11/2012

09/11/2012

10/11/2012

11/11/2012

12/11/2012

13/11/2012

14/11/2012

15/11/2012

16/11/2012

17/11/2012

18/11/2012

19/11/2012

20/11/2012

21/11/2012

22/11/2012

23/11/2012

24/11/2012

25/11/2012

26/11/2012

27/11/2012

28/11/2012

29/11/2012

30/11/2012

01/12/2012

02/12/2012

03/12/2012

04/12/2012

05/12/2012

06/12/2012

07/12/2012

08/12/2012

09/12/2012

10/12/2012

11/12/2012

12/12/2012

13/12/2012

14/12/2012

15/12/2012

16/12/2012

17/12/2012

18/12/2012

19/12/2012

20/12/2012

21/12/2012

22/12/2012

23/12/2012

24/12/2012

25/12/2012

26/12/2012

27/12/2012

28/12/2012

29/12/2012

30/12/2012

31/12/2012

ICENI CONSULTING

14 Colchester Road
 Colchester, Essex, CO1 1JG
 Tel: 0206 441111
 Fax: 0206 441112
 Email: info@iceni.co.uk

hillsbuilding group

14 Colchester Road
 Colchester, Essex, CO1 1JG
 Tel: 0206 441111
 Fax: 0206 441112
 Email: info@hillsbuildinggroup.co.uk

HEATH ROAD EAST BERGHOLT SUFFOLK

SECTION 278
 CONSTRUCTION DETAILS
 SHEET 2 OF 4

PRELIMINARY

22.02.2012

23.02.2012

24.02.2012

25.02.2012

26.02.2012

27.02.2012

28.02.2012

29.02.2012

01.03.2012

02.03.2012

03.03.2012

04.03.2012

05.03.2012

06.03.2012

07.03.2012

08.03.2012

09.03.2012

10.03.2012

11.03.2012

12.03.2012

13.03.2012

14.03.2012

15.03.2012

16.03.2012

17.03.2012

18.03.2012

19.03.2012

20.03.2012

21.03.2012

22.03.2012

23.03.2012

24.03.2012

25.03.2012

26.03.2012

27.03.2012

28.03.2012

29.03.2012

30.03.2012

31.03.2012

01.04.2012

02.04.2012

03.04.2012

04.04.2012

05.04.2012

06.04.2012

07.04.2012

08.04.2012

09.04.2012

10.04.2012

11.04.2012

12.04.2012

13.04.2012

14.04.2012

15.04.2012

16.04.2012

17.04.2012

18.04.2012

19.04.2012

20.04.2012

21.04.2012

22.04.2012

23.04.2012

24.04.2012

25.04.2012

26.04.2012

27.04.2012

28.04.2012

29.04.2012

30.04.2012

01.05.2012

02.05.2012

03.05.2012

04.05.2012

05.05.2012

06.05.2012

07.05.2012

08.05.2012

09.05.2012

10.05.2012

11.05.2012

12.05.2012

13.05.2012

14.05.2012

15.05.2012

16.05.2012

17.05.2012

18.05.2012

19.05.2012

20.05.2012

21.05.2012

22.05.2012

23.05.2012

24.05.2012

25.05.2012

26.05.2012

27.05.2012

28.05.2012

29.05.2012

30.05.2012

31.05.2012

FIDELIS

C. Stalkin

22.02.2012

23.02.2012

24.02.2012

25.02.2012

26.02.2012

27.02.2012

28.02.2012

29.02.2012

01.03.2012

02.03.2012

03.03.2012

04.03.2012

05.03.2012

06.03.2012

07.03.2012

08.03.2012

09.03.2012

10.03.2012

11.03.2012

12.03.2012

13.03.2012

14.03.2012

15.03.2012

16.03.2012

17.03.2012

18.03.2012

19.03.2012

20.03.2012

21.03.2012

22.03.2012

23.03.2012

24.03.2012

25.03.2012

26.03.2012

27.03.2012

28.03.2012

29.03.2012

30.03.2012

31.03.2012

01.04.2012

02.04.2012

03.04.2012

04.04.2012

05.04.2012

06.04.2012

07.04.2012

08.04.2012

09.04.2012

10.04.2012

11.04.2012

12.04.2012

13.04.2012

14.04.2012

15.04.2012

16.04.2012

17.04.2012

18.04.2012

19.04.2012

20.04.2012

21.04.2012

22.04.2012

23.04.2012

24.04.2012

25.04.2012

26.04.2012

27.04.2012

28.04.2012

29.04.2012

30.04.2012

01.05.2012

02.05.2012

03.05.2012

04.05.2012

05.05.2012

06.05.2012

07.05.2012

08.05.2012

09.05.2012

10.05.2012

11.05.2012

12.05.2012

13.05.2012

14.05.2012

15.05.2012

16.05.2012

17.05.2012

18.05.2012

19.05.2012

20.05.2012

21.05.2012

22.05.2012

23.05.2012

24.05.2012

25.05.2012

26.05.2012

27.05.2012

28.05.2012

29.05.2012

30.05.2012

31.05.2012

MODEL SPECIFICATION

GLASDON GATEWAY™ 1.5M WIDE - 1.8M TALL C/W CROSSBAR

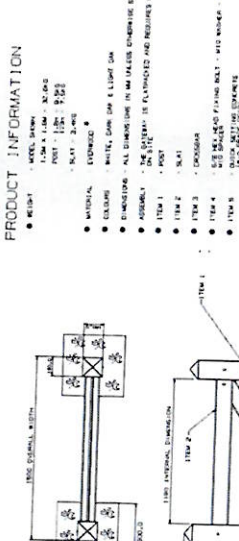

- ### PRODUCT INFORMATION
- MODEL RANGE: 1.5M x 1.8M - 32.000
 - POST: 1.2M x 3.000
 - POST: 1.2M x 3.000
 - EXTENSION: 0
 - COLORS: WHITE, GRAY, OR LIGHT GRAY
 - EMBEDDING: ALL DIMENSIONS IN MM UNLESS OTHERWISE STATED
 - ASSEMBLY: ON SITE - THE GATEWAY IS FLATPACKED AND REQUIRES FULL ASSEMBLY
 - ITEM 1: POST
 - ITEM 2: CROSSBAR
 - ITEM 3: CROSSBAR
 - ITEM 4: 1.5M x 1.8M x 1.8M PANEL - 480 WIDE - 1800 HIGHER NET
 - ITEM 5: 1.5M x 1.8M x 1.8M PANEL - 480 WIDE - 1800 HIGHER NET

- ### INSTALLATION OPTIONS
- STANDARD GATEWAY SYSTEM
 - 1.5M TALL MODEL - 2.000M WIDE - SEE DRAWING 103 ABOVE GATEWAY
 - 2.000M TALL MODEL - 2.000M WIDE - SEE DRAWING 104 ABOVE GATEWAY
 - 2.000M TALL MODEL - 2.000M WIDE - SEE DRAWING 105 ABOVE GATEWAY
 - 2.000M TALL MODEL - 2.000M WIDE - SEE DRAWING 106 ABOVE GATEWAY
 - 2.000M TALL MODEL - 2.000M WIDE - SEE DRAWING 107 ABOVE GATEWAY
 - 2.000M TALL MODEL - 2.000M WIDE - SEE DRAWING 108 ABOVE GATEWAY
 - 2.000M TALL MODEL - 2.000M WIDE - SEE DRAWING 109 ABOVE GATEWAY
 - 2.000M TALL MODEL - 2.000M WIDE - SEE DRAWING 110 ABOVE GATEWAY
 - 2.000M TALL MODEL - 2.000M WIDE - SEE DRAWING 111 ABOVE GATEWAY
 - 2.000M TALL MODEL - 2.000M WIDE - SEE DRAWING 112 ABOVE GATEWAY
 - 2.000M TALL MODEL - 2.000M WIDE - SEE DRAWING 113 ABOVE GATEWAY
 - 2.000M TALL MODEL - 2.000M WIDE - SEE DRAWING 114 ABOVE GATEWAY
 - 2.000M TALL MODEL - 2.000M WIDE - SEE DRAWING 115 ABOVE GATEWAY
 - 2.000M TALL MODEL - 2.000M WIDE - SEE DRAWING 116 ABOVE GATEWAY
 - 2.000M TALL MODEL - 2.000M WIDE - SEE DRAWING 117 ABOVE GATEWAY
 - 2.000M TALL MODEL - 2.000M WIDE - SEE DRAWING 118 ABOVE GATEWAY
 - 2.000M TALL MODEL - 2.000M WIDE - SEE DRAWING 119 ABOVE GATEWAY
 - 2.000M TALL MODEL - 2.000M WIDE - SEE DRAWING 120 ABOVE GATEWAY

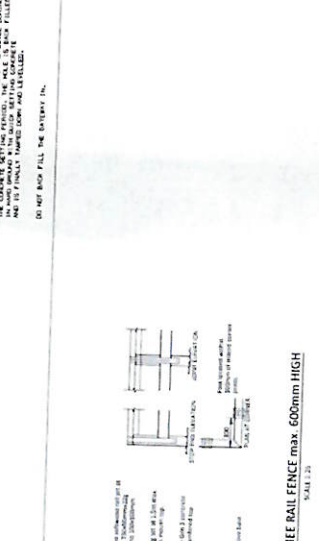

- ### DIAMOND KNEE RAIL FENCE max. 600mm HIGH
- S.A.B. 1.30
- 1. The fence is made of galvanized steel mesh with a diamond shape.
 - 2. The mesh is made of 3mm diameter wire.
 - 3. The mesh is made of 3mm diameter wire.
 - 4. The mesh is made of 3mm diameter wire.
 - 5. The mesh is made of 3mm diameter wire.
 - 6. The mesh is made of 3mm diameter wire.
 - 7. The mesh is made of 3mm diameter wire.
 - 8. The mesh is made of 3mm diameter wire.
 - 9. The mesh is made of 3mm diameter wire.
 - 10. The mesh is made of 3mm diameter wire.
 - 11. The mesh is made of 3mm diameter wire.
 - 12. The mesh is made of 3mm diameter wire.
 - 13. The mesh is made of 3mm diameter wire.
 - 14. The mesh is made of 3mm diameter wire.
 - 15. The mesh is made of 3mm diameter wire.
 - 16. The mesh is made of 3mm diameter wire.
 - 17. The mesh is made of 3mm diameter wire.
 - 18. The mesh is made of 3mm diameter wire.
 - 19. The mesh is made of 3mm diameter wire.
 - 20. The mesh is made of 3mm diameter wire.



DETAIL 7 - DRAGON'S TEETH DETAIL
S.A.B. 1.30

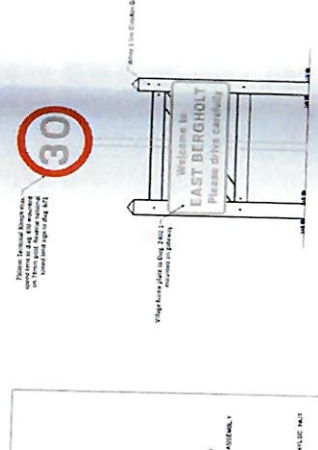

ILLUSTRATIVE VIEW OF GATEWAY FEATURE

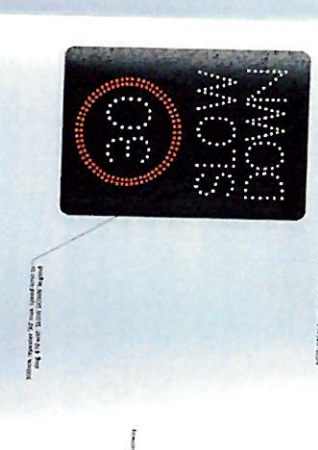

WESTCOTE VEHICLE ACTIVATED SIGN
SOLAR POWERED

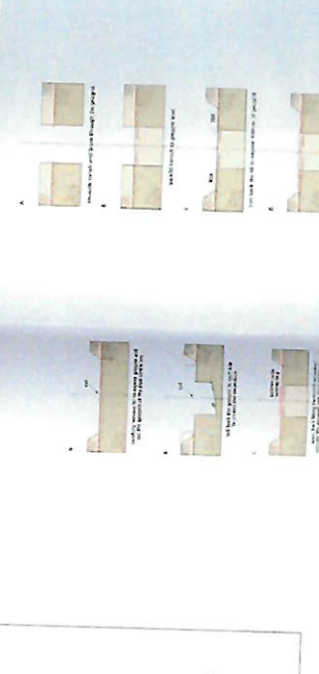

EXCAVATION & REINSTATEMENT OF TRENCHES THROUGH TENSAR T14s GEOGRID STABILISED LAYERS

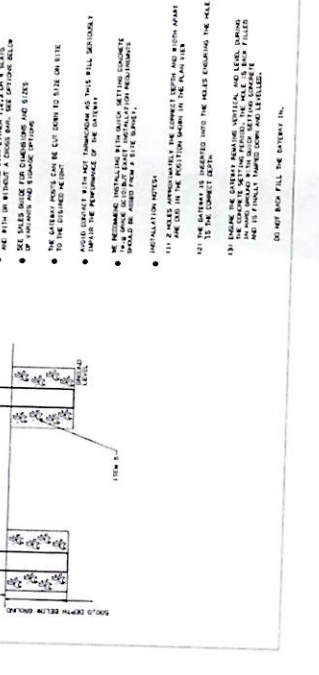

METHOD OF REINSTATEMENT 2
'DIG THROUGH' NIS



METHOD OF REINSTATEMENT 1
'PEEL BACK' NIS

ICENI CONSULTING
145 Southbourne Road
Southbourne
Bournemouth, Dorset
BH10 7JN
Tel: 01202 417977
E: info@iceniconsulting.co.uk

hills building group
145 Southbourne Road
Southbourne, Bournemouth
Tel: 01202 417977

SECTION 278
CONSTRUCTION DETAILS
SHEET 4 OF 4

DATE: 2022
BY: [Name]
CHECKED BY: [Name]

PRELIMINARY

All dimensions to be as shown from the drawing. All dimensions are in millimeters (mm). This drawing is the property of Hill Consulting Group Limited. This drawing is to be used for the construction of the works described herein only. It is not to be reproduced or used for any other purpose without the written consent of Hill Consulting Group Limited.

1. All dimensions are in millimeters (mm) unless otherwise stated.
2. All dimensions are to be as shown from the drawing.
3. All dimensions are to be as shown from the drawing.
4. All dimensions are to be as shown from the drawing.
5. All dimensions are to be as shown from the drawing.
6. All dimensions are to be as shown from the drawing.
7. All dimensions are to be as shown from the drawing.
8. All dimensions are to be as shown from the drawing.
9. All dimensions are to be as shown from the drawing.
10. All dimensions are to be as shown from the drawing.
11. All dimensions are to be as shown from the drawing.
12. All dimensions are to be as shown from the drawing.
13. All dimensions are to be as shown from the drawing.
14. All dimensions are to be as shown from the drawing.

Standard Classification Details

Sign: Advance Signage 54
 Size: 600mm (H) x 400mm (W)
 Material: Aluminium
 Finish: Powder Coat
 Mounting: 200mm x 200mm
 Advance Signage 54 (R)
 Size: 600mm (H) x 400mm (W)
 Material: Aluminium
 Finish: Powder Coat
 Mounting: 200mm x 200mm

Standard Classification Details

Sign: Advance Signage 51A
 Size: 600mm (H) x 400mm (W)
 Material: Aluminium
 Finish: Powder Coat
 Mounting: 200mm x 200mm
 Advance Signage 51A (R)
 Size: 600mm (H) x 400mm (W)
 Material: Aluminium
 Finish: Powder Coat
 Mounting: 200mm x 200mm

Standard Classification Details

Sign: Advance Signage 51A
 Size: 600mm (H) x 400mm (W)
 Material: Aluminium
 Finish: Powder Coat
 Mounting: 200mm x 200mm
 Advance Signage 51A (R)
 Size: 600mm (H) x 400mm (W)
 Material: Aluminium
 Finish: Powder Coat
 Mounting: 200mm x 200mm

Standard Classification Details

Sign: Advance Signage 51A
 Size: 600mm (H) x 400mm (W)
 Material: Aluminium
 Finish: Powder Coat
 Mounting: 200mm x 200mm
 Advance Signage 51A (R)
 Size: 600mm (H) x 400mm (W)
 Material: Aluminium
 Finish: Powder Coat
 Mounting: 200mm x 200mm

Standard Classification Details

Sign: Advance Signage 51A
 Size: 600mm (H) x 400mm (W)
 Material: Aluminium
 Finish: Powder Coat
 Mounting: 200mm x 200mm
 Advance Signage 51A (R)
 Size: 600mm (H) x 400mm (W)
 Material: Aluminium
 Finish: Powder Coat
 Mounting: 200mm x 200mm

Standard Classification Details

Sign: Advance Signage 51A
 Size: 600mm (H) x 400mm (W)
 Material: Aluminium
 Finish: Powder Coat
 Mounting: 200mm x 200mm
 Advance Signage 51A (R)
 Size: 600mm (H) x 400mm (W)
 Material: Aluminium
 Finish: Powder Coat
 Mounting: 200mm x 200mm

